

Truuli



Point Central, Sydenham Road, Croydon, Surrey, CR0

£325,000 Leasehold

- Open-plan living
- Bike storage
- 24-hour concierge
- Underfloor heating throughout
- Top-of-the-range, built-integrated appliances
- Winter garden
- 5% deposit developer incentive
- Access to communal terraces and residents lounge
- Close proximity to East & West Croydon train stations and local amenities

Southbridge Place, Surrey, CR0 4HA

Tel: 0330 043 0002

Email: save@truuli.co.uk Web: www.truuli.co.uk

Point Central, Sydenham Road, Croydon, Surrey, CR0

£325,000 Leasehold

5% developers incentive available on some plots

Located within close proximity to West Croydon & East Croydon this apartment has an abundance of space whilst offering impressive views.

Sydenham Road

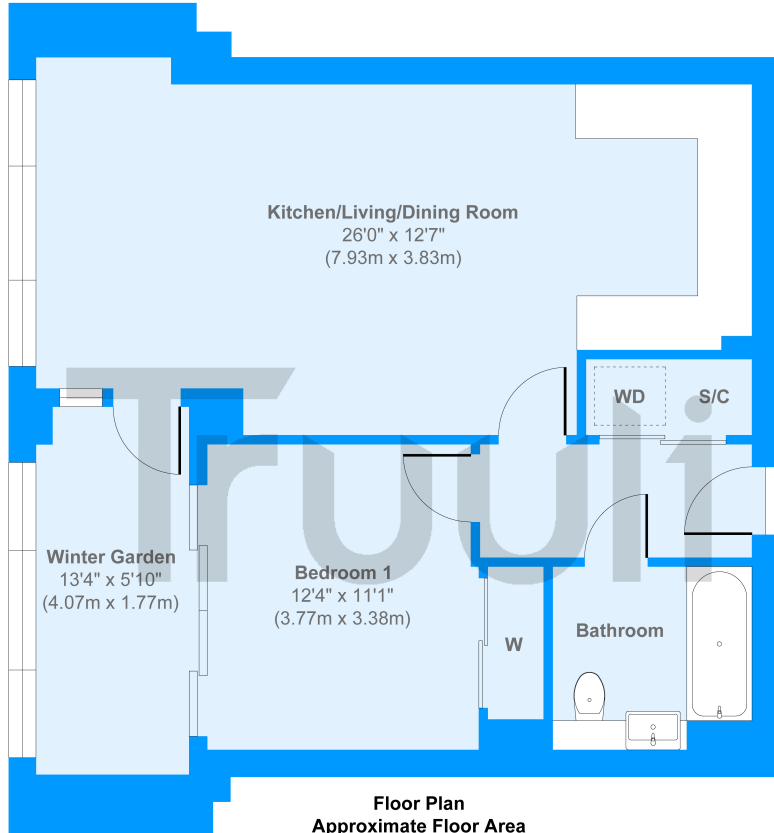

Floor Plan
Approximate Floor Area
551 sq. ft
(51.23 sq. m)

Approx. Gross Internal Floor Area 551 sq. ft / 51.23 sq. m

Produced by Elements Property

