

# Truuli



## Point Central, Sydenham Road, Croydon, Surrey, CR0

£360,000 Leasehold

- - Incentives/contributions from the developer
- Open-plan living
- Bike storage
- 24-hour concierge
- Underfloor heating throughout
- - Accesses to communal terraces and resident's lounge
- - Close proximity to West and East Croydon Stations
- Top-of-the-range, built-integrated appliances
- Winter garden

# Point Central, Sydenham Road, Croydon, Surrey, CR0

£360,000 Leasehold

Located within close proximity to West Croydon & East Croydon this apartment has an abundance of spacious apartments with impressive views.

Sydenham Road

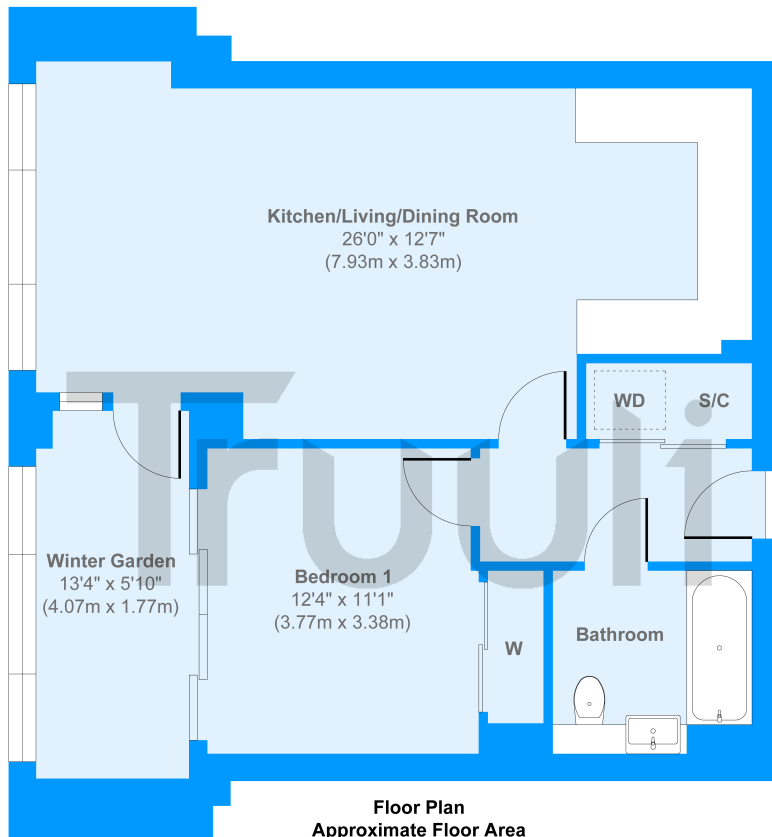

**Floor Plan**  
**Approximate Floor Area**  
**551 sq. ft**  
**(51.23 sq. m)**

**Approx. Gross Internal Floor Area 551 sq. ft / 51.23 sq. m**

Produced by Elements Property

