



GREGORY BROWN
RESIDENTIAL SALES & LETTINGS

£465,000 Freehold
FOR SALE



2 Wyatt Road, Staines-upon-Thames, Surrey, TW18 2AY

WELL PRESENTED, EXTENDED TWO BEDROOM END-TERRACED PROPERTY IDEALLY SITUATED ALONG SOUGHT AFTER ROAD WITHIN MOMENTS OF STAINES MAINLINE TRAIN STATION. The property benefits from a spacious lounge, dining room, modern fitted kitchen, two double bedrooms, modern white bathroom suite, secluded rear garden and off-street parking. Viewings Highly Recommended!

Gregory Brown

127a, High Street, Staines-upon-Thames, TW18 4PD

01784 451458

staines@gregory-brown.co.uk

ROOM DESCRIPTIONS

FLOORPLAN

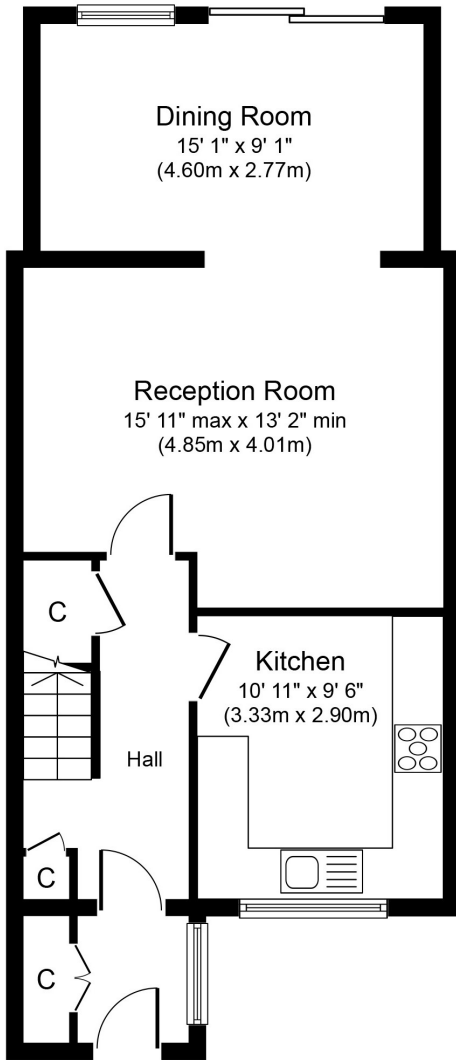

Ground Floor
Approximate Floor Area
581 sq. ft.
(54.0 sq. m.)

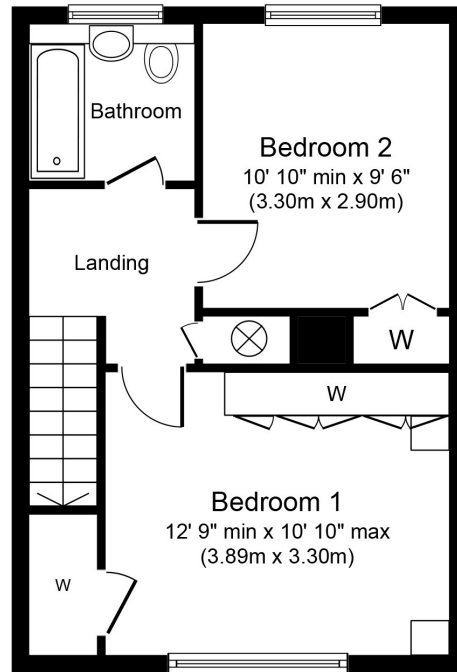

First Floor
Approximate Floor Area
398 sq. ft.
(37.0 sq. m.)