



## Flat 4 Stephen Gould House, Southampton Street,

Guide Price £190,000 Leasehold

JIGSAW ESTATES HAMPSHIRE are delighted to offer to the market this first floor conversion apartment set in the conservation area of South Farnborough. Ideally located within walking distance to the local shops, cafes and restaurants and also North Camp station. Just a short distance away you also have; Farnborough airport, the mainline station which runs regular services to London, Farnborough town centre and also the M3 and A331 are very accessible.

The apartment has many period features including; bay windows, high ceilings and fireplaces. Inside is a living/dining room, a fully fitted kitchen, two generous double bedrooms, a bathroom, and a spacious entrance hall. Further benefits include; gas central heating, off-street parking and communal gardens.

### LEASE INFORMATION:

- Lease remaining: Approximately 973 years as at Sept 2024





- VICTORIAN CONVERSION
- TWO DOUBLE BEDROOMS
- OFF STREET PARKING
- COMMUNAL GARDENS
- CONSERVATION AREA OF SOUTH FARNBOROUGH
- LIVING/DINING ROOM
- PERIOD FEATURES
- OVER 970 YEAR LEASE REMAINING

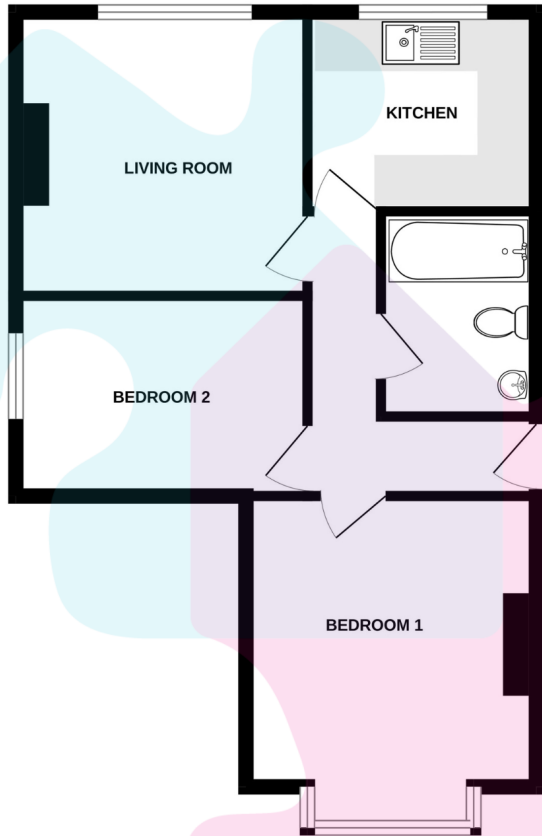

Energy Efficiency Rating		Current	Potential
Very energy efficient - lower running costs			
(92+)	<b>A</b>		
(81-91)	<b>B</b>		
(69-80)	<b>C</b>	69	80
(55-68)	<b>D</b>		
(39-54)	<b>E</b>		
(21-38)	<b>F</b>		
(1-20)	<b>G</b>		
Not energy efficient - higher running costs			
<b>England, Scotland &amp; Wales</b>		EU Directive 2002/91/EC	

Whilst every attempt has been made to ensure the accuracy of the floorplan contained here, measurements of doors, windows, rooms and any other items are approximate and no responsibility is taken for any error, omission or mis-statement. This plan is for illustrative purposes only and should be used as such by any prospective purchaser. The services, systems and appliances shown have not been tested and no guarantee as to their operability or efficiency can be given.  
Made with Metropix ©2024