

£180,000  
Freehold







## Features

- TWO BEDROOMS
- A MUST SEE
- IN NEED OF MODERNISATION
- CALLING ALL FIRST TIME BUYERS / INVESTMENT BUYERS
- NO CHAIN
- PARKING FOR 2-3 CARS

## Summary of Property

OPEN HOUSE - 8TH OF MARCH 9.30AM - 10.30AM CALL TO BOOK YOUR APPOINTMENT.

PLEASE NOTE THIS PROPERTY REQUIRES MODERNISATION AND UPDATING THROUGHOUT.

Mason's Residential are please to offer for sale this spacious two bedroom home benefitting from double glazing and central heating. Fullers Slade is situated on the north-west flank of Milton Keynes providing access to local shops in the attractive nearby historic town of Stony Stratford with all of its amenities, whilst being a short drive from the bustling town of Milton Keynes with good connections to London and Birmingham via Milton Keynes Central train station.

The accommodation comprises of; entrance hall, kitchen, inner hallway, lounge/diner, bathroom and cloakroom.

The first floor benefits from two double bedrooms.

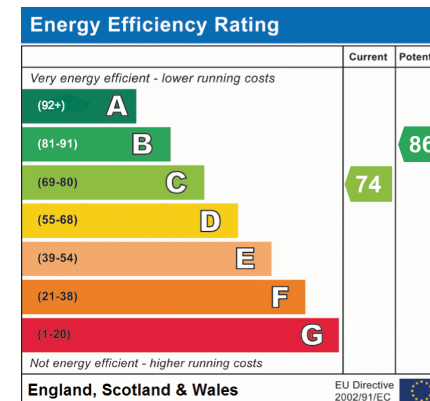

## Room Descriptions

### ENTRANCE HALL

#### CLOAKROOM

#### BATHROOM

#### KITCHEN

11' 9" x 11' 9" (3.58m x 3.58m)

#### SITTING ROOM

13' 4" x 11' 9" (4.06m x 3.58m)

### FIRST FLOOR

#### BEDROOM ONE

11' 9" x 11' 4" (3.58m x 3.45m)

#### BEDROOM TWO

11' 9" x 10' 4" (3.58m x 3.15m)

### FRONT AND REAR GARDENS

#### PLEASE NOTE

These property particulars do not constitute part or all of an offer or contract. All measurements are stated for guidance purposes only and may be incorrect. Details of any contents mentioned are supplied for guidance only and must also be considered as potentially incorrect. Mason's Residential advise perspective buyers to check all measurements prior to committing to any expense. Mason's Residential confirm we have not checked any appliances, equipment, apparatus, fixtures or fittings at the property and any prospective buyer should conduct their own checks before exchange of contracts. Mason's Residential has not sought to verify the legal title of the property and any prospective buyers must obtain verification and confirmation from their solicitor.



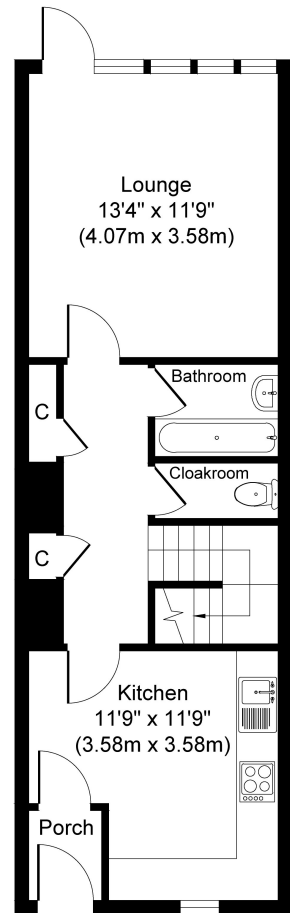

**Ground Floor**  
**Approximate Floor Area**  
**436 sq. ft**  
**(40.50 sq. m)**

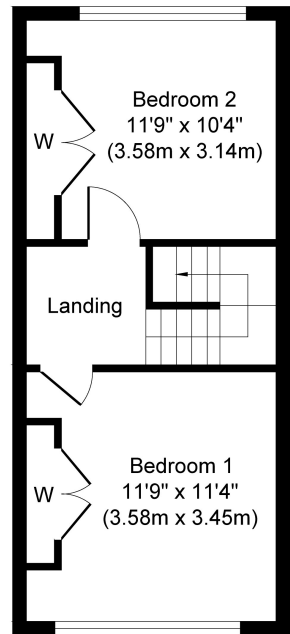

**First Floor**  
**Approximate Floor Area**  
**323 sq. ft**  
**(30.00 sq. m)**

Whilst every attempt has been made to ensure the accuracy of the floor plan contained here, measurements of doors, windows, rooms and any other items are approximate and no responsibility is taken for any error, omission, or mis-statement. The measurements should not be relied upon for valuation, transaction and/or funding purposes. This plan is for illustrative purposes only and should be used as such by any prospective purchaser or tenant. The services, systems and appliances shown have not been tested and no guarantee as to their operability or efficiency can be given.

Copyright V360 Ltd 2025 | [www.houseviz.com](http://www.houseviz.com)