



Southborough Road,

Bickley, Kent. BR1 2EP

Tenure: Share of Freehold

2 Bedrooms | 1 Reception Room | 1 Bathroom

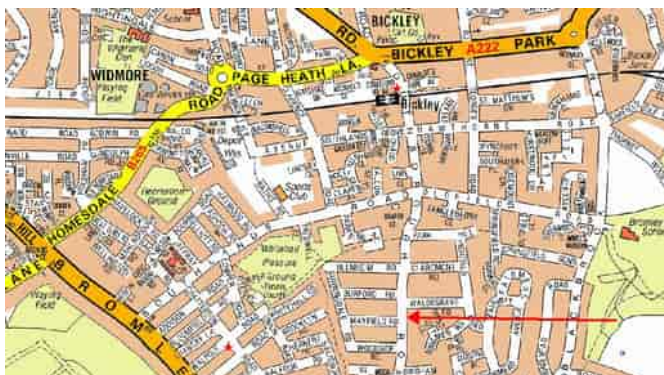

In our opinion, this is a larger than average first floor period two bedroomed share of freehold apartment which is offered to the market in fantastic condition and boasts plenty of period features. Located in the heart of Bickley, with its bright and airy, well-proportioned rooms, totalling over 850 sq. ft of accommodation and a generous shared garden, we feel this property will be ideal for someone looking to downsize or first-time buyers alike. We highly recommend your earliest possible viewing. EXCLUSIVE TO GEORGE PROCTOR & PARTNERS. EPC Rating: TBC

Enquiries To:

T: 020 8467 2252

E: beosales@georgeproctor.com



The Bickley Estate Office

Southborough Road, Bickley, Kent, BR1 2EB

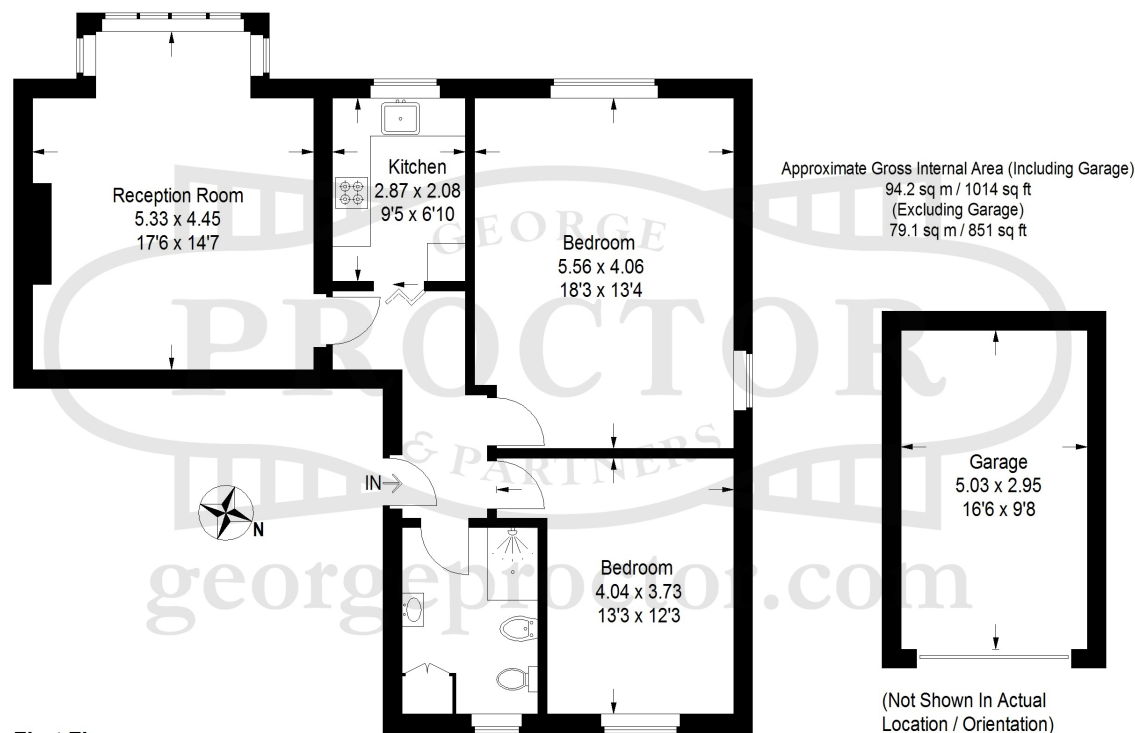

First Floor

These particulars whilst believed to be accurate are made without responsibility on the part of the vendor or agents, their accuracy is not guaranteed nor do they form part of any contract and no warranty is given. Services or appliances have not been tested and no guarantee can be given as to their operation, buyers should seek professional advice where necessary. All measurements are approximate and may be rounded to the nearest three inches (10 cm). Floor plans, where shown, are indicative only. Any photographs included may be taken with the use of a wide angle lens. If there is a matter of particular interest please contact us for further information, especially before travelling any distance to view. Map reproduced by permission of Geographers A-Z Map Co Ltd. Licence No. A0514. This map is based upon Ordnance Survey maps with the permission of the controller of Her Majesty's Stationary Office.