



Mica Close, Rugby, CV21 3UX



GUILD HOUSE
Estate Agents

Mica Close | | CV21 3UX

Guide Price £90,000



Guild House estate agents are pleased to offer for sale this two bedroom coach house situated in a quiet residential area on the edge of Hillmorton. The property is offered for sale on a 50% shared ownership basis with the remaining share also available to purchase. Ideally located close to some good local amenities as well as being within easy walking distance of Rugby Town Centre and the train station which operates a fifty minute service to London Euston.

This fantastic starter home is well maintained offered and in brief accommodation comprises: entrance hallway, cloakroom/w.c, and bedroom two/study. To the first floor the lounge/diner leads into a well fitted kitchen. There's a spacious master bedroom with modern ensuite. The property further benefits from Upvc double glazing and gas fired central heating throughout.

Externally the property benefits from off road parking to the front.

An ideal first time purchase opportunity and early internal inspection is highly recommended.



- PERFECT STARTER HOME
- SEMI DETACHED COACH HOUSE
- 50% SHARED OWNERSHIP
- LOUNGE/DINER
- MASTER BEDROOM WITH ENSUITE
- BEDROOM TWO/STUDY
- UPVC DOUBLE GLAZING
- GAS CENTRAL HEATING
- OFF ROAD PARKING
- LEASEHOLD
- 100% SHARE AVAILABLE
- EPC RATING C



GROUND FLOOR

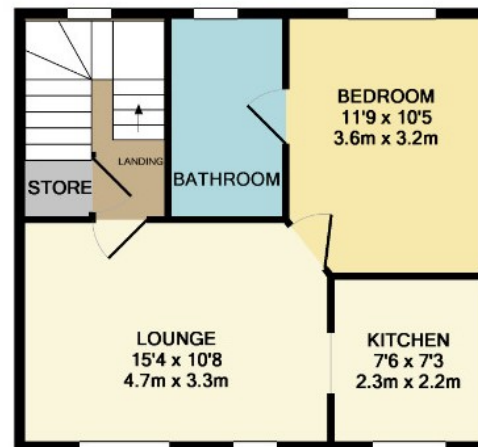

1ST FLOOR

01788 577 218
info@guild-house.com
guildhouseestateagents.co.uk

Agents note: All measurements are approximate and whilst every attempt has been made to ensure accuracy they are for general guidance only and must not be relied on. The fixture and fittings referred to have not been tested and therefore no guarantee can be given that they are in working order. Internal photographs are reproduced for general information and it must not be inferred that any item shown is included with the property.



GUILD HOUSE
 Estate Agents