

# Park Road South, Newton-le-Willows, WA12 £324,999

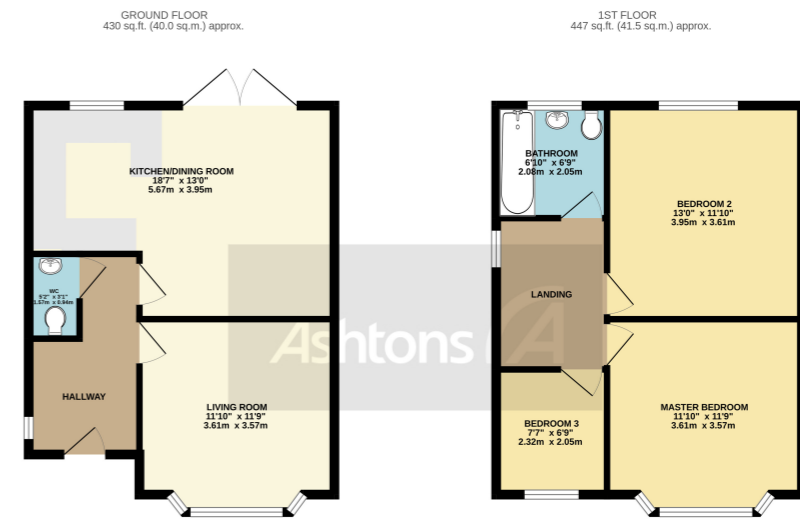

TOTAL FLOOR AREA: 877 sq.ft. (81.5 sq.m.) approx.  
Whilst every attempt has been made to ensure the accuracy of the floorplan contained here, measurements of plots, windows, doors and any other items are approximate and no responsibility is taken for any error, omission or mis-statement. This plan is for illustrative purposes only and should be used as such by any prospective purchaser. The services, systems and appliances shown here are not tested and no guarantee as to their operability or efficiency can be given.  
Made with Metreplan C3023



Enviably located along the highly coveted Park Road South in Newton-Le-Willows in a setting where houses seldom come available & totalling an astonishing 900 square feet (approx) of high quality living space that simply must be viewed to be fully appreciated - this stunning family home has been completely overhauled and is now ready for clients to simply move in and start unpacking.

 x 3  x 1

See more of this house at [ashtons.net](https://www.ashtons.net)

