

FOR SALE

Bradmore Park Road,
Hammersmith, W6

Terraced House
Brackenbury Village

£1,150,000 fh

3  1  1 



**horton
andgarton**

SALES / LETTINGS / PROPERTY MANAGEMENT

hortonandgarton.co.uk | Sales 020 8819 0510 | Lettings 020 8819 0511
172 King Street, Hammersmith, W6 0QU



FOR SALE

Bradmore Park Road,
Hammersmith, W6

Terraced House
Brackenbury Village

£1,150,000 fh

3  1  1 



**horton
andgarton**

SALES / LETTINGS / PROPERTY MANAGEMENT

hortonandgarton.co.uk | Sales 020 8819 0510 | Lettings 020 8819 0511
172 King Street, Hammersmith, W6 0QU



FOR SALE

Bradmore Park Road,
Hammersmith, W6

Terraced House
Brackenbury Village

£1,150,000 fh

3  1  1 



**horton
andgarton**

SALES / LETTINGS / PROPERTY MANAGEMENT

hortonandgarton.co.uk | Sales 020 8819 0510 | Lettings 020 8819 0511
172 King Street, Hammersmith, W6 0QU



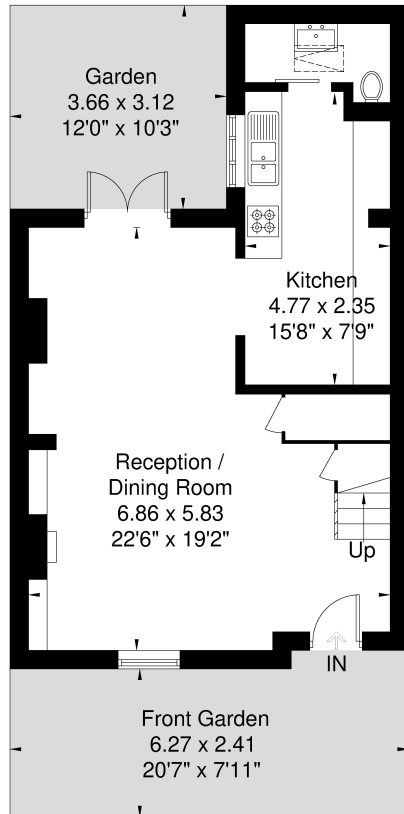

Ground Floor
47.2 sq m / 508 sq ft

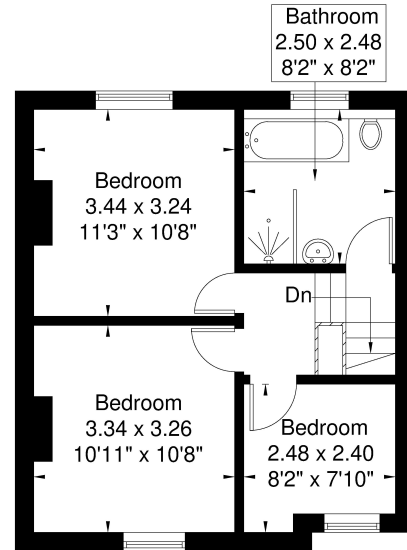

First Floor
39.6 sq m / 426 sq ft

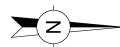

BRADMORE PARK ROAD
Approximate Gross Internal Area = 86.8 sq m / 934 sq ft



Although every attempt has been made to ensure accuracy, all measurements are approximate. The floorplan is for illustrative purposes only and not to scale.
© www.perspective.co.uk



Victorian house | Three bedrooms - One bathroom | 86.8 Sq' – 934 SqM | Utility room/Guest wc | EPC rating D | Brackbury Village



hortonandgarton.co.uk
Sales 020 8819 0510
Lettings 020 8819 0511

172 King Street, Hammersmith, W6 0QU