



Day & Co
ESTATE AGENTS

28 Cavendish Street
Keighley
BD21 3RG



5 Hartington Street, Keighley,
West Yorkshire, BD21 3AS

Offers Over £135,000

T: 01535 664609

W: www.dayandcoestateagents.co.uk

E: keighley@dayandcoestateagents.co.uk

- CORNER STONE TERRACE
 - ACCOMMODATION OVER FOUR FLOORS
 - GARDENS TO TWO SIDES
- FOUR BEDROOMS
 - GAS CENTRAL HEATING & DOUBLE GLAZING
 - EPC RATING E

SUMMARY

** SPACIOUS, FOUR BEDROOM CORNER STONE TERRACE, ACCOMMODATION OVER FOUR FLOORS, GAS CENTRAL HEATING, DOUBLE GLAZING, GARDENS TO TWO SIDES, NO CHAIN, EPC RATING E **

FULL DESCRIPTION

Day & Co are pleased to bring to the market this spacious four bedroom corner terrace, situated in a popular residential location with excellent access to Keighley town centre. The four storey accommodation comprises of an entrance porch, sitting room with stairs to the lower nd first floors, Spacious Lounge with bay window and side entrance door. Lower Floor - Spacious Kitchen Diner with window to the side, cellar room. First floor - Landing - Two bedrooms, bathroom. Upper Floor - Landing two bedrooms. Gas central heating and Double glazing. Outside gardens to two sides. No Chain. EPC Rating E

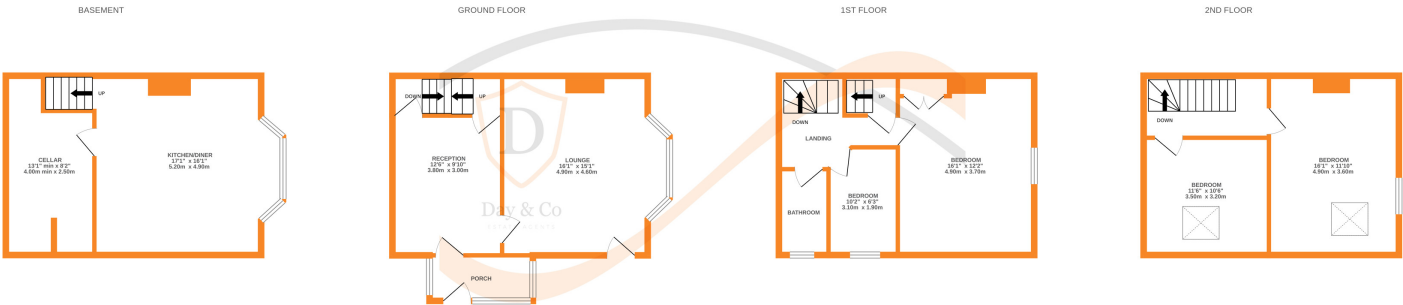

Whilst every attempt has been made to ensure the accuracy of the floorplan contained here, measurements of doors, windows, rooms and any other items are approximate and no responsibility is taken for any error, omission or mis-statement. This plan is for illustrative purposes only and should be used as such by any prospective purchaser. The services, systems and appliances shown have not been tested and no guarantee as to their operability or efficiency can be given.
Made with Metropix ©2023