



This modern two double bedroom terraced house is situated on a popular residential cul-de-sac within Datchet and is offered to the market in excellent decorative order. The ground floor features a 14ft living room and a 13ft fitted kitchen/diner. On the first floor there are two well-sized bedrooms, with the master bedroom benefiting from fitted wardrobes, in addition to a contemporary three piece family bathroom. Externally the rear garden measures to approximately 40ft is well enclosed with rear access whilst to the front of the property there is allocated parking for one car in addition to visitor spaces. This property provides easy access to the M4/M25 motorways and Heathrow Airport and is an ideal first time purchase.



Property Information



TWO DOUBLE BEDROOM TERRACED HOUSE



CUL-DE-SAC LOCATION



13FT FITTED KITCHEN/DINER



40FT REAR GARDEN



GREAT FIRST TIME PURCHASE



MODERN AND WELL PRESENTED



14FT LIVING ROOM



CONTEMPORARY BATHROOM



PARKING FOR 1 CAR



x2

Bedrooms



x1

Reception Rooms



x1

Bathrooms



x1

Parking Spaces



Y

Garden



Y

Garage

ADDITIONAL INFORMATION

External

The rear garden measures to approximately 40ft is well enclosed with rear access; to the front of the property there is allocated parking for one car in addition to visitor spaces.

Council Tax

Band C

Transport Links

Nearest stations:

- Datchet (0.6 mi)
- Sunnymeads (0.9 mi)
- Windsor & Eton Riverside (1.8 mi)

The M4 (J5) which is about a mile away, provides access to Heathrow, London, the West Country and the M25.

Location

Penn Road is a cul-de-sac situated in the picturesque Thameside village of Datchet. A range of shopping facilities for day-to-day needs are available in Datchet, whilst further amenities may be found in Windsor and Slough. Educational facilities in the area both state and private are excellent. Sporting facilities in the area include golf at Datchet, The Royal Berkshire, horse riding in Windsor Great Park, horse racing at Windsor and Ascot, boating on some stretches of the River Thames.

Schools

- Primary Schools:
- Datchet St Mary's CofE Primary School

0.6 miles away State school

- Castleview Primary School
- 1.1 miles away State school
- Holy Family Catholic Primary School
- 1.2 miles away State school

- Foxborough Primary School
- 1.4 miles away State school

- Secondary Schools:
- Churchmead Church of England (VA) School
- 0.7 miles away State school

- Langley Grammar School
- 1.3 miles away Grammar school

- The Langley Academy
- 1.5 miles away State school

- Long Close School
- 1.6 miles away Independent school

- Upton Court Grammar School
- 1.6 miles away Grammar school

Council Tax

Band C

Floor Plan

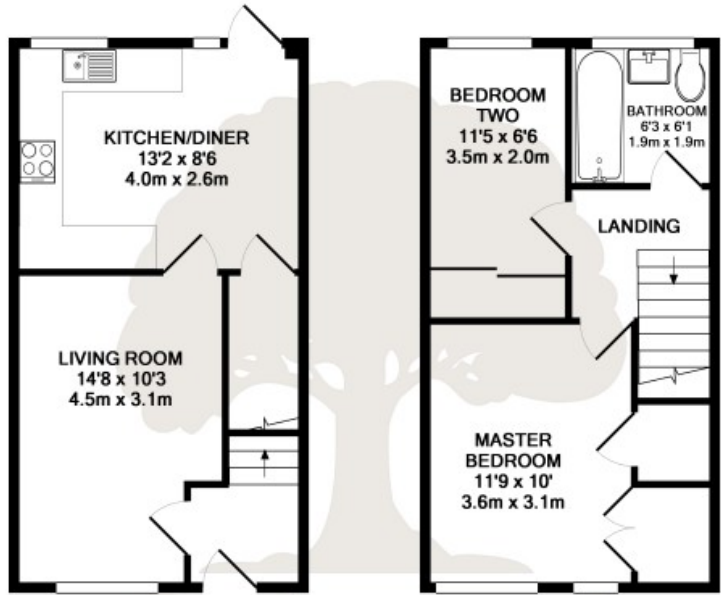



GROUND FLOOR
APPROX. FLOOR
AREA 330 SQ.FT.
(30.7 SQ.M.)

1ST FLOOR
APPROX. FLOOR
AREA 331 SQ.FT.
(30.7 SQ.M.)

TOTAL APPROX. FLOOR AREA 661 SQ.FT. (61.4 SQ.M.)

Whilst every attempt has been made to ensure the accuracy of the floor plan contained here, measurements of doors, windows, rooms and any other items are approximate and no responsibility is taken for any error, omission, or mis-statement. This plan is for illustrative purposes only and should be used as such by any prospective purchaser. The services, systems and appliances shown have not been tested and no guarantee as to their operability or efficiency can be given
Made with Metropix ©2018

Prospective purchasers should be aware that these sales particulars are intended as a general guide only and room sizes should not be relied upon for carpets or furnishing. We have not carried out any form of survey nor have we tested any appliance or services, mechanical or electrical. All maps are supplied by Goview.co.uk from Ordnance Survey mapping. Care has been taken in the preparation of these sales particulars, which are thought to be materially correct, although their accuracy is not guaranteed and they do not form part of any contract.

