



Estate Agents and Solicitors

Flat G, 3 Kestrel Way, Dunfermline, Fife, KY11 8JR

Immaculately Presented, Two Bedroom, Second (Top) Floor Flat

Up to date price and viewing info at [mov8realestate.com/property](https://www.mov8realestate.com/property)

espc rightmove  Zoopla
find your happy

Property Description

Immaculately presented, two-bedroom, second-floor (top) flat, with residential parking. Forming part of a modern residential development, located in Dunfermline, Fife.

Comprises an entrance hallway, living room, kitchen, two double bedrooms, and a bathroom.

With light tasteful decor, ready-to-move-in, highlights include a modern fitted kitchen and bathroom, contemporary flooring, and a front-facing bay window.

In addition, there is double glazing, gas central heating, and good integrated storage provision including bedroom wardrobes and a loft space.

This maintained development includes ample residential parking, a secured entry system, and landscaped grounds.

A generous hall space gives access throughout the property and features three built-in stores, the secured entry system, and ample space for outerwear. Set to the front, is a carpeted public room featuring a bay window, plain coving and a central light fitting.

Rear-facing is a stylish kitchen which can accommodate a breakfast bar/table, and features modern flooring running continuously from the hall. Modern fitted units and worktops include a tiled surround, an integrated double oven, and a gas hob.

A well-proportioned bedroom is set to either aspect, with carpeted flooring and built-in wardrobes. Completing the accommodation, set internally is the bathroom, fitted with a modern three-piece suite, including a mains shower mixer over the bath, tiled splash walls and a shaver/power point.

mov⁸ REAL ESTATE Flat G, 3 Kestrel Way, Dunfermline KY11 8JR
Estate Agents and Solicitors

Approximate Gross Internal Area: (705 sq ft - 65 sq m.)

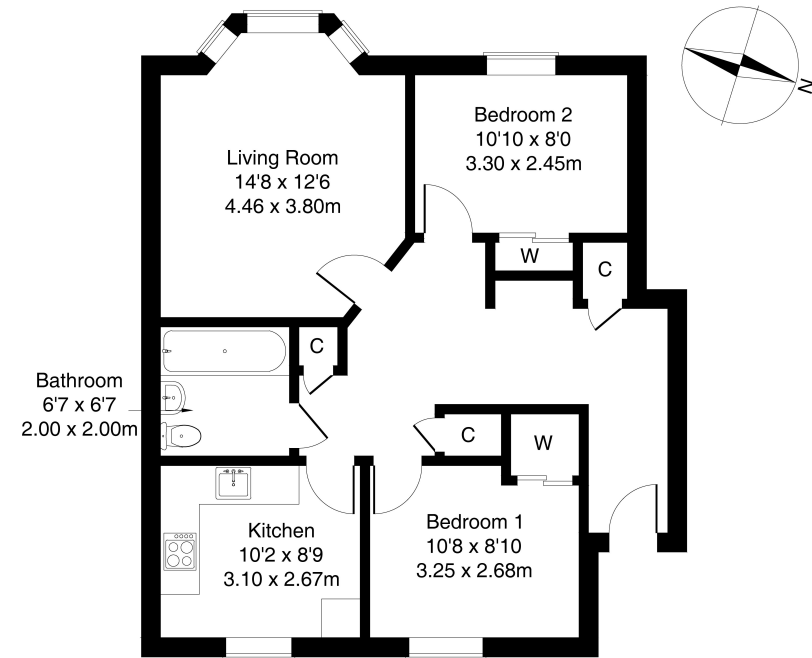

Legal Disclaimer : Floor-plan and measurements are for illustrative guidance only, and not intended to form part of any contract.

Area Description

Dunfermline is a historic town and is the largest in Fife, popular with commuters and within easy access of the M90 motorway with direct links to Edinburgh, Perth and Dundee. The town has a wide range of shops, including the covered Kingsgate Shopping Centre, Halbeath Retail Park, and a selection of supermarkets including an ASDA. The thriving community supports a

range of amenities and leisure facilities, including Fife Leisure Park, Fife College, and well-regarded schools. Outdoor spaces include Pittencreiff Park, Townhill Park and King George V Park. Dunfermline Railway Station provides regular commuting services to Edinburgh, and there is a frequent bus service, with a convenient Park and Ride at Halbeath.





Our Services

- Free pre-sale property valuations
- Great value fixed estate agency fees
- Extensive buyer matching database
- Purchase and sale conveyancing

Contact Us

0345 646 0208

sales@mov8realestate.com

www.mov8.com

Head Office

6 Redheughs Rigg, Edinburgh, EH12 9DQ

Glasgow Office

77 Renfrew Street, Glasgow, G2 3BZ



Estate Agents and Solicitors

