





- Detached Bungalow
- Semi-Rural Location
- Lounge
- Kitchen Dining Room & Utility Room
- Two Double Bedrooms
- Luxury Bathroom
- Large Gardens
- Garage & Parking

### Description

A detached, true bungalow, which is located in a superb semi-rural location with open countryside views to the rear. The property is offered in good decorative order throughout and features a modern fitted kitchen and luxury bathroom with a four piece suite. With gas central heating and PVCu double glazing, the accommodation comprises: Entrance hall, lounge, kitchen dining room, utility room, two double bedrooms and bathroom. Outside there are large front and rear gardens along with a detached garage and ample off road parking. Immediately available restrictions apply.



**Location**  
**Tenure**

**EPC Rating:**

**Important Notes**  
Type Here



### Ground Floor

Approx. 73.4 sq. metres (790.3 sq. feet)

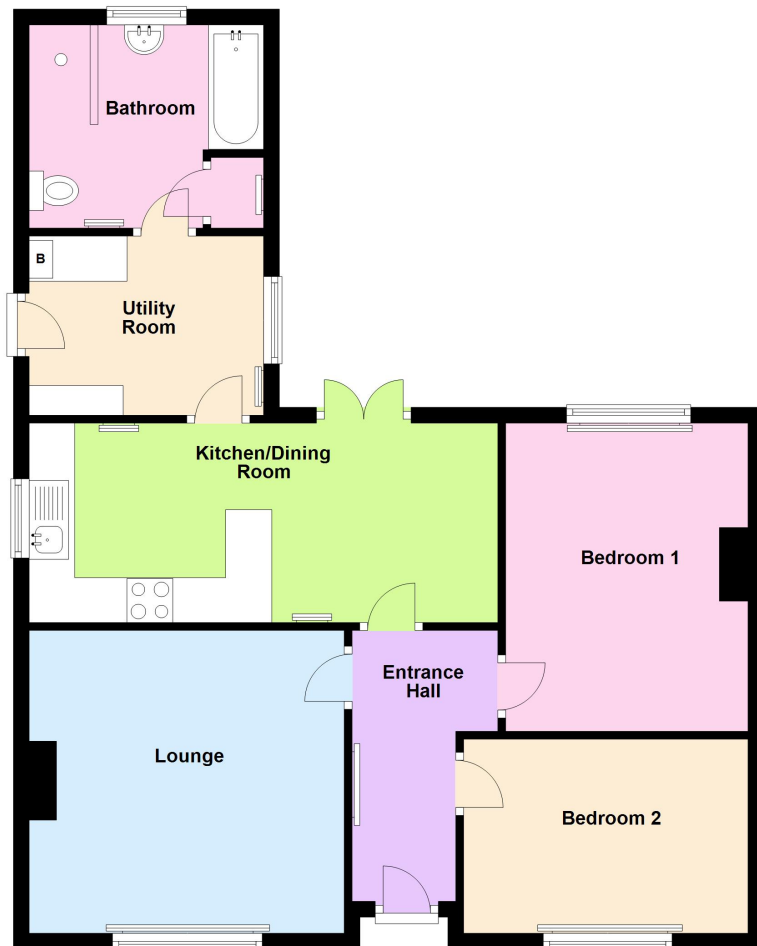

Total area: approx. 73.4 sq. metres (790.3 sq. feet)

