



michaels
property consultants

8 The View, Museum Street, Colchester, Essex. CO1 1BE.

The View, Museum Street – A Stone's Throw from Colchester's Castle Landmark - One Bedroom Second Floor Apartment - £150,000 - Location: Situated in a prime city-centre position, this apartment is just moments from the picturesque Colchester Castle and the beautiful Castle Park. Located in the heart of Colchester, the property benefits from an excellent selection of independent shops, restaurants, cafés, bars, and retail stores nearby. Renowned high-street brands and the popular Fenwick Colchester department store are also within easy walking distance, providing everything you need on your doorstep.

- Prime city-centre location in Colchester
- Just moments from Colchester Castle and Castle Park
- One-bedroom apartment on the second floor
- Secure telephone entry system
- Bright open-plan kitchen, dining, and living area
- Fitted kitchen with integrated appliances and sash windows
- Spacious bedroom with two windows and calming décor
- Ideal for first-time buyers, professionals, or investors
- Residents Permit Parking Scheme

Call to view 01206 576999



michaels
property consultants

Property Details.

Second Floor Apartment

Entrance Hall

Bathroom



9' 10" x 9' 1" (3.00m x 2.77m)

Bedroom



16' 9" x 13' 3" (5.11m x 4.04m)

Property Details.

Open Plan Living/Kitchen/Dining Room



18' 4" x 16' 9" (5.59m x 5.11m)

Property Details.

Floorplans

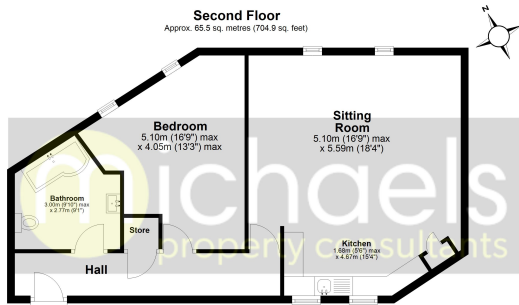

Total area: approx. 65.5 sq. metres (704.9 sq. feet)

All measurements have been taken as a guide to prospective buyers only and are not precise. This plan is for illustrative purposes only and no responsibility for any error, omission or misstatement. The services, systems and appliances shown have not been tested and no guarantee as to their operability or efficiency can be given. Measurements may have been taken from the widest area and may include wardrobe/cupboard space. No guarantee is given to any measurements including total areas. Buyers are advised to take their own measurements.

© @modestphotoblog | www.modestphoto.co.uk
Plan produced using Planit.

The View, Colchester

Location



Energy Ratings

We have not carried out a structural survey and the services, appliances and specific fittings have not been tested. All photographs, measurements, floor plans and distances referred to are given as a guide only and should not be relied upon for the purchase of carpets or any other fixtures or fittings. Gardens, roof terraces, balconies and communal gardens as well as tenure and lease details cannot have their accuracy guaranteed for intending purchasers. Lease details, service ground rent (where applicable) are given as a guide only and should be checked and confirmed by your solicitor prior to exchange of contracts.