



17 Yeo Close, Bettws, Newport. NP20 7RS
£120,000
Tenure Leasehold

- **SPACIOUS FIRST FLOOR FLAT**
- **3 GOOD SIZE BEDROOMS**
- **LIVING / DINING ROOM**
- **KITCHEN WITH BALCONY**
- **PERFECT FOR FIRST TIME BUYERS OR INVESTORS**
- **CONVENIENT LOCATION**
- **LOTS OF STORAGE**
- **GARDEN AREA**
- **NO CHAIN**
- **GAS COMBI & UPVC DOUBLE GLAZING**

69 Bridge Street, Newport, NP20 4AQ
M2 Estate Agents Newport 01633 289622
www.m2ea.co.uk

NO CHAIN! PERFECT FOR FIRST TIME BUYERS!! SPACIOUS 3 BEDROOM FIRST FLOOR FLAT WITH PLENTY OF STORAGE, LIVING/DINING ROOM, KITCHEN, BATHROOM & GARDEN AREA

A deceptively spacious three bedroom, first floor flat situated in a popular and convenient location close to all local amenities, bus routes, walking distance to popular Primary & Secondary Schools and with easy access to junctions 25a & 26 of the M4 making it ideal for commuting to both Bristol & Cardiff.

Perfect for First Time Buyers or Investors the property offers ideal accommodation comprising: To the ground floor: An entrance hall with stairs to the first floor and storage cupboard. First Floor: A spacious living/dining room with further storage area, the kitchen benefits from an extensive range of storage units with door to small balcony, the internal hallway provides access to 3 good size bedrooms and bathroom.

The property further benefits from having a new gas combi boiler, upvc double glazing throughout and is offered for sale with no onward chain.

Lease details - approximately 90 years left.

Services:

Council Tax Band:

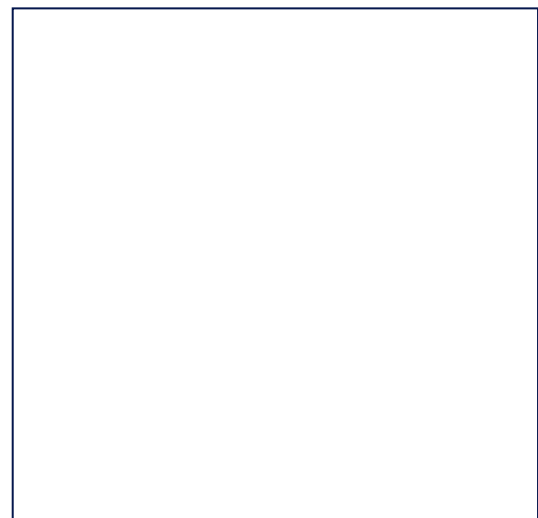
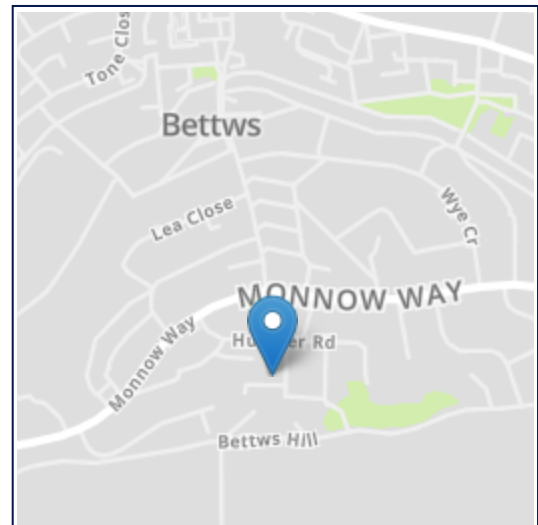
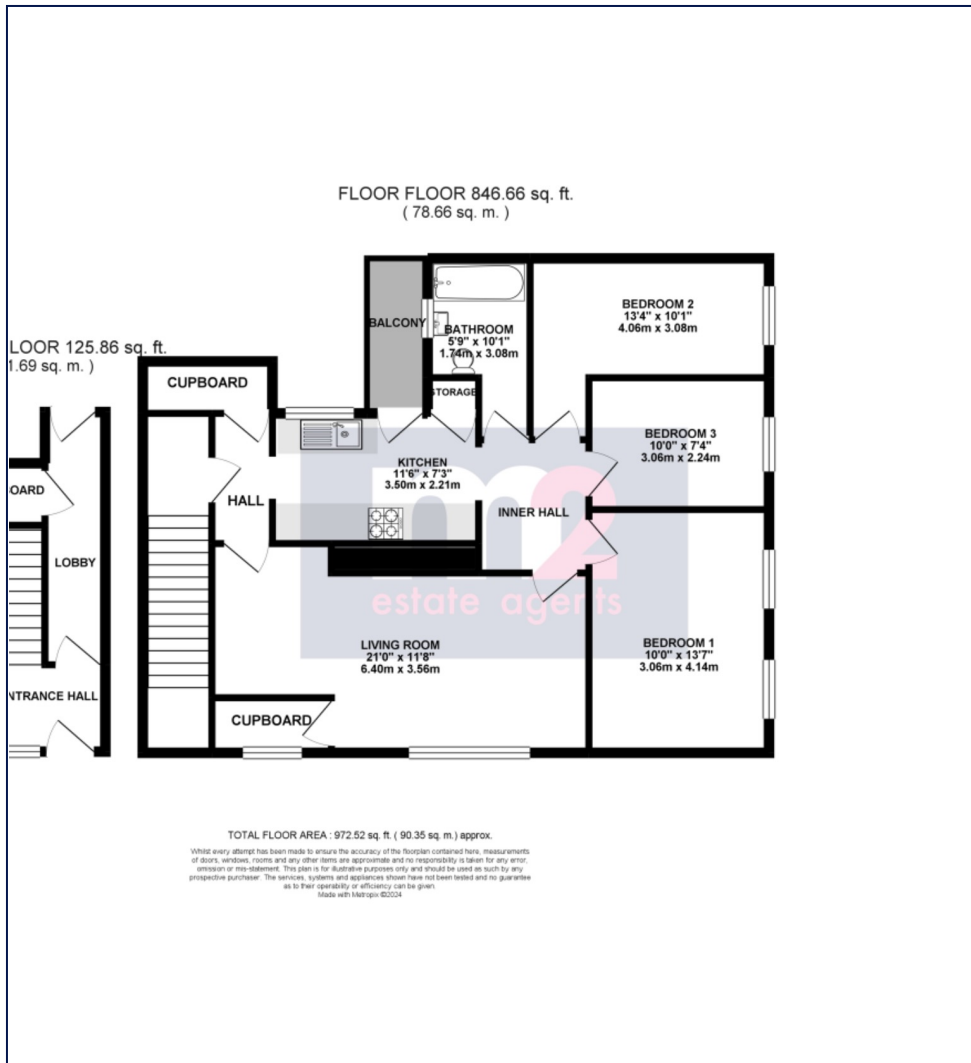

All room sizes are approximate. Electrical installations, plumbing, central heating and drainage installations are noted on the basis of a visual inspection only. They have not been tested and no warranty of condition or fitness for purpose is implied in their inclusion. Potential purchasers are warned that they must make their own enquiries as to the condition of the appliances, installations or any element of the structure or fabric of the property.

M2 Estate Agents for themselves and for the Vendors and Lessors of this property whose agents they are give notice that, (i) the particulars are set out as a general outline only for the guidance of the intended Purchasers or Lessors, and do not constitute part of an offer or contract (ii) all descriptions, dimensions, reference to condition and necessary permissions for the use and occupation and other details are given without responsibility and any intending Purchasers or Tenants should not rely on them as statements or representations of fact but satisfy themselves by inspection or otherwise as to the correctness of each of them (iii) no person in the employment of M2 Estate Agents has any authority to make or give any representation or warranty whatever in relation to this property.