



The Gallery

£550,000

## Apartment 15 The Gallery, London, 38 Ludgate Hill EC4M 7DE

A well presented fifth floor apartment offering generous accommodation with stunning views towards The Glass Shard and London Eye located within an elegant period building enjoying close proximity to City Thameslink Station, St Paul's Cathedral, Chancery Lane and the river.

This beautifully presented apartment comprises entrance hall, impressive south facing reception room with dining area and fine views towards The Glass Shard and London Eye, separate fitted kitchen with work tops, integrated Baumatic and AEG appliances and fitted cabinets, spacious double bedroom with fitted wardrobes and bathroom. This apartment is accessed via a lift via a grand communal hallway and impressive communal stairs. The Gallery is perfectly placed for convenient access to both City Thameslink and Blackfriars mainline/underground stations with the City, the river, St Paul

- The Gallery EC4M
- One Double Bedroom
- Impressive Reception Room
- Fifth Floor With Lift Access
- Excellent Location
- 574 Sq Ft
- Separate Fitted Kitchen
- Views Towards The Glass Shard & London Eye
- Well Presented

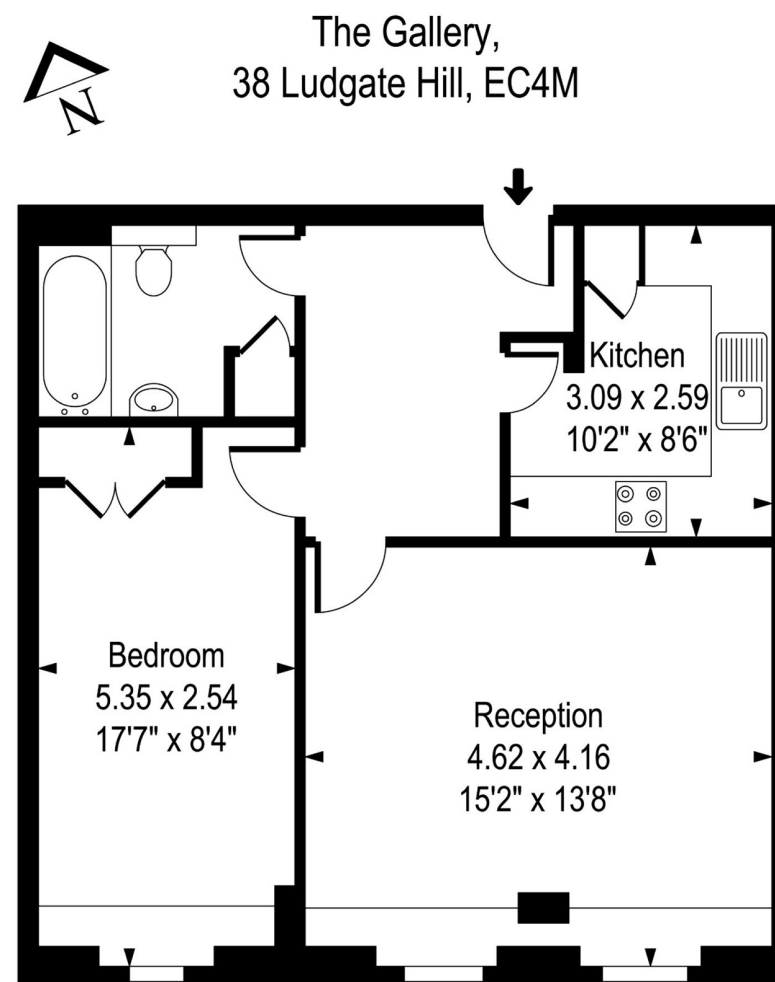

Fifth Floor

Approx Gross Internal Area **574 Sq Ft - 53.36 Sq M**

Whilst every attempt has been made to ensure the accuracy of the floor plan contained here, measurements of the doors, windows, rooms and any other items are approximate and no responsibility is taken for any error, omission, or mis-statement. This plan is for illustrative purposes only and should be used as such by any prospective purchaser. The services, systems and appliances shown have not been tested and no guarantee as to their operability or efficiency can be given.



