



NEWSON & BUCK
ESTATE AGENTS



12 Chapel Lane, West Winch, King's Lynn, Norfolk PE33 0LH £399,995

A very well presented five bedroom detached bungalow that has been tastefully extended by the current owners. The accommodation comprises hall, lounge, dining area, kitchen, family bathroom and five bedrooms with the master benefitting from an en-suite. The property further benefits from gas central heating, double glazing, garage and off road parking for numerous vehicles. Amenities can be found within the Village with more extensive facilities found in King's Lynn including a main line rail link into Cambridge and London King's Cross.



01553 775151



Entrance Hall

Double glazed door to front and radiator

Lounge

12' 11" x 16' 9" (3.94m x 5.11m) Double glazed window to side, space for wood burner and wooden flooring.

Dining Area

7' 2" x 11' 3" (2.18m x 3.43m) Double glazed windows to front and side, radiator and wooden flooring.

Kitchen

13' 2" x 10' 10" (4.01m x 3.30m) Double glazed windows to front and side, fitted kitchen with matching wall and base units, integrated oven and hob with extractor about, space for washing machine and fridge freezer, butler style sink, designer radiator, gas central heating boiler and tiled flooring.

Hall

Double glazed door to rear, radiator, access to loft, storage cupboard and tiled flooring.

Bathroom

9' 2" x 7' 5" (2.79m x 2.26m) Double glazed windows to side, slipper style bath with shower attachment, vanity unit with freestanding sink unit, open shower enclosure with mixer shower, towel radiator and tiled walls and flooring.

Master Bedroom

12' 11" x 11' 7" (3.94m x 3.53m) Double glazed doors and windows to rear, designer radiator and fitted. carpet.

En-Suite

3' 11" x 9' 11" (1.19m x 3.02m) Double glazed window to side, shower enclosure with mixer shower, low flush w/c, vanity unit with wash hand basin, towel radiator, tiled walls and flooring.

Bedroom Two

11' 11" x 13' 5" (3.63m x 4.09m) Double glazed window to side, radiator and wooden flooring.

Bedroom Three

10' 5" x 10' 5" (3.17m x 3.17m) Double glazed window to side, radiator and wooden flooring.

Bedroom Four

9' 0" x 11' 4" (2.74m x 3.45m) Double glazed window to side, radiator and wooden flooring.

Bedroom Five

7' 10" x 11' 4" (2.39m x 3.45m) Double glazed window to rear, radiator and fitted carpet.

Garage

5.02m x 2.78m (16' 6" x 9' 1") Brick built garage with up and over door

Garden



GROUND FLOOR

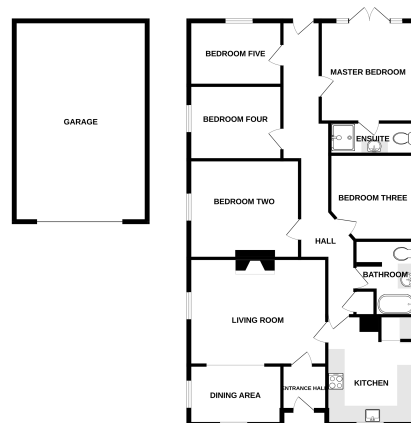

While every effort has been made to ensure the accuracy of the floorplan, the seller does not accept any liability for any errors or omissions. The floorplan is for information only and should not be used as a basis for any decision. The seller is not responsible for any loss or damage caused by any use of the floorplan. © 2023 Millsopps Limited