



Day & Co
ESTATE AGENTS

28 Cavendish Street
Keighley
BD21 3RG



14 Waterside Mill, Denholme
Road, Oxenhope, Keighley, West
Yorkshire, BD22 9NP

£349,995

T: 01535 664609

W: www.dayandcoestateagents.co.uk

E: keighley@dayandcoestateagents.co.uk

- Superbly Presented Town House In Mill Conversion
- Generous Garden To Reservoir Edge With Raised Decking
- Sought After Location Of Leeming In Oxenhope Village

- Three Double Bedrooms & Master En-Suite
- Stunning Panoramic Reservoir Views
- EPC Rating C

SUMMARY

****A SUPERBLY PRESENTED 3 DOUBLE BEDROOM TOWN HOUSE, MILL CONVERSION WITH STUNNING PANORAMIC RESERVOIR VIEWS - SOUGHT AFTER LOCATION OF LEEMING IN OXENHOPE VILLAGE!**** Having an en-suite shower room to the master bedroom, mezzanine home office, generous size garden stretching to the reservoir edge, parking, integral garage - VIEWING ESSENTIAL TO FULLY APPRECIATE!! EPC RATING C.

FULL DESCRIPTION

Viewing is essential to fully appreciate this superbly presented three bedroom town house, in this character mill conversion on the banks of Leeming reservoir in the sought after village of Oxenhope with stunning panoramic views. The three storey family accommodation comprises of a porch leading into an entrance hall which gives access to an integral garage, and separate utility room which has plumbing for an automatic washing machine. The dining kitchen has an attractive range of modern base and wall mounted units, integrated appliances to include double oven, microwave oven and dishwasher, Oak flooring. There is a double glazed window and door leading to the rear garden. To the first floor the spacious lounge has a mezzanine home office, and double glazed door opening to a balcony enjoying stunning panoramic views of the reservoir. There is a double bedroom on this level with two double glazed windows to the rear. Steps lead down to a separate WC. To the second floor there are two further double bedrooms, the master having two double glazed windows once again benefitting from the fantastic views, and also having an en-suite shower room with modern fitted suite comprising of walk-in shower cubicle, WC, wash hand basin, under floor heating. The house bathroom is also on this level having a four piece suite comprising of a bath, bidet, WC, wash hand basin. Externally the property has off-road parking, integral garage, there is a raised decking area with storage underneath, and generous lawn garden stretching to the banks of the reservoir. EPC Rating C.

Non

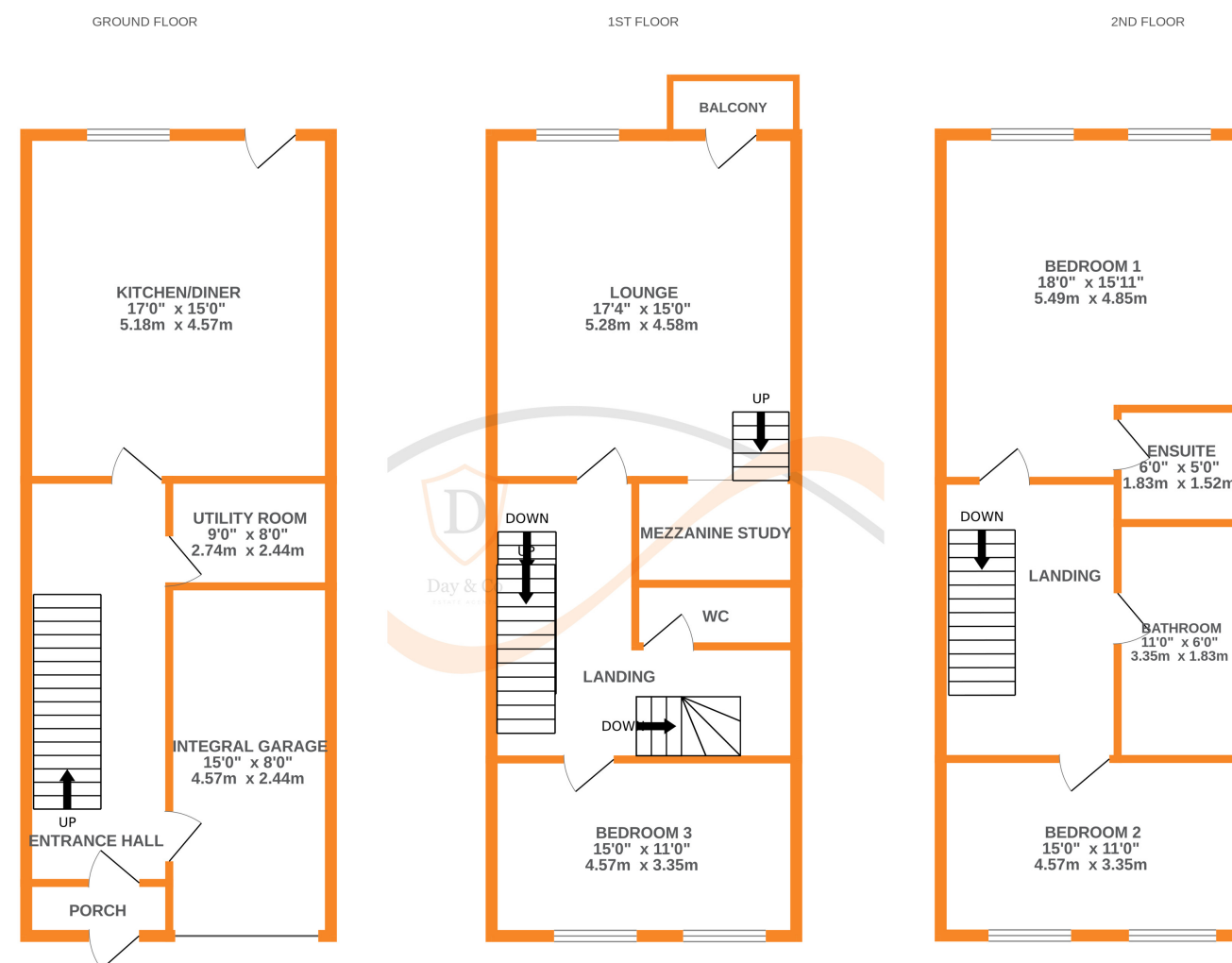

Whilst every attempt has been made to ensure the accuracy of the floorplan contained here, measurements of doors, windows, rooms and any other items are approximate and no responsibility is taken for any error, omission or mis-statement. This plan is for illustrative purposes only and should be used as such by any prospective purchaser. The services, systems and appliances shown have not been tested and no guarantee as to their operability or efficiency can be given.
Made with Metropix ©2024