



HILTON KING & LOCKE
SPECIALISTS IN PROPERTY



Flat 1, Heatherden House, 120 Pinewood Green, Iver, Buckinghamshire. SL0 0QQ.

£225,000 Leasehold

Hilton King and Locke are pleased to present this spacious one bedroom ground floor flat set in the lovely area of Iver Heath. This property is set on a secluded road with On Street Parking.

Th accommodation consists of opening into a bright Living/ Dining area (17'7x13'11) and bedroom (9'8x6'8) moving into a fitted kitchen with plenty of storage, this property benefits from a new fully fitted shower room.

The property has the added benefit of beautiful communal gardens.

Located within one of Iver Heath's premier roads and close to all local amenities and schools.

Black Park and Langley Park offer beautiful woodland walks, ideal for young families and dog owners.

THE AREA

Pinewood Green is situated within sought

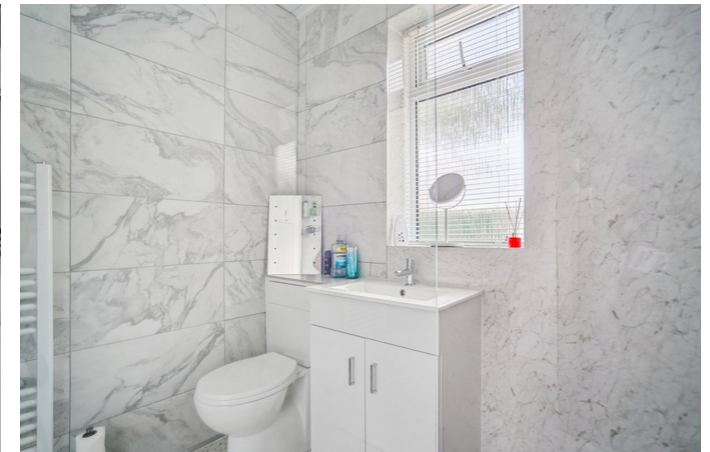

after Iver Heath, the home of Pinewood Studios and a range of schools, recreational facilities and local shopping amenities.

As a Pinewood resident, there is a free weekly bus service to surrounding stations by Pinewood Film Studios. The larger centres of Uxbridge and Gerrards Cross provide a wider range of shopping facilities. Central London is easily accessible by road via the M40 (J1A) and M25 (J16) plus access to Heathrow and Gatwick Airports.

Buckinghamshire is renowned for its education system, with an excellent choice of state and independent schools.

Uxbridge Tube Station is around 2 miles away, with Iver Station (and therefore the Elizabeth Line/Crossrail) under 3 miles away.



Important Notice

Particulars: These particulars are not an offer or contract, nor part of one. You should not rely on statements by Hilton King & Locke Ltd in the particulars or by word of mouth or in writing as being factually accurate about the property, its condition or its value. Hilton King & Locke Ltd does not have any authority to make any representations about the property, and accordingly any information given is entirely without responsibility on the part of the agents, seller(s) or lessor(s).

Photographs etc: The photographs show only certain parts of the property as they appeared at the time they were taken. Areas, measurements and distances given are approximate only.



23 High Street
Iver Buckinghamshire SL0 9ND

Tel: 01753 650033
iver@hklhome.co.uk

Flat 1, Heatherden House

Approximate Gross Internal Area = 35.3 sq m / 380 sq ft

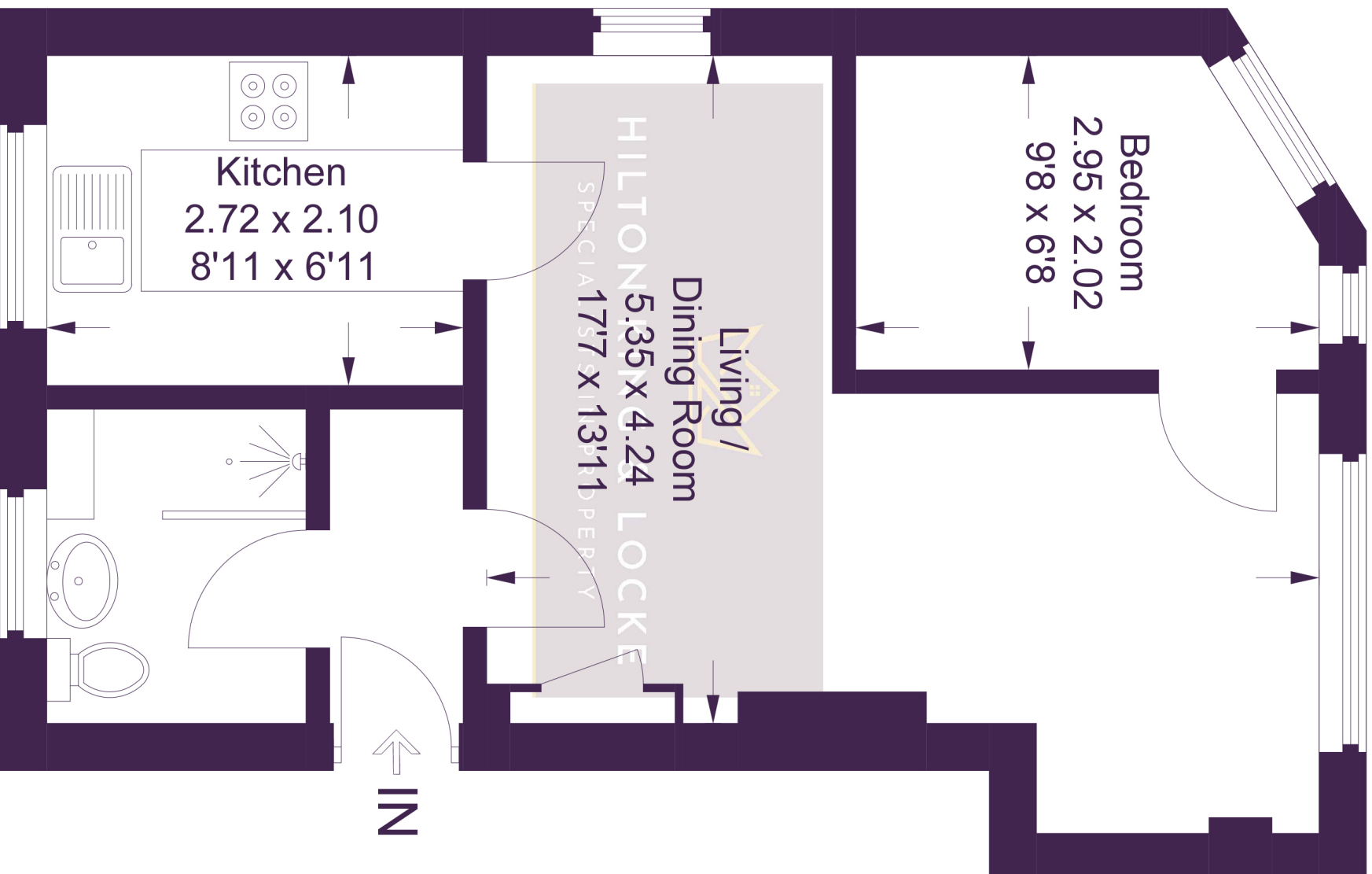

Ground Floor

This plan is for layout guidance only. Not drawn to scale unless stated. Windows and door openings are approximate. Whilst every care is taken in the preparation of this plan, please check all dimensions, shapes and compass bearings before making any decisions reliant upon them.

© C/J Property Marketing Ltd Produced for Hilton King & Locke