



28 WELMORE ROAD, GLINTON  
PE6 7LU OFFERS OVER £240,000

briggs  
FREEHOLDresidential.co.uk



Briggs Residential  
17 Market Place  
Market Deeping  
PE6 8EA

01778  
349300



**O**ffered for sale with no chain and situated in one of the area's most sought after villages with excellent amenities, this detached bungalow has a private westerly facing garden and a driveway which leads to a single garage. With a 21' lounge dining room, viewing is highly advised.

Entrance door opening to

**HALLWAY**

With radiator.

**LOUNGE DINING ROOM** 21'3 x 13' (6.48m x 3.96m)

This light and airy spacious room has two windows to the front aspect, further window to side aspect, radiator, TV point and dining area.

**KITCHEN** 9'4 x 6'8 (2.84m x 2.03m)

Comprising ample wall and base units, built in oven with electric hob, fridge space, plumbing for washing machine, work surface, tiling, window to rear aspect and side external door.

**BEDROOM ONE** 14'5 x 7'9 (4.39m x 2.36m)

With radiator and window to front aspect.

**BEDROOM TWO** 10'10 x 8'2 (3.30m x 2.49m)

With radiator and window to rear aspect.

**BATHROOM**

Comprising shower cubicle, low flush WC, wash hand basin, cupboard housing central heating boiler and window to rear aspect.

**OUTSIDE**

The driveway leads to a single garage. The front garden is set behind a mature hedge and is mainly laid to lawn; the private westerly facing rear garden is mainly laid to a shaped lawn with patio area, paving and shrubs.

EPC RATING: C

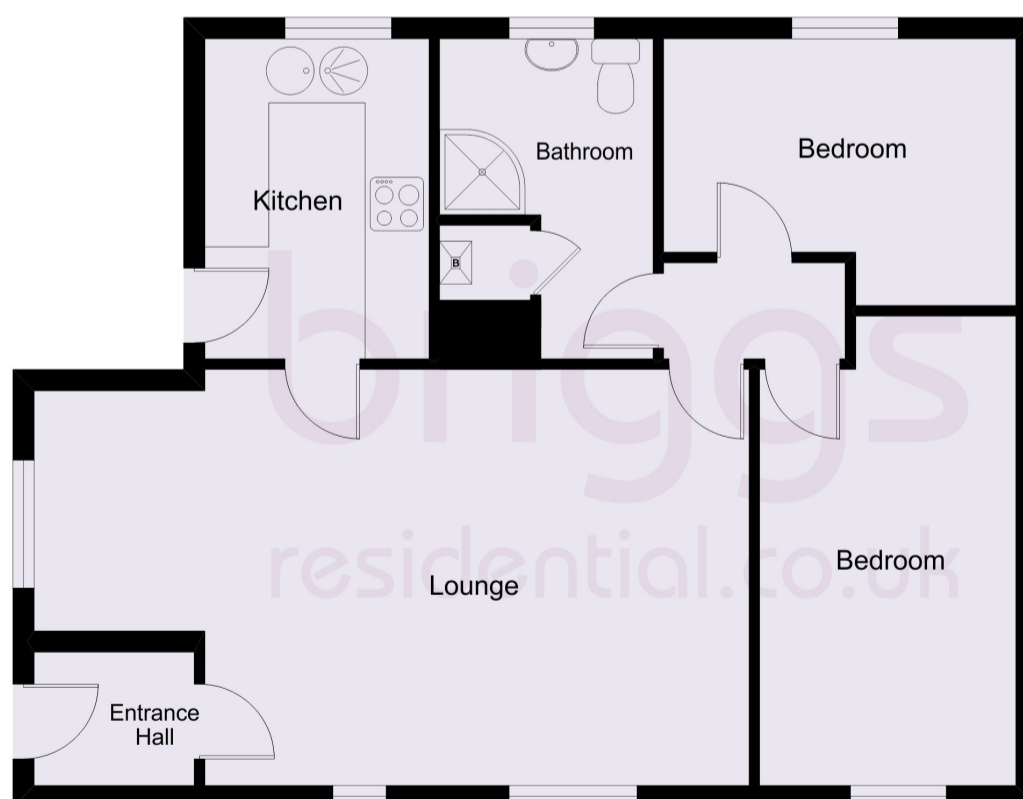

FOR IDENTIFICATION PURPOSES ONLY  
NOT TO SCALE - REF = bg880/10309/2797 - © www.homeplansepc.co.uk 2023

These particulars do not constitute part or all of an offer or contract. The measurements and details are supplied for guidance only and as such must be considered incorrect. Potential buyers are advised to recheck the measurements before committing to any expense. Briggs Residential have not tested any apparatus, equipment, services, fixtures or fittings and it is in the buyers interest to check the working condition of appliances. Briggs Residential have not sought to verify the legal title or structure of the property and suggest buyers obtain such verification from their solicitors.