



## Flat 1, 6 Bamie Terrace, Portobello, Edinburgh, EH15 1BU

Immaculately-Presented Three Bedroom, Ground Floor Apartment

Up to date price and viewing info at [mov8realestate.com/property](https://www.mov8realestate.com/property)

espc rightmove  Zoopla  
find your happy



# Property Description

Immaculately-presented and spacious, three bedroom, ground floor apartment, forming part of a modern, factored residential development, conveniently located in Portobello, east of Edinburgh city centre, close to the beach and seafront promenade.

Comprises: an entrance hallway, open-plan living/dining room and kitchen, utility cupboard, three double bedrooms, an en-suite shower room, and a bathroom.

With light neutral decor throughout and in ready-to-move-in condition, highlights include a modern integrated kitchen, stylish bathroom suites and quality fitted window shutters. In addition, there is gas central heating with multiple climate controls, double glazing, excellent storage provision, and an alarm system. The development also provides a secure entry system, integrated cable/internet connections, well-maintained grounds and a residents car park.

The entrance hall gives access throughout and features the entryphone system, alarm system, carpeted flooring, and space for freestanding storage. A spacious, open-plan public room features carpeted flooring and a wall mount TV point for the lounge area, recessed spot lighting, and easy maintenance wood-effect flooring for the kitchen and dining area. The quality fitted kitchen features wood-effect worktops with a matching upstand, a sink with drainer, and an integrated dishwasher, fridge/freezer, oven and gas hob with a canopy above. A utility cupboard is accessed from the hall, and includes additional store space.

The master bedroom is set to the rear, and includes two built-in mirrored wardrobes, carpeted flooring and a stylish en-suite shower room with a contemporary suite and an integrated shower cubicle. Two further flexible bedrooms are also rear-facing, with carpeted flooring, pendant light fittings, and two built-in stores for bedroom two.

Set internally off the hall, the family bathroom is fitted with a three-piece suite, including a mains shower over the bath, tiled splash walls, and a ladder-style radiator.

A 360 Virtual Tour is available online.

**mov<sup>8</sup>** REAL ESTATE  
Estate Agents and Solicitors

## Flat 1, 6 Barnie Terrace, Edinburgh, EH15 1BU

Approximate Gross Internal Area: (893 sq ft - 83 sq m.)

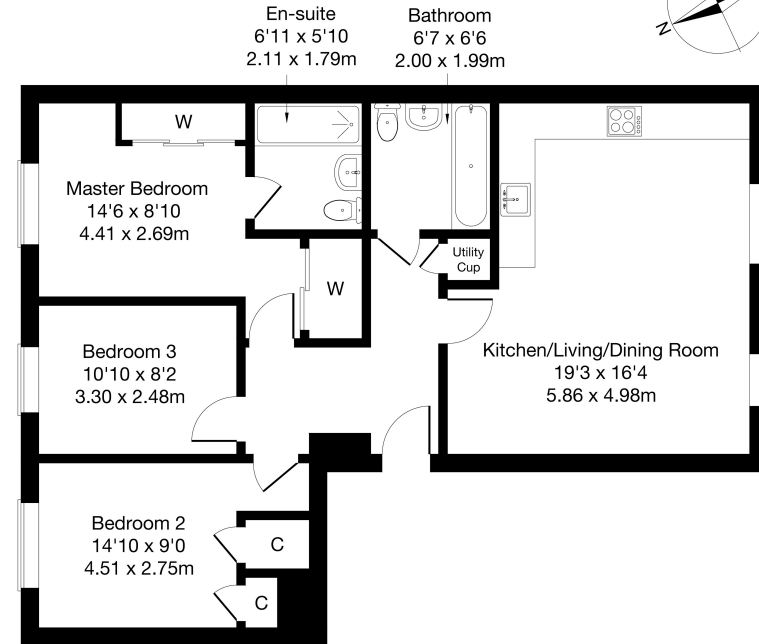

Legal Disclaimer : Floor-plan and measurements are for illustrative guidance only, and not intended to form part of any contract.

# Area Description

Portobello lies on the eastern edge of Edinburgh, and is renowned for its extensive sandy beach and seafront promenade. The area has a bustling high street, with a good range of local shops, bars, restaurants, and banks, whilst The Jewel and Fort Kinnaird offer large supermarkets and a range of major high-street names, restaurants and a multi-screen cinema. Frequent bus services are available

from the High Street, nearby Brunstane rail station offers further commuting options, whilst the A1 and the city bypass are also easily accessed. There are a number of parks, golf courses, and sport facilities in the local area, as well as the Portobello Leisure centre, with its swimming pools, Spa, Turkish baths, gym, fitness studio and soft play.







## Our Services

- Free pre-sale property valuations
- Great value fixed estate agency fees
- Extensive buyer matching database
- Purchase and sale conveyancing

## Contact Us

0345 646 0208

[sales@mov8realestate.com](mailto:sales@mov8realestate.com)

[www.mov8.com](http://www.mov8.com)

### Head Office

6 Redheughs Rigg, Edinburgh, EH12 9DQ

### Glasgow Office

77 Renfrew Street, Glasgow, G2 3BZ



Estate Agents and Solicitors

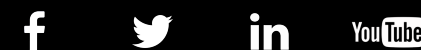

These particulars do not form part of any contract and the statements or plans contained herein are not warranted nor are they to scale. All descriptions, dimensions, areas, reference to condition and necessary permissions for use and occupation and other details are given in good faith, and are believed to be correct, but any prospective purchaser should not rely on them as statements or representations of fact, and any prospective purchaser must satisfy themselves by inspection or otherwise as to the correctness of each of them. The Seller shall not be bound to accept the highest or any offer nor to accept a full offer of the Fixed Price where this is applicable. Approximate measurements have been taken by sonic device and measurements are most often taken to the widest point of any room or space. Services and appliances have not been tested for efficiency or safety and no warranty is given as to their compliance with any Regulations. Offers should be made using the Combined Standard Clauses.