



T: 01909 509001
E: info@bartropanddilks.co.uk
W: www.bartropanddilks.co.uk
A: 78 Bridge Street, Worksop, S80 1JA

FOR SALE

£110,000

336 Gateford Road, Worksop, Nottinghamshire. S81 7DB



Of interest for first time buyers or investors is this three bedroom semi detached home that has gas central heating and uPVC double glazed windows. Being ideal located for local schools and amenities, the property requires an early viewing with the accommodation comprising of; lounge, inner lobby, dining room, kitchen and downstairs bathroom. On the first floor; three bedrooms, bedroom two providing access to the third bedroom. Outside; hardstanding to the front, attractive and generous size rear garden.

Ground Floor

Lounge 3.79m x 3.75m (12' 5" x 12' 4")

With entrance door, front facing bay window, central heating radiator, fire surround with gas fire.

Inner Lobby

With stairs to the first floor.

Dining Room 3.80m x 3.79m (12' 6" x 12' 5")

With a storage cupboard, rear facing window, central heating radiator.

Kitchen 3.16m x 2.17m (10' 4" x 7' 1")

With fitted wall and base units, worksurfaces, side window and door, cooker space, plumbing for an automatic washing machine.

Bathroom

Fitted with a panelled bath, wash hand basin, low flush w.c, side facing window, tiling, central heating radiator.

First Floor

Bedroom One 3.86m x 3.81m (12' 8" x 12' 6")

With a storage cupboard/wardrobe, front facing window, central heating radiator.

Bedroom Two 3.80m x 3.68m (12' 6" x 12' 1")

With a storage cupboard/wardrobe, rear facing window, central heating radiator, access provided to the third bedroom.

Bedroom Three 3.08m x 2.16m (10' 1" x 7' 1")

With the enclosed wall mounted gas fired central heating boiler, rear facing window, central heating radiator.

Outside

Hardstanding

Vehicle hardstanding to the front.

Rear Garden

Generous size with a good range of shrubbery, garden shed.





GROUND FLOOR

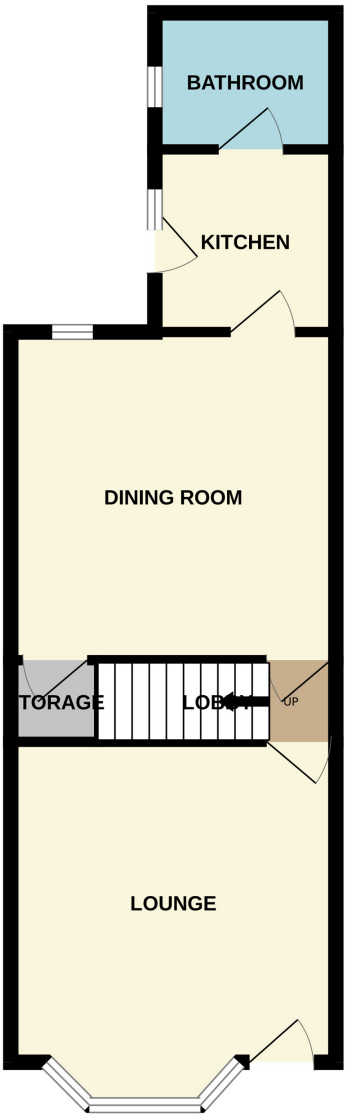

1ST FLOOR

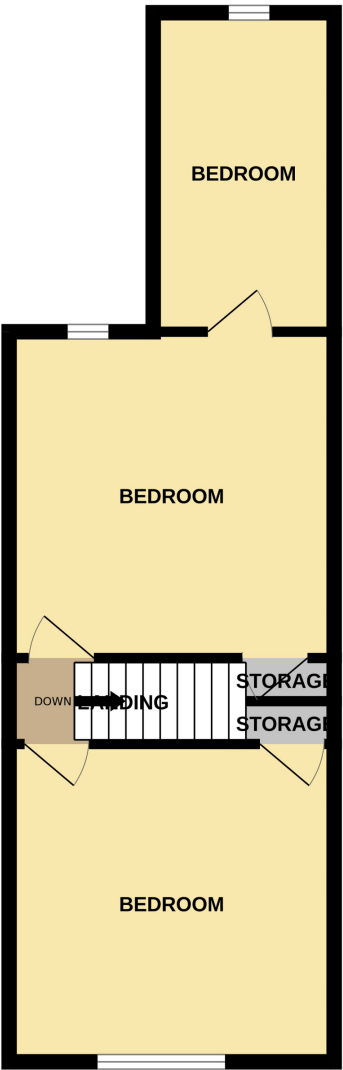

Whilst every attempt has been made to ensure the accuracy of the floorplan contained here, measurements of doors, windows, rooms and any other items are approximate and no responsibility is taken for any error, omission or mis-statement. This plan is for illustrative purposes only and should be used as such by any prospective purchaser. The services, systems and appliances shown have not been tested and no guarantee as to their operability or efficiency can be given.
Made with Metropix ©2025

