

14 Moggridge Close

FOLKESTONE, Kent
CT20 3XJ

£290,000 FREEHOLD

FOR SALE WITH BURNAP + ABEL... Welcome to this charming two-bedroom end terraced home in the desirable neighbourhood of Moggridge Close, Folkestone. Built in November 2023, this property is in pristine, like-new condition and has been meticulously maintained. Step inside to discover a modern kitchen, lounge and cloakroom, a four piece master bathroom, and two bedrooms including an en-suite shower room for added convenience. The spacious living area is perfect for entertaining guests or simply relaxing after a long day. Enjoy outdoor living in your private rear garden which is south facing, ideal for al fresco dining or soaking up the sun. With off-road parking available, you'll never have to worry about finding a spot for your vehicle. This property is being offered with no chain and is ready for its new owners to move in right away. Don't miss out on the opportunity to make this house your new home - schedule a viewing today!



Entrance Hall

Lounge

15' 6" x 13' 1" (4.72m x 3.99m)

Kitchen

9' 11" x 6' 1" (3.02m x 1.85m)

W.C

First Floor Landing

Bedroom One

10' 2" x 9' 7" (3.10m x 2.92m)

En-Suite Shower Room

Bedroom Two

13' 1" x 8' 4" (3.99m x 2.54m)

Bathroom

6' 8" x 6' 2" (2.03m x 1.88m)

Rear Garden

Off Road Parking

Ground Floor
Approx. 31.6 sq. metres (340.1 sq. feet)

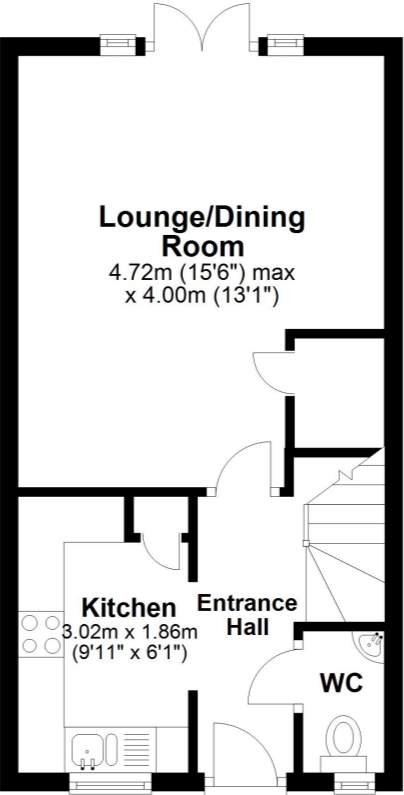

First Floor
Approx. 31.1 sq. metres (335.0 sq. feet)

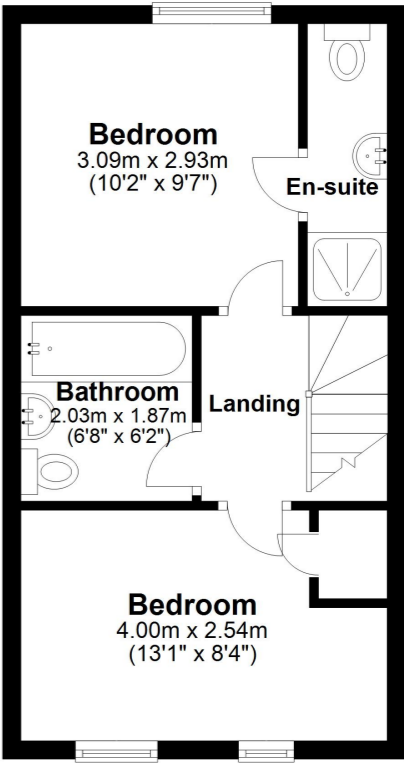

Total area: approx. 62.7 sq. metres (675.1 sq. feet)

Whilst every attempt has been made to ensure the accuracy of the floor plan contained here, measurements of doors, windows, rooms and any other items are approximate and no responsibility is taken for any error, omission or mis-statement. This plan is for illustrative purposes only and should be used as such by any prospective purchaser.
Plan produced using PlanUp.

