



Ivel Road, Shefford, Bedfordshire, SG17 5LB

Guide Price £385,000 Freehold







Step Inside

Ivel Road



About Shefford

Ivel Road

Abt. 17' 7" x 15' 7" (5.36m x 4.75m) Dual aspect open planning living space with under stairs cupboard and double doors leading to rear garden. Currently houses six seater dining table and has been laid with a contemporary wood flooring.





Step Outside

Ivel Road

Abt. 9' 3" x 8' 0" (2.82m x 2.44m) Expertly tiled flooring matching the cupboard doors, stylish fitted worktops with integrated appliances. Spotlights with fitted roller blind to UPVC double glazed window.

Ground Floor

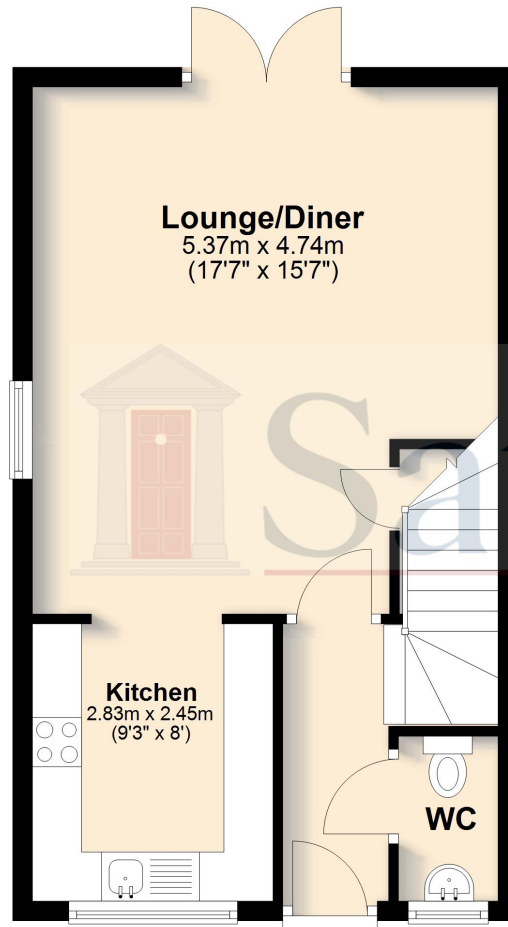

First Floor

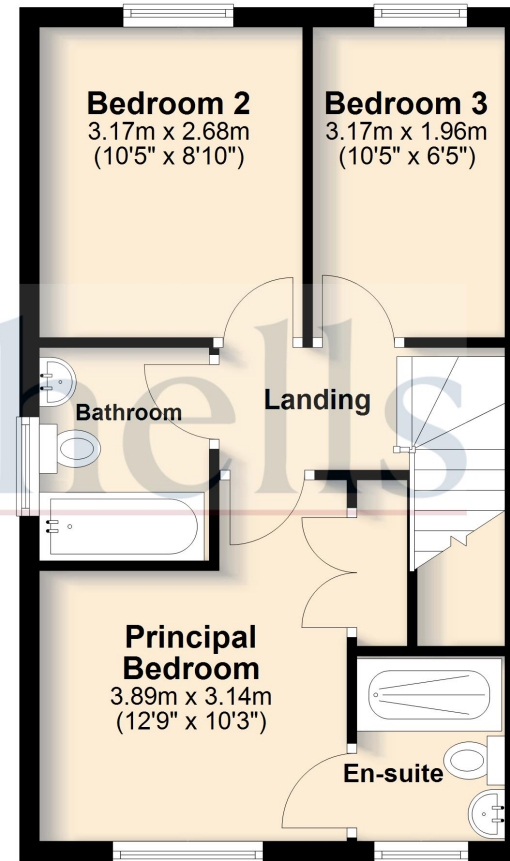

For illustration purposes only - NOT TO SCALE - Measurements shown are approximate. The size and position of doors, windows, appliances and other features are approximate.
Plan produced using PlanUp.

