

elevation

estate agents | est. 1992

9 Whittle Court,
Knowlhill, Milton Keynes, MK5 8FT

Tel: 01908 231 551 
mail@elevationestateagents.com



**31 Wrens Park, Middleton, Milton Keynes,
Buckinghamshire, MK10 9BH**

£450,000 Freehold

- Detached home
- Three double bedrooms and one single
- Master bedroom with en-suite and fitted wardrobes
- Refitted bathroom and en-suite
- Desirable and highly sought-after location
- Local amenities within walking distance
- Utility Room And Cloakroom
- EPC Rating





Located in the highly desirable location of Middleton is this lovely four bedroom detached home. The downstairs of the property comprises of entrance hall, downstairs cloakroom, living room, modern kitchen/utility room and bedroom four/study. While the first floor offers the master bedroom with fitted wardrobes and ensuite, two further double bedrooms and the family bathroom. To the front of the property this is a driveway with off road parking for two vehicles and to the rear a good sized garden. The home benefits from a high specification refitted bathroom and ensuite and wood flooring to the downstairs of the property.

Middleton is a residential area located to the East of Milton Keynes. The area offers playing fields, a sports ground, play parks for children, a paddock, allotments, health centre, Doctors surgery, local shops and Post Office. Within a short distance is Kingston District Centre with a Tesco Extra Superstore and many other national retailers and fast food outlets. The location also benefits an excellent school catchment, which includes both Middleton Primary School and Oakgrove Secondary School.

Living room

4.12m x 3.66m (13' 6" x 12' 0")

Kitchen/Diner

4.56m x 3.0m (15' 0" x 9' 10")

Utility

2.63m x 2.75m (8' 8" x 9' 0")

Bedroom 4/Study

2.62m x 2.87m (8' 7" x 9' 5")

Bedroom 2

2.67m x 5.00m (8' 9" x 16' 5")

Bedroom one

3.67m x 3.41m (12' 0" x 11' 2")

Bedroom Three

2.73m x 3.17m (8' 11" x 10' 5")

Disclaimer

Whilst we have endeavoured to prepare our sales particulars accurately none of the services, appliances or equipment have been tested. A buyer should satisfy themselves on such matters prior to purchase. Any measurements or distances mentioned in these particulars are for guide reference only. If such particulars are fundamental to a purchase, buyers should rely on their own enquiries. All enquiries should be directed to Elevation Estate Agents in the first instance.

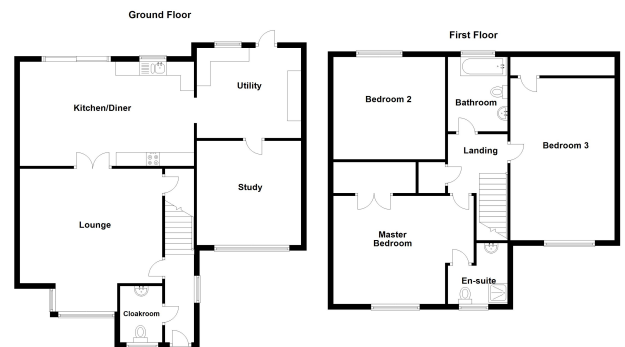

Floor plans are for layout purposes only. Measurements are approximate and subject to inaccuracies. Plans produced using PlanItPro.