

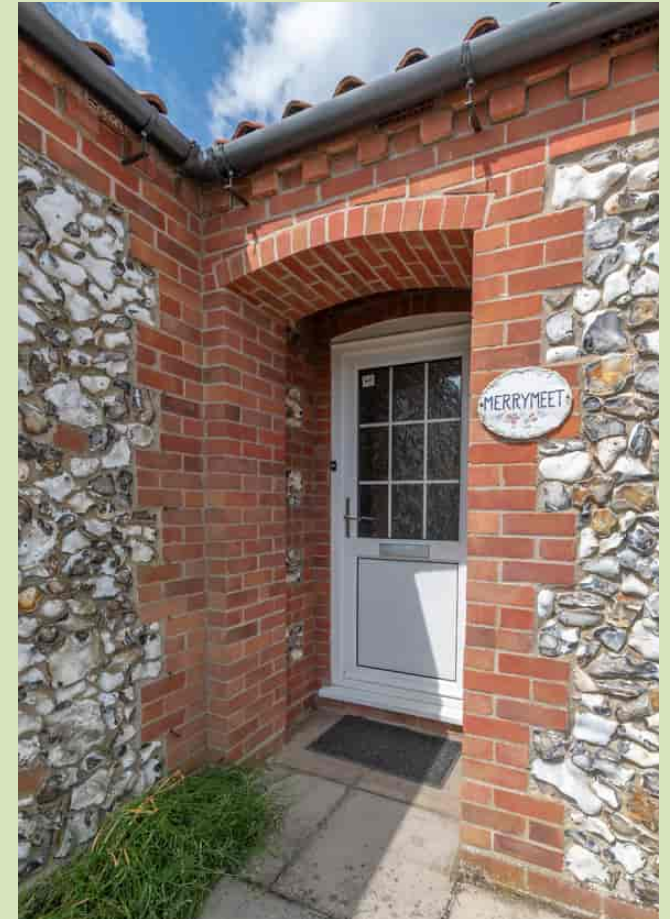

Merrymeet, Burnham Market
Guide Price £635,000

BELTON DUFFEY



MERRYMEET, 3 KESTREL CLOSE, BURNHAM MARKET, NORFOLK, PE31 8EF

A detached brick and flint bungalow with 3 bedroom, 2 bathroom accommodation, garage and west facing garden, situated on a popular cu de sac. No chain.

DESCRIPTION

Merrymeet is an attractive brick and flint bungalow built in the 1990s by well respected local house builders W Shackcloth Limited, on a cul de sac of similar properties on the southern edge of Burnham Market close to open countryside yet within walking distance of the village centre and all amenities.

The well presented and oil centrally heated accommodation includes generous living room, well fitted kitchen with space for breakfast table, en-suite shower room to the principle bedroom, 2 further double bedrooms and a family bathroom. A particular feature of the property is the partly walled and secluded west backing rear garden which enjoys a high degree of privacy. There is also extensive driveway parking and large tandem garage offering various conversion possibilities, subject to the normal consents.

Merrymeet is being offered for sale with no onward chain and the furniture, fixtures and fittings are available by separate negotiation.

SITUATION

Burnham Market is a beautiful, traditional village, close to the North Norfolk Coast, having a full range of shops which include numerous independent boutiques, Post Office, antiques shop, doctor's and dentist surgery, jewellery shop, garage, butchers and food shops, fish shop, wine merchant, deli, and bakery. With a fine parish church and a range of hostelryes including the famous "Hoste Arms" hotel and great restaurants including Socius and No. 29, Burnham Market centre is situated around a village green with mainly Georgian houses in what is considered an extremely desirable village.

The Burnhams comprise 6 villages situated on the North Norfolk Coast, an area of Outstanding Natural Beauty with miles of unspoilt beaches and wild salt marshes punctuated by creeks and small ancient harbours. Wells-next-the-Sea is located 5 miles to the east passing through the spectacular Holkham Estate whilst, to the west, Brancaster Staithe offers excellent sailing and watersports.

STORM PORCH

A brick storm porch and a partly glazed UPVC door leads from the front of the property into:



ENTRANCE HALL

5.67m x 2.92m (18' 7" x 9' 7")

A bright and welcoming entrance to the property with laminate flooring, storage cupboard and a further airing cupboard. Loft hatch, radiator and doors to the principal rooms.

KITCHEN/BREAKFAST ROOM

3.71m x 3.04m (12' 2" x 10' 0")

Double glazed window to front and door to garage. Extensive range of pale green floor and wall mounted storage units in contemporary styling, extensive laminate worksurfaces with inset single drainer sink unit, tiled splashbacks. Room for a small breakfast table.

4 ring ceramic hob with extractor over, fitted double oven, spaces and plumbing for a dishwasher and fridge freezer, ceramic tiled flooring, ceiling recessed downlighters.

SITTING/DINING ROOM

5.37m x 5.0m (17' 7" x 16' 5")

A comfortable room of generous proportions with sliding double glazed doors to rear affording views over and access to the garden, twin double glazed windows to rear. Fireplace recess with slate hearth housing cast iron solid fuel burner, 2 radiators, 4 wall light points and a glazed door to the entrance hall.

BEDROOM 1

4.71m x 3.78m (15' 5" x 12' 5")

Double glazed window to rear with garden views, excellent range of fitted wardrobe cupboards including dressing table unit, further built-in storage cupboard, radiator and a door leading into:

EN-SUITE SHOWER ROOM

2.77m x 1.15m (9' 1" x 3' 9")

Double glazed window to side with obscured glass, fully tiled shower cubicle with a chrome mixer shower, pedestal wash basin, WC. Extensive complementary tiling, ceramic tiled flooring, radiator, extractor fan.

BEDROOM 2

3.92m x 2.99m (12' 10" x 9' 10")

Double glazed window to rear, built-in wardrobe cupboard, radiator.



BEDROOM 3

4.40m x 2.35m (14' 5" x 7' 9")

Double glazed window to rear, radiator.

BATHROOM

2.21m x 1.89m (7' 3" x 6' 2")

Double glazed window to side with obscured glass, panelled bath with shower mixer tap and glass shower screen, pedestal wash basin, WC. Attractive complementary tiling, ceramic tiled flooring, radiator, extractor fan.

OUTSIDE

Merrymeet is approached over an extensive private driveway with turning area providing off road parking for numerous vehicles with neat lawned area and well stocked shrub borders to the side.

The mature, partly walled and enclosed rear garden enjoys a sunny westerly aspect and high degree of privacy. An extensive paved patio with pathway to the timber summerhouse leads to a large neat lawned area having inset mature trees and well stocked raised flower and shrub borders, timber and glazed summerhouse. Attractive brick and flint wall to rear boundary, conifer hedging and fencing to remainder with gated access to front of property.

GARAGE

8.84m x 2.62m (29' 0" x 8' 7")

An attached tandem length garage of generous proportions providing numerous conversion possibilities, subject to the necessary consents.

Up and over door, power and light connected, personal doors to kitchen and garden, windows to rear and side. Utility area to rear with storage cupboards, worksurface, single drainer sink unit and spaces and plumbing for a machine, tumble dryer and over-spill fridge freezer. Grant oil-fired boiler, loft hatch.



DIRECTIONS

From Belton Duffey's Wells-next-the-Sea office, take the A149 coast road towards Hunstanton. After Holkham, turn left signposted Burnham Market and, after Burnham Overy Town, follow the sharp bend round to the left and on into Burnham Market. Pass Burnham Market Stores on your right and take the next left into Ulph Place bearing left again on the B1355 Creake Road.

Take the third right onto Beacon Hill Lane continuing for approximately 500 yards and turn left into Kestrel Close. Take the next left where you will see Merrymeet (number 3) a little further up on the left-hand side.

OTHER INFORMATION

Mains water, mains drainage and mains electricity. Oil-fired central heating to radiators. EPC Rating Band D.

Borough Council King's Lynn and West Norfolk, King's Court, Chapel Street, King's Lynn, PE30 1EX. Council Tax Band n/a (registered for Business Rates).

TENURE

This property is for sale Freehold.

VIEWING

Strictly by appointment with the agent.



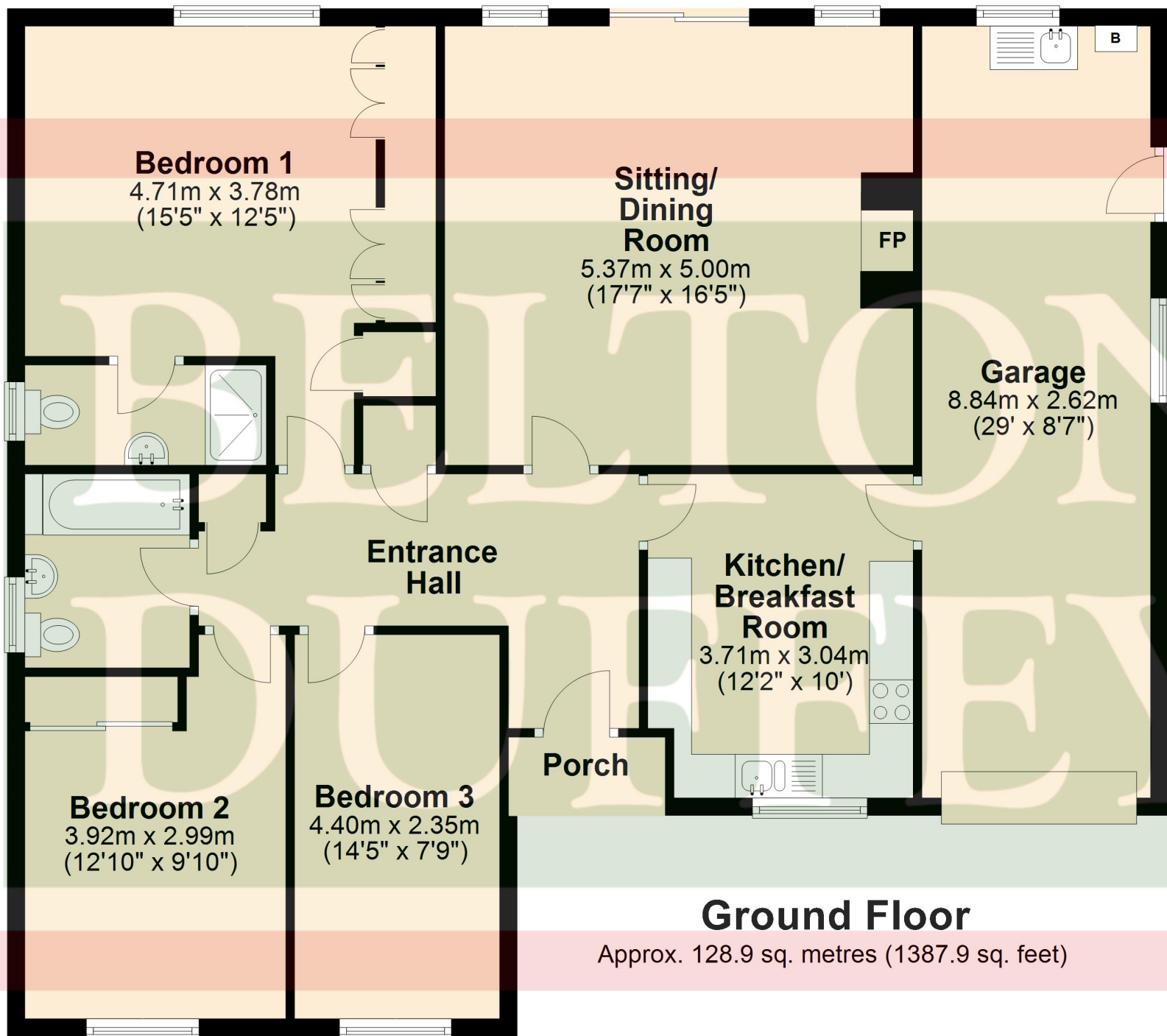

Ground Floor

Approx. 128.9 sq. metres (1387.9 sq. feet)

Total area: approx. 128.9 sq. metres (1387.9 sq. feet)



BELTON DUFFEY

12-16 Blackfriars Street,
King's Lynn,
Norfolk, PE30 1NN.
T: 01553 770055
E: info@beltonduffey.com

3 Market Place,
Fakenham,
Norfolk, NR21 9AS.
T: 01328 855899
E: fakenham@beltonduffey.com

26 Staithe Street,
Wells-next-the-Sea,
Norfolk, NR23 1AF.
T: 01328 710666
E: wells@beltonduffey.com

www.beltonduffey.com

IMPORTANT NOTICES: 1. Whilst these particulars have been prepared in good faith to give a fair description of the property, these do not form any part of any offer or contract nor may they be regarded as statements of representation of fact. 2. Belton Duffey have not carried out a detailed survey, nor tested the services, appliances and specific fittings. All measurements or distances given are approximate only. 3. No person in the employment of Belton Duffey has the authority to make or give representation or warranty in respect of this property. Any interested parties must satisfy themselves by inspection or otherwise as to the correctness of any information given.

