



Flat 67 Homelawn House, Brookfield Road,
Bexhill-on-Sea, East Sussex, TN40 1PN

£97,950



- One Bed Retirement Apartment
- Double Bedroom With Fitted Wardrobes
- Spacious Lounge-Diner
- Modern Fitted Semi-Open Plan Kitchen
- Modern Refitted Shower Room
- Lovely Views Across Landscaped Grounds
- Secure House Managed Development
- 24 Hour Care Line Support Alarm
- Double Glazed & Electric Heating
- Lovely Landscaped Gardens & Grounds
- Excellent Communal Facilities
- Residents Lounge/Function Suite
- Residents laundry & Guest Flat
- Located Adjacent To the Seafront
- Offered For Sale With NO CHAIN!!



2ND FLOOR APARTMENT
463 sq.ft. (43.0 sq.m.) approx.

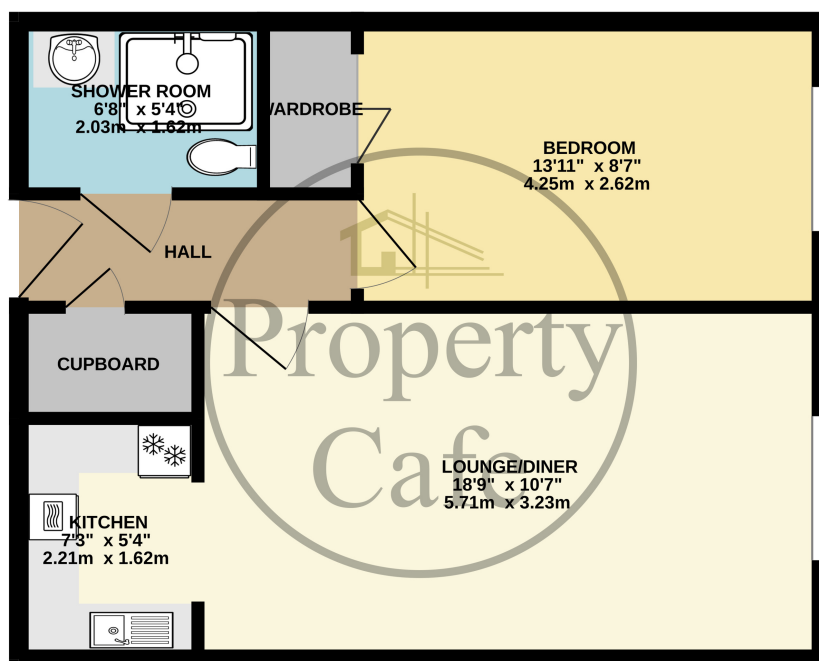

TOTAL FLOOR AREA : 463 sq.ft. (43.0 sq.m.) approx.
 Whilst every attempt has been made to ensure the accuracy of the floorplan contained here, measurements of doors, windows, rooms and any other items are approximate and no responsibility is taken for any error, omission or mis-statement. This plan is for illustrative purposes only and should be used as such by any prospective purchaser. The services, systems and appliances shown have not been tested and no guarantee as to their operability or efficiency can be given.
 Made with Metropix 5.0204

