



MAXWELLS



17 Remembrance Close, Middleton Cheney, Banbury, Northamptonshire. OX17 2SL
Shared Ownership £126,000 - Leasehold



PROPERTY DESCRIPTION

The property is set back from the road with a large driveway to the right hand side of the house and door opening into the entrance hallway where you can find stairs rising to the first floor landing and a door opening to the sitting room. With two double glazed windows the sitting room is a lovely bright space, a door leads from here into the large fitted kitchen / dining room which is fitted with a comprehensive range of cabinets and a selection of appliances. There is a door to a large understairs cupboard and a second door leading to the rear lobby where you can also find the downstairs cloakroom.

From the first floor landing are doors leading to all bedrooms, the family bathroom and access to the loft space. All three bedrooms are double rooms with a fitted wardrobe in bedroom one. The family bathroom is fitted with a white three piece suite with tiling to the splash prone areas.

The rear garden is south facing with a large, attractive paved patio area adjacent to the rear of the house. The garden is laid mainly to lawn and enclosed by timber fencing with a pedestrian gate providing access to the driveway at the side.

Agents note: the property is offered as a 35% shared ownership with 89 years remaining on the lease. We have been advised that further percentages are available to purchase up to 100% (full ownership). The current service charge, ground rent and rent is £461 paid monthly.

POINTS OF INTEREST

- 35% Shared Ownership
- Semi Detached Family Home
- Cul De Sac Location
- Three Double Bedrooms
- Large Kitchen/Dining Room
- Sitting Room
- Downstairs Cloakroom
- Bathroom
- Double Glazed Throughout
- Gas Central Heating
- South East Facing Rear Garden

GROUND FLOOR
41.8 sq.m. (449 sq.ft.) approx.

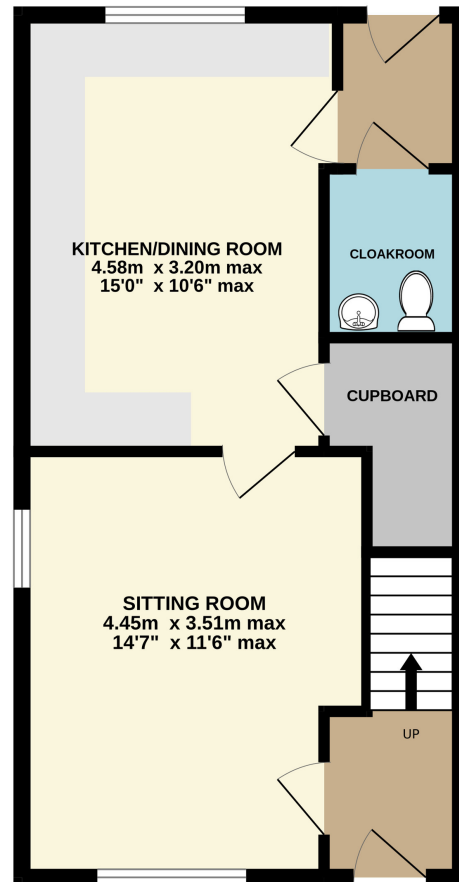

1ST FLOOR
41.8 sq.m. (449 sq.ft.) approx.

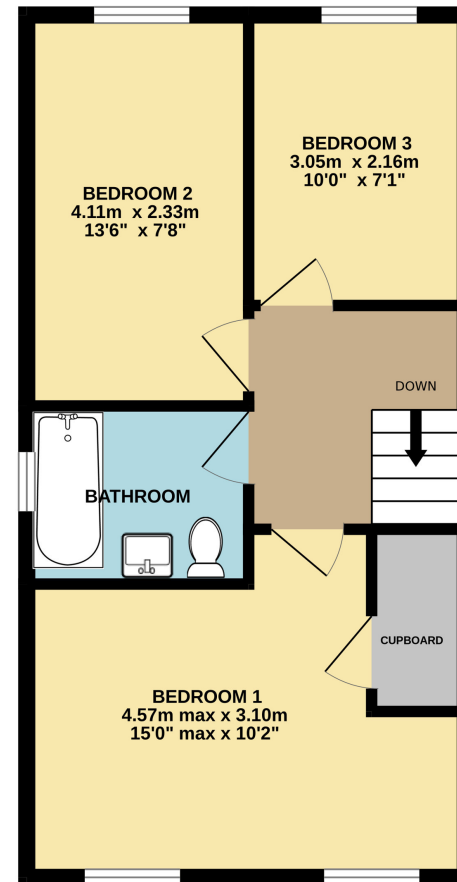

TOTAL FLOOR AREA : 83.5 sq.m. (899 sq.ft.) approx.

Whilst every attempt has been made to ensure the accuracy of the floor plan contained here, measurements of doors, windows, rooms and any other items are approximate and no responsibility is taken for any error, omission or mis-statement. This plan is for illustrative purposes only and should be used as such by any prospective purchaser.
Made with Metropix ©2026

