



3 Regency Court Garden Close, Bexhill-on-Sea, East Sussex, TN40 1RZ

£234,950



- Spacious and bright accommodation throughout
- Modern Two bedroom first floor apartment
- Fitted kitchen and shower room
- Spacious and bright L shaped lounge diner
- Two good size double bedrooms
- Lounge-diner with East facing balcony
- Pleasant entrance hall with ample storage
- Well presented in a neutral colour scheme
- Close to all amenities and seafront
- 960 year lease and share a freehold
- Situated in a sought-after town centre location
- Single garage en-bloc to the rear
- Offered for sale with no onward chain
- Ideal for Bexhill station and town centre
- Internal viewing highly recommended





FIRST FLOOR APARTMENT
651 sq.ft. (60.5 sq.m.) approx.

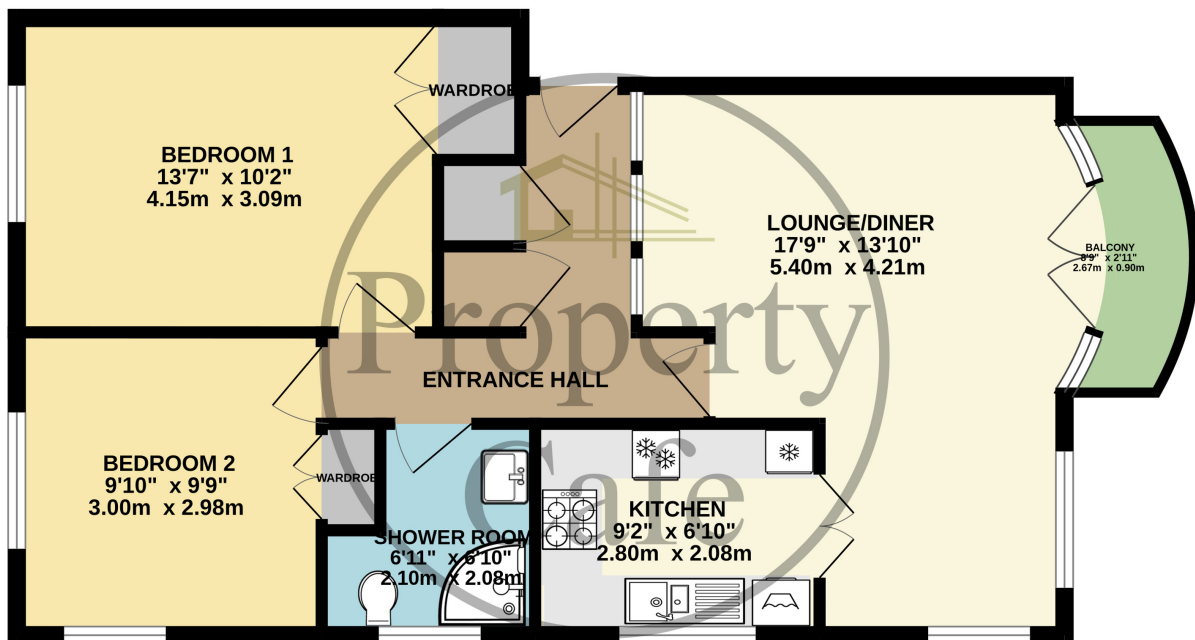

TOTAL FLOOR AREA : 651 sq.ft. (60.5 sq.m.) approx.

Whilst every attempt has been made to ensure the accuracy of the floorplan contained here, measurements of doors, windows, rooms and any other items are approximate and no responsibility is taken for any error, omission or mis-statement. This plan is for illustrative purposes only and should be used as such by any prospective purchaser. The services, systems and appliances shown have not been tested and no guarantee as to their operability or efficiency can be given.
 Made with Metropix ©2024

