



Day & Co  
ESTATE AGENTS

28 Cavendish Street  
Keighley  
BD21 3RG



1 Green Street, Haworth,  
Keighley, West Yorkshire, BD22  
8BE

£119,995

T: 01535 664609

W: [www.dayandcoestateagents.co.uk](http://www.dayandcoestateagents.co.uk)

E: [keighley@dayandcoestateagents.co.uk](mailto:keighley@dayandcoestateagents.co.uk)



- END TERRACE
- WELL PRESENTED ACCOMMODATION
- WALKING DISTANCE TO HAWORTH MAIN STREET
- VIEWING ADVISED
- NO CHAIN

- TWO DOUBLE BEDROOMS
- SEPARATE KITCHEN
- CLOSE TO LOCAL AMENITIES
- GAS CENTRAL HEATING & DOUBLE GLAZING

## SUMMARY

\*\* A WELL PRESENTED, TWO BEDROOM END TERRACE SITUATED ONLY A SHORT WALK FROM THE POPULAR HAWORTH MAIN STREET, COULD APPEAL TO A VARIETY OF BUYERS, GAS CENTRAL HEATING, DOUBLE GLAZING, INTERNAL VIEWING ADVISED, NO CHAIN, EPC RATING E \*\*

## FULL DESCRIPTION

Situated in the sought after village location of Haworth and a short walk away from the famous Main Street is this well presented two double bedroom end of terrace.

This property offers accommodation that could appeal to a variety of buyers and is well worthy of an early, internal viewing.

In brief the accommodation comprises of an inviting entrance with tiled floor, with stairs to the first floor, and a door off to the living room.

At ground floor a spacious L-Shaped living/Dining Room with open fire and window to the front elevation.

Small compact kitchen having a range of base and wall mounted units, worktops, sink, side window, access to a useful storage cellar.

First floor - Double bedroom with window to the front. Bathroom having a three piece suite comprising of a rectangular bath with shower over, WC, wash hand basin, window to the front.

Second floor - double bedroom with window to the side elevation and access to useful under-eaves storage.

Gas central heating and double glazing.

Offered for sale with no onward chain. EPC rating is E.

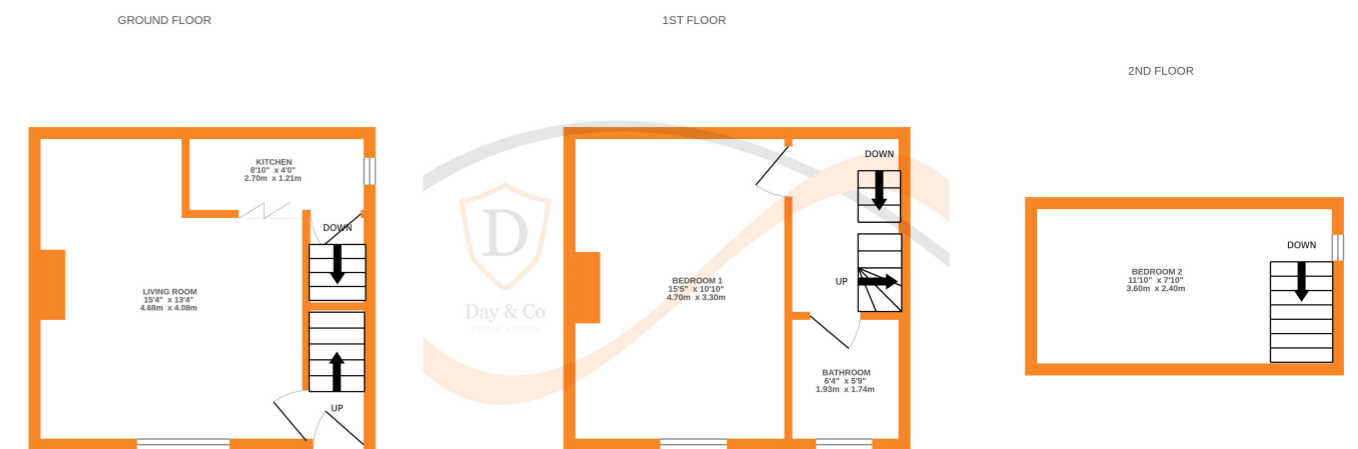

Whilst every attempt has been made to ensure the accuracy of the floorplan contained here, measurements of doors, windows, rooms and any other items are approximate and no responsibility is taken for any error, omission or mis-statement. This plan is for illustrative purposes only and should be used as such by any prospective purchaser. The services, systems and appliances shown have not been tested and no guarantee as to their operability or efficiency can be given.  
Made with Metropix ©2023