



12, Lydyett Lane
Northwich CW8 4JP

£725

www.westates.co.uk
01606 331784



- Character Period Cottage
- Two Reception Rooms
- Modern Fitted kitchen
- Outside Utility Room
- Two Bedrooms
- Modern Bathroom
- Long, Landscaped Garden
- On Road Parking

Description

A charming, fully modernised and exceptionally well presented two bedroom mid-terrace cottage, located in a slightly elevated position on a one-way street, close to the centre of the village. The property has the benefit of PVCu double glazed windows and gas central heating and the accommodation comprises: Dining room, lounge, fully fitted kitchen, outside utility room, first floor landing, two bedrooms and bathroom. To the rear there is a long landscaped garden and parking is available on street. Available either part furnished or unfurnished to suit the tenants requirements. Restrictions apply.



Location
Tenure

EPC Rating: D

Important Notes
Type Here



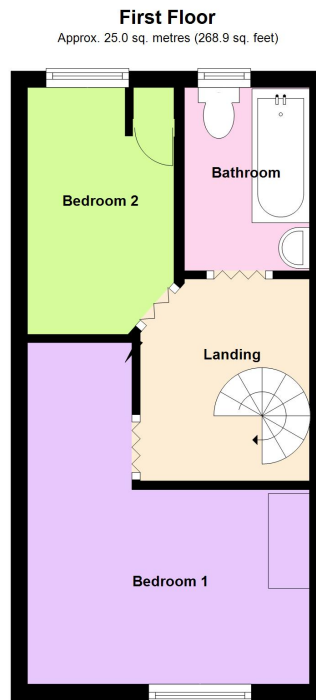
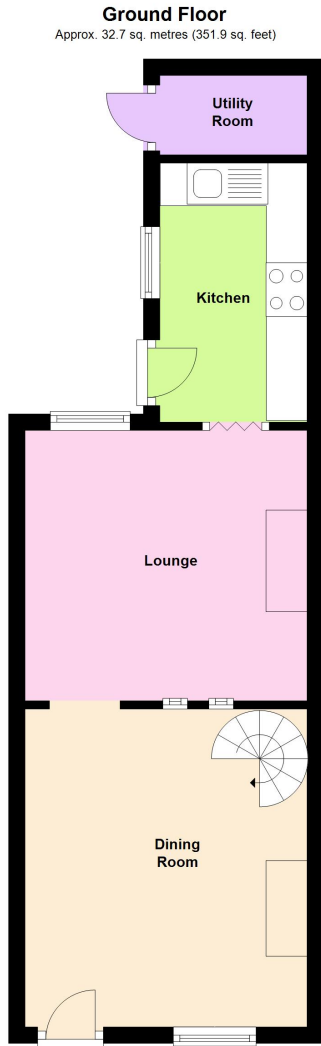

Total area: approx. 57.7 sq. metres (620.8 sq. feet)



These particulars, whilst believed to be accurate are set out as a general outline only for guidance and do not constitute any part of an offer or contract. Intending purchasers should not rely on them as statements of representation of fact, but must satisfy themselves by inspection or otherwise as to their accuracy. All measurements quoted are approximate. We are unable to confirm the working order of any fixtures and fittings including appliances that are included in these particulars. No person in this firm's employment has the authority to make or give any representation or warranty in respect of the property.