



BRADDICK CLOSE

**SIBLEY
PARES**

RESIDENTIAL

BRADDICK CLOSE, MAIDSTONE, KENT ME15 9XQ

Property Information

Sibley Pares are pleased to offer this well maintained three bedroom semi-detached house, situated in a popular location close to the local amenities.

This spacious property comprises a living room with feature fireplace, modern fitted kitchen/dining room, utility room and downstairs shower room. Upstairs comprises of master bedroom and second bedroom with built in wardrobes and a third bedroom.

Local Information

Offering excellent local amenities including sought after schools and local shops. The town centre of Maidstone is around a mile away and offers three shopping centres, bars, restaurants and train stations taking you into London in under an hour.

Three Bedroom Semi-Detached Home | Sought After Location | Kitchen/Dining Room | Spacious Living Room | Downstairs Shower Room | Utility Room | Good Size Well Maintained Rear Garden

£1,500 pcm

Important Information

Tenure: Freehold
Viewing: Strictly by Appointment with Sibley Pares

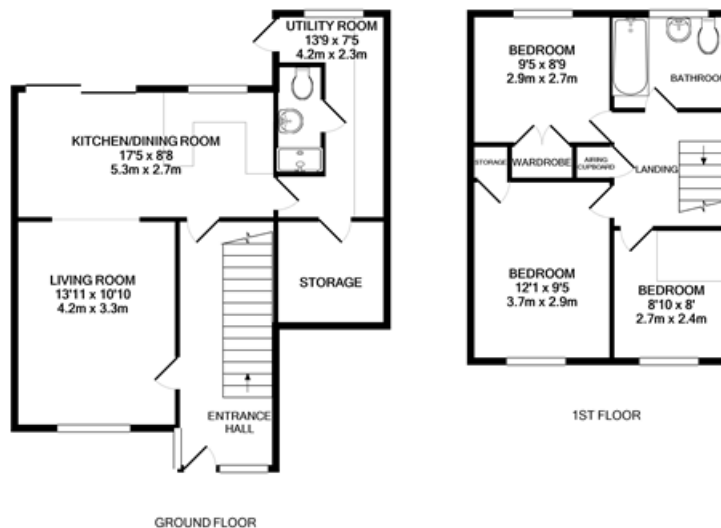

Whilst every attempt has been made to ensure the accuracy of the floor plan contained here, measurements of doors, windows, rooms and any other items are approximate and no responsibility is taken for any error, omission, or mis-statement. This plan is for illustrative purposes only and should be used as such by any prospective purchaser. The services, systems and appliances shown have not been tested and no guarantee as to their operability or efficiency can be given.
Made with Metropix ©2020

Call now to avoid missing out.

NOTE: Rental, prices or any other charges are inclusive of VAT unless otherwise stated. MISREPRESENTATION ACT 1967. These particulars are believed to correct, their accuracy cannot be guaranteed and are expressly excluded from any other contract. Any intending purchaser must satisfy himself by inspection or otherwise as to the correctness of each of the statements contained in these particulars. No fittings, appliances or services mentioned have been tested by Sibley Pares'

1 ASHFORD ROAD, MAIDSTONE ME14 5BJ
01622 673 086 | enquiries@sibleypares.co.uk

sibleypares.co.uk



**SIBLEY
PARES**