

rodgers  
estate agents



**Outfield Road**  
Chalfont St Peter, Buckinghamshire, SL9 9PN



## £400,000 Freehold

Located at an end of a cul de sac, an end of terrace house situated within easy walking distance of the village with all its amenities and excellent schools. The property, although in need of updating and modernisation, has great scope to extend to the side and rear, subject to the usual planning permissions. The accommodation on the ground floor comprises of an entrance lobby, sitting room, dining room, kitchen and utility area. On the first floor there is a landing, two double bedrooms and a bathroom. Further features include gas central heating, double glazing, off street parking and a delightful rear garden. No upper chain.

### Entrance Lobby

UPVC front door with opaque leaded light glass inset. Wall thermostat control. Stairs leading to first floor and landing. Double glazed window over looking side aspect. Casement door with opaque glass insets leading to:

### Utility Area

7' 7" x 6' 1" (2.31m x 1.85m) Cupboard housing electric meter. Radiator. Casement door with opaque glass inset leading to covered side passage. Archway to:

### Kitchen

9' 4" x 7' 4" (2.84m x 2.24m) Partly tiled with wall and base units. Worksurfaces. Stainless steel sink unit with mixer tap and drainer. Space for gas cooker. Plumbed for washing machine. Double glazed window over looking rear aspect. Door to:

### Dining Room

9' 4" x 9' 1" (2.84m x 2.77m) Coved ceiling. Radiator. Double glazed window over looking rear aspect.

### Sitting Room

10' 6" x 10' 2" (3.20m x 3.10m) Feature fireplace with wooden mantle, wrought iron inset and tiled hearth. Radiator. Double glazed window over looking front aspect.

### First Floor

#### Landing

Access to loft. Airing cupboard with lagged cylinder and wall mounted central heating boiler unit. Radiator. Double glazed window over looking side aspect.

## Bedroom 1

13' 7" x 10' 5" (4.14m x 3.17m) Fitted wardrobes and cupboard units. Large storage cupboard. Radiator. Two double glazed windows over looking front aspect.

## Bedroom 2

10' 11" x 9' 11" (3.33m x 3.02m) Radiator. Double glazed window over looking rear aspect.

## Bathroom

6' 5" x 5' 6" (1.96m x 1.68m) Partly tiled with a suite incorporating bath with mixer tap and shower attachment, w.c and wash hand basin. Radiator. Opaque double glazed window over looking rear.

## Outside

### Detached Garage

18' 11" x 9' 8" (5.77m x 2.95m) With up and over door. Pedestrian side door.

### To The Front

Herringbone brick paved driveway. Hedge boundaries and flower bed border.

### To The Rear

Garden mainly laid to lawn with wooden fence boundaries. Paved patio area. A wide variety of shrubs, trees and plants. Wooden shed. Greenhouse. Garden pond. Outside tap. Covered pedestrian side access with casement doors either end.



# 7 Outfield Road

Approximate Gross Internal Area  
Ground Floor = 34.2 sq m / 369 sq ft  
First Floor = 34.2 sq m / 369 sq ft  
Total = 68.4 sq m / 738 sq ft

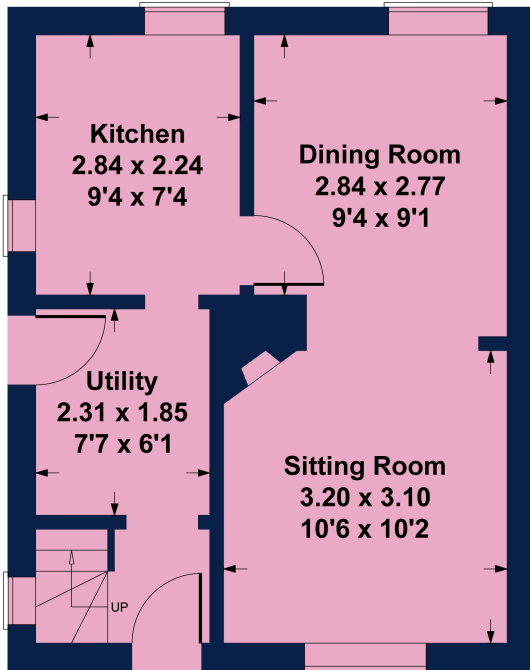

Ground Floor

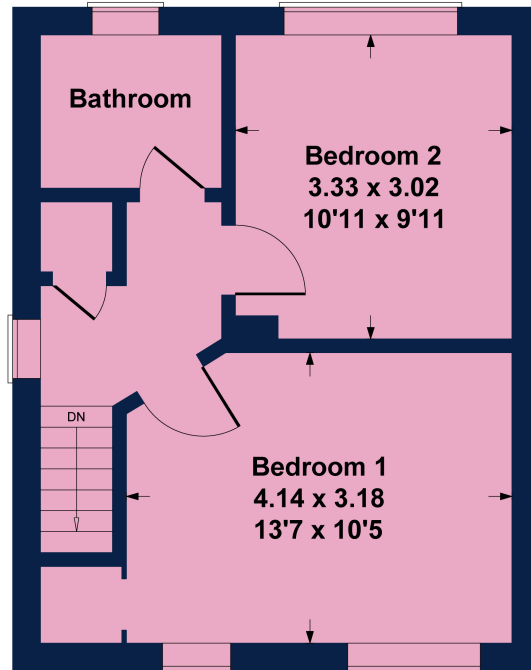

First Floor

Not to Scale. Produced by The Plan Portal 2024  
For Illustrative Purposes Only.



Important Notice: Rodgers Estate Agents give notice that their solicitors and any joint agents give notice that:

1. They are not authorised to make or give any representations or warranties in relation to the property either here or elsewhere, either on their own behalf or on behalf of their client or otherwise. They assume no responsibility for any statement that may be made in these particulars. These particulars do not form any part of any offer or contract and must not be relied upon as statements or representation of fact.

2. Any areas, measurements or distances are approximate. The text, photographs and plans are for guidance only and are not necessarily comprehensive. It should not be assumed that the property has all necessary planning, building regulation or other consents and Rodgers Estate Agents have not tested any appliances, equipment or facilities. Purchasers must satisfy themselves by inspection or otherwise.

30 Market Place  
Chalfont St Peter  
Buckinghamshire  
SL9 9DU

5 Park Lane  
Harefield  
Middlesex  
UB9 6BJ

[csp@rodgersstates.com](mailto:csp@rodgersstates.com)

[harefield@rodgersstates.com](mailto:harefield@rodgersstates.com)

For further information or an appointment to view please call: Harefield 01895 823333 Market Place 01753 880333