



Two Bedroom Terraced House  
Clandon Road, Lords wood, Chatham, Kent, ME5 8UN

Offers Over £250,000  
Freehold

Clandon Road, Lords wood, Chatham, Kent, ME5 8UN

Offers Over £250,000

Freehold

## Description

Popular Lords wood area. This terrace house is being sold with no chain!

Well situated for local bus routes and schools, this is a great property for anyone wishing to get onto the property ladder or as an investment purchase. Previously tenanted the current owner has recently replaced the consumer unit. Both bedrooms are of double size. There are both front and rear gardens.

Perfect for putting your own stamp on.

Call the Greyfox sales team today to book a viewing.

## Key Features

- No chain
- Two double bedrooms
- Terrace house
- Ideal for first time buyers or investors
- Popular road
- Lords wood location
- Garden approx 20 X 15

## Local Area

Lords Wood is a suburb of Chatham, located approximately 3 miles outside of Chatham Town Centre. With local amenities including local shops, schools and a sports leisure centre. With frequent bus services in to the main town centres and mainline railway stations. For those who need to commute, the property is close to Kings Ferry commuter coach pick up points and both the M2/M20 motorways servicing the coast and London.

GROUND FLOOR  
334 sq.ft. (31.0 sq.m.) approx.

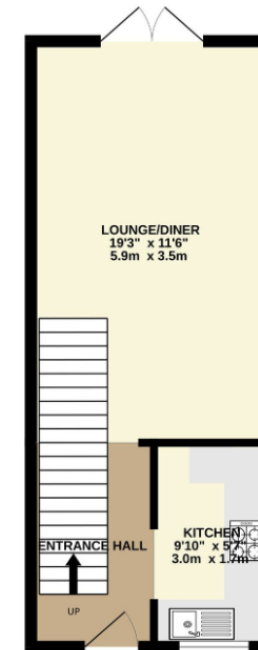

1ST FLOOR  
334 sq.ft. (31.0 sq.m.) approx.

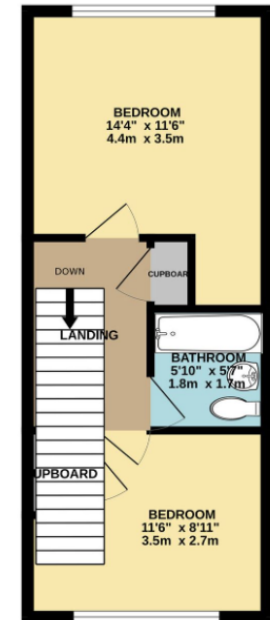



## Property Location

Clandon Road, Lords wood, Chatham, Kent, ME5 8UN

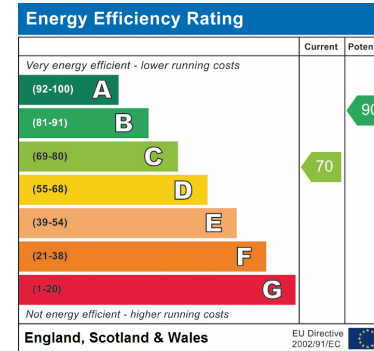
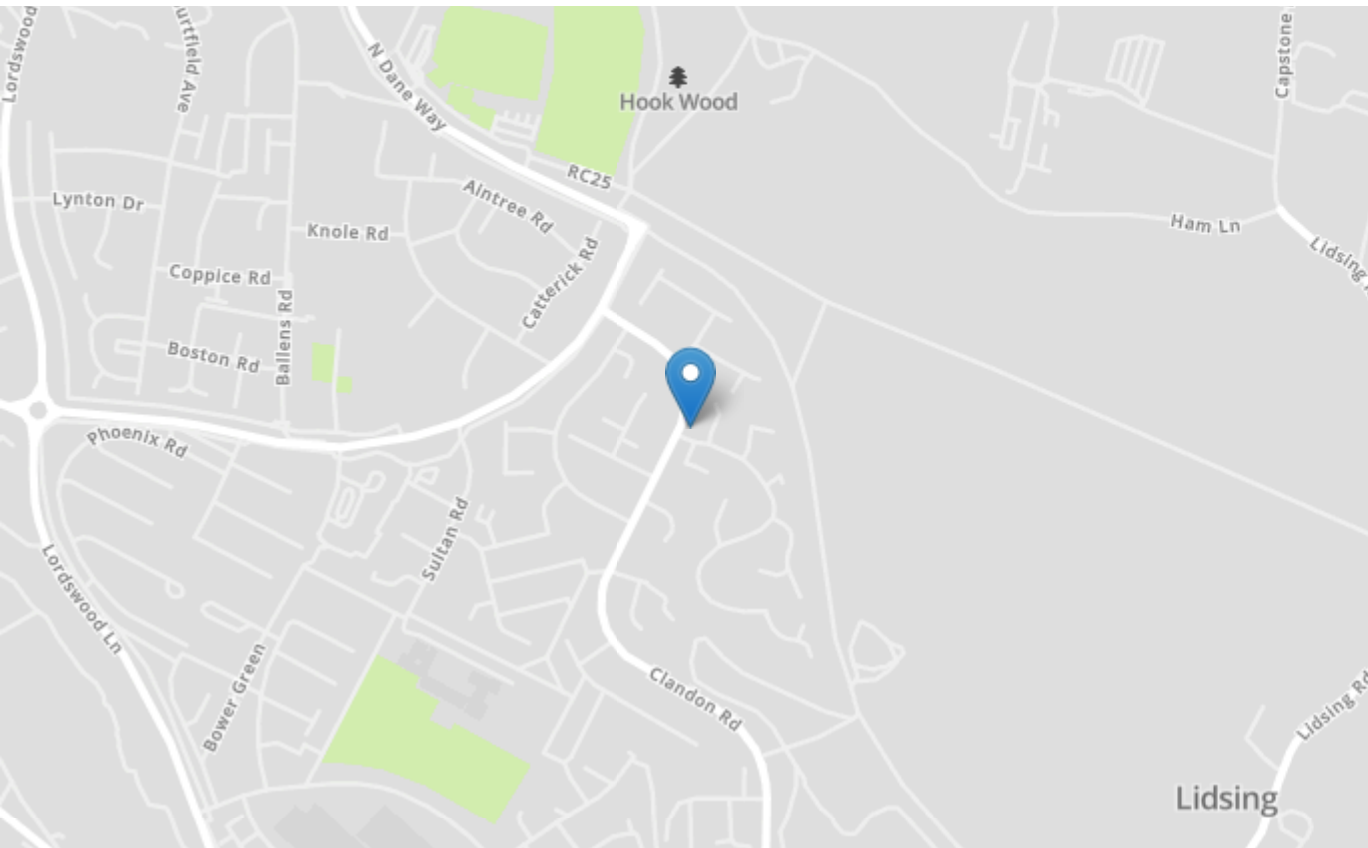

<b>Tenure</b>	Freehold
<b>Lease Term</b>	N/A
<b>Ground Rent</b>	N/A
<b>Service Charge</b>	N/A
<b>Local Authority</b>	Medway council
<b>Council Tax</b>	Band B

### Greyfox Walderslade

Unit 2, Thetford House  
Walderslade Village Centre  
Walderslade Road  
Chatham  
Kent  
ME5 9LR  
Tel: 01634 672227 Email:  
walderslade@greyfox.co.uk

### Greyfox Rainham

67C High Street  
Rainham  
Kent  
ME8 7HS  
Tel: 01634 377737 Email:  
rainham@greyfox.co.uk

#### Agent Notes

These particulars are prepared as a general guide to a broad description of the property and should not be relied upon as a statement or representation of fact and do not constitute part of an offer or contract. The seller does not make or give nor do our employees or Greyfox have authority to make or give any representation or warranty to the property. We have not carried out a structural survey and the services, appliances and specific fittings have not been tested. All photographs, measurements, floorplans and distances referred to are given as a guide only and should not be relied upon for the purchase of carpets or any other fixtures or fittings. Lease details, service charges and ground rent (where applicable) and council tax are given as a guide only and should be checked and confirmed by you on inspection and your solicitor prior to exchange of contracts. If there are any points of particular importance to you we will be pleased to check the information for you and to confirm that the property remains available. This is particularly important should you be travelling some distance to view and where statements have been made by us to the effect that the information has not been verified. The copyright of all details, photographs and floorplans remain exclusive to Greyfox. For details of our privacy policy and referral fee arrangements with any of our selected partner companies please visit <https://www.greyfox.co.uk/legal/privacy> and <https://www.greyfox.co.uk/referral-fees>.