



**Day & Co**  
ESTATE AGENTS

28 Cavendish Street

Keighley

BD21 3RG



**16 Shaw Lane, Oxenhope,  
Keighley, West Yorkshire, BD22  
9QL**

**£180,000**

T: 01535 664609

W: [www.dayandcoestateagents.co.uk](http://www.dayandcoestateagents.co.uk)

E: [keighley@dayandcoestateagents.co.uk](mailto:keighley@dayandcoestateagents.co.uk)



- SOLD WITH TENANT IN SITU
  - Two Bedrooms
  - EPC Rating Is D
- Charming Extended Terrace Cottage
  - Sought After Village Location

SUMMARY

\*\* TO BE SOLD WITH TENANT IN SITU (NOT VACANT POSSESION) \*\* A CHARMING EXTENDED 2 BEDROOM TERRACE COTTAGE, 2 RECEPTION ROOMS, MODERN FITTED KITCHEN - SOUGHT AFTER VILLAGE LOCATION OF OXENHOPE!!, EPC rating is D.

FULL DESCRIPTION

\*\* TO BE SOLD WITH TENANT IN SITU (NOT VACANT POSESSION) \*\*

A delightful two bedroom extended terrace cottage situated in the sought after village location of Oxenhope. This character property has accommodation briefly comprising of a lounge having a front entrance door, windows to the front elevation. The dining room leads into the extended kitchen having a range of modern base and wall mounted units, integrated oven, fridge freezer, and dishwasher. To the first floor there are two bedrooms, and the house bathroom which has a bath with shower over, WC, wash hand basin, chrome heated towel rail.

Externally there is a rear yard with storage shed with a small area further.

Gas central heating and double glazing.

EPC rating is D.

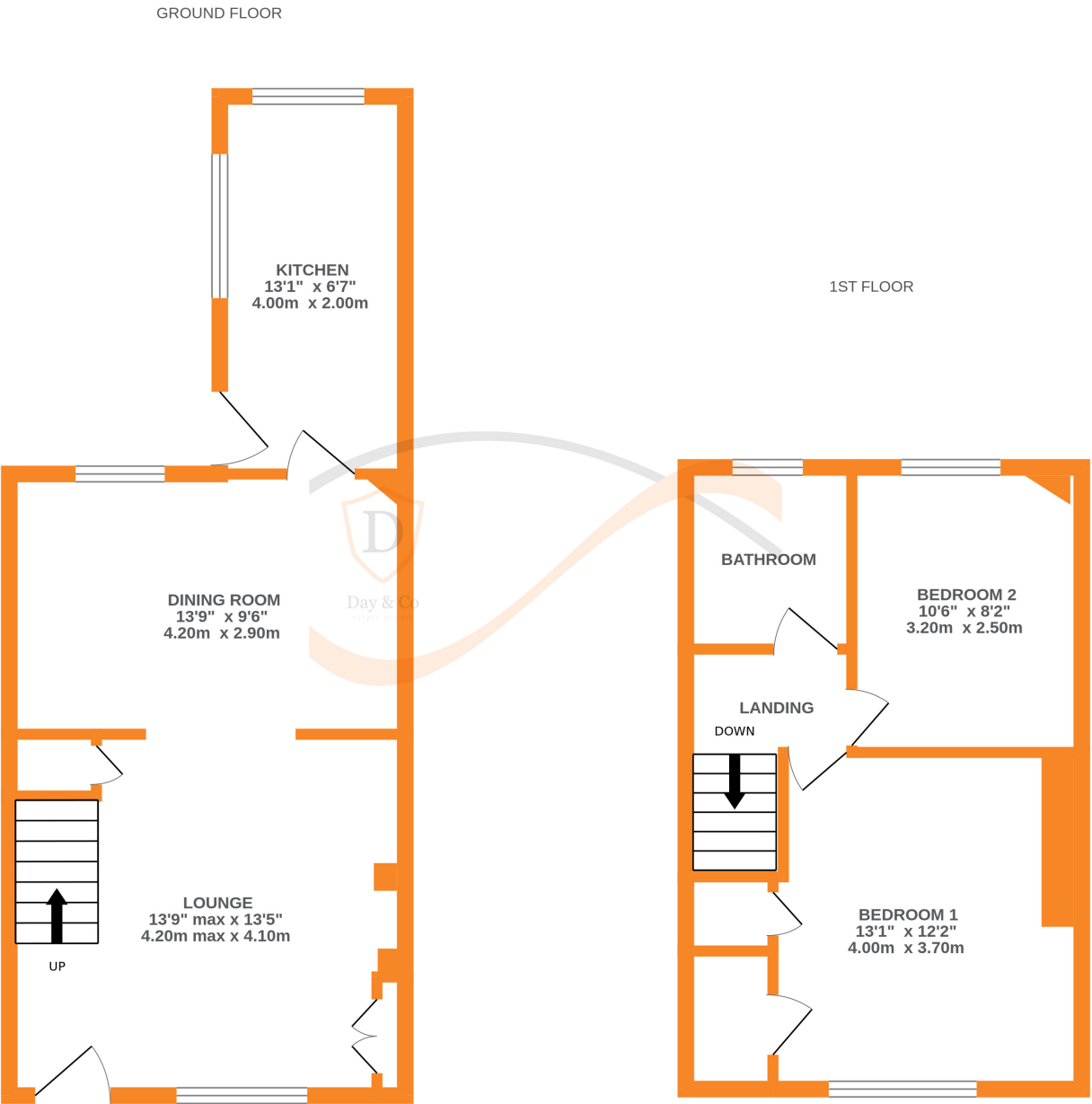

Whilst every attempt has been made to ensure the accuracy of the floorplan contained here, measurements of doors, windows, rooms and any other items are approximate and no responsibility is taken for any error, omission or mis-statement. This plan is for illustrative purposes only and should be used as such by any prospective purchaser. The services, systems and appliances shown have not been tested and no guarantee as to their operability or efficiency can be given.  
Made with Metropix ©2025