



Three Bedroom Terraced House

Henry Street, Rainham, Gillingham, Kent, ME8 8HE

Guide Price £270,000

Freehold

Henry Street, Rainham, Gillingham, Kent, ME8 8HE

Guide Price £270,000

Freehold

Description

Guide Price £270,000 - £290,000. Charming & Spacious Three Bedroom Home in the Heart of Rainham – Move-In Ready!

This beautifully presented three-bedroom terraced property in central Rainham is the perfect next step on the property ladder or an ideal first-time purchase. With its unbeatable location, just a short walk to Rainham Train Station, the bustling town centre, excellent transport links, and great selection of good schools, convenience is at your doorstep!

Inside, you'll find a cosy yet stylish lounge featuring a charming log burner, perfect for those cosy nights in. The separate dining room provides an inviting space for entertaining, while the elegant shaker-style kitchen is well-equipped for all your culinary adventures. A modern downstairs bathroom adds to the home's contemporary appeal. Upstairs, you'll discover two spacious double bedrooms plus a larger-than-average single bedroom (off the second) currently a nursery, offering plenty of flexibility for your needs. Outside, the walled front garden adds character, while the fabulous south-facing rear garden, complete with a sunny patio and lush lawn is the perfect spot for summer BBQs, playtime, or simply unwinding.

With stylish décor throughout, all that's left to do is unpack and enjoy! Homes like this don't stay on the market for long, contact the Greyfox Sales Team in Rainham today to arrange your viewing!

Key Features

- Three Bedroom Terraced Home
- Popular Rainham Location, Close to Shops, Schools & Amenities
- Walking Distance to Rainham Train Station
- Two Reception Rooms
- Perfect Family Home, First Time Purchase or Potential Investment Opportunity
- Beautifully Presented Throughout
- Modern Downstairs Bathroom
- South Facing Garden Measuring approx 112 x 14ft

Local Area

Rainham in the Medway towns is located descending towards the banks of the river Medway, approximately 39 miles from London. The ancient Watling Street main road (A2) runs through the town with the M2 motorway on the southern edge with good links to the M25/M20. There are a good number of shops and facilities within the town, a mainline station and a selection of local schools including Rainham Mark Grammar School.

GROUND FLOOR
473 sq.ft. (43.9 sq.m.) approx.

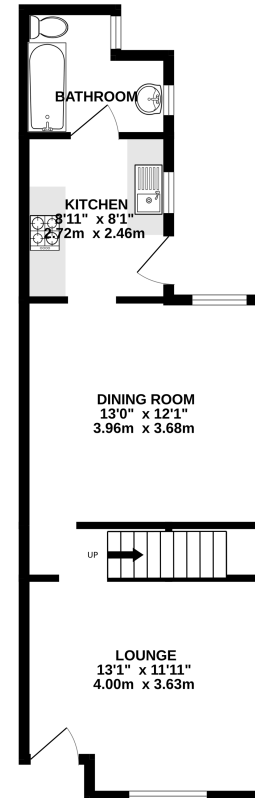

1ST FLOOR
430 sq.ft. (40.0 sq.m.) approx.

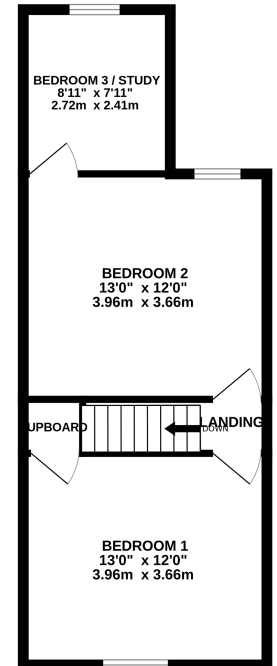

TOTAL FLOOR AREA : 903 sq.ft. (83.9 sq.m.) approx.

Whilst every attempt has been made to ensure the accuracy of the floorplan contained here, measurements of doors, windows, rooms and any other items are approximate and no responsibility is taken for any error, omission or mis-statement. This plan is for illustrative purposes only and should be used as such by any prospective purchaser. The services, systems and appliances shown have not been tested and no guarantee as to their operability or efficiency can be given.
Made with Metropix 12/2025



Property Location

Henry Street, Rainham, Gillingham, Kent, ME8 8HE

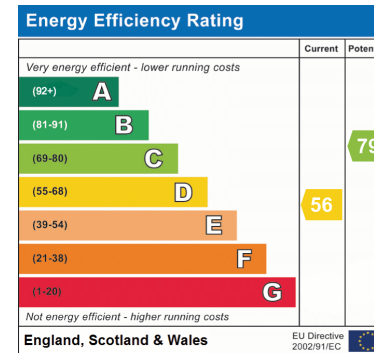
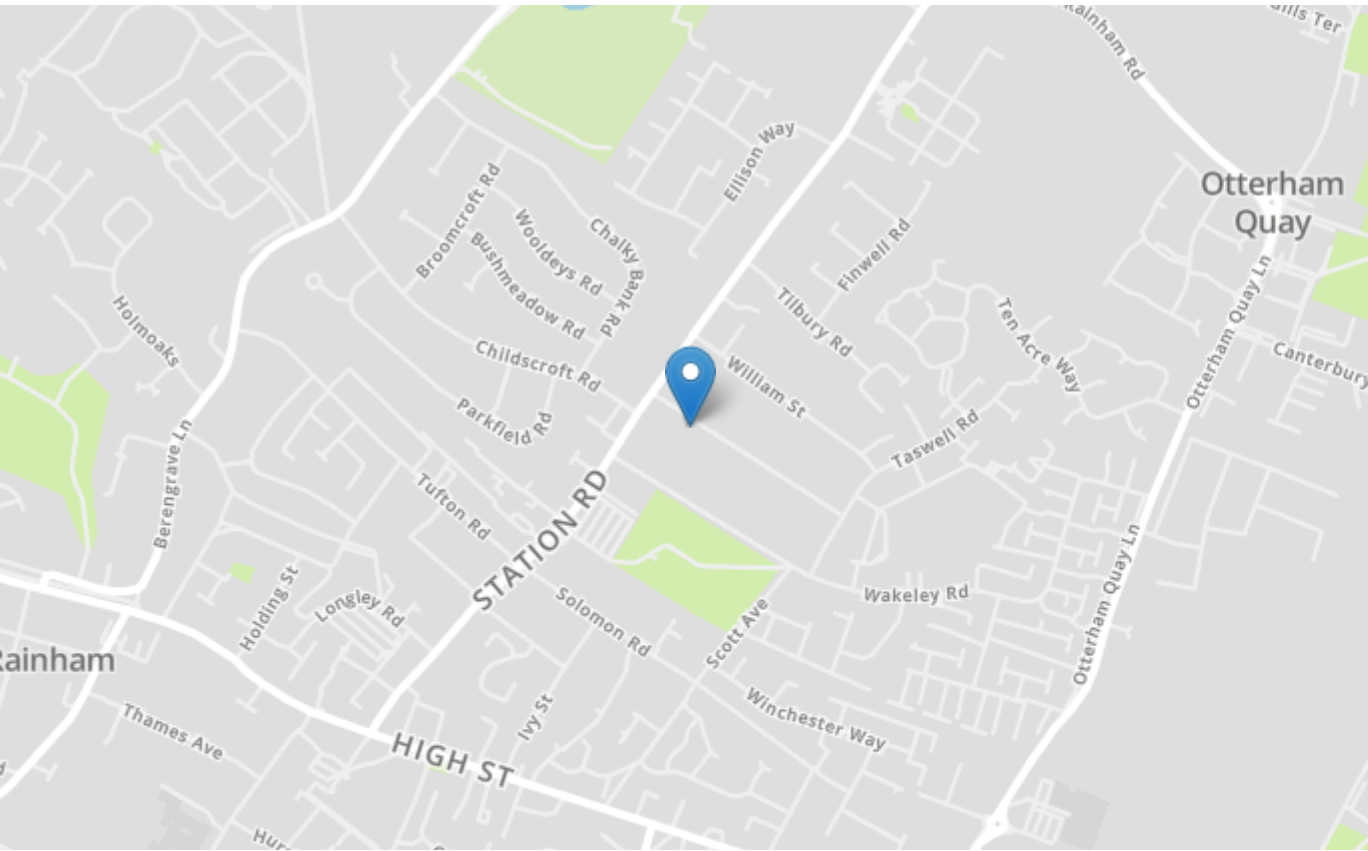

Tenure	Freehold
Lease Term	N/A
Ground Rent	N/A
Service Charge	N/A
Local Authority	Medway
Council Tax	Band B

Greyfox Walderslade

Unit 2, Thetford House
Walderslade Village Centre
Walderslade Road
Chatham
Kent
ME5 9LR
Tel: 01634 672227 Email:
walderslade@greyfox.co.uk

Greyfox Rainham

67C High Street
Rainham
Kent
ME8 7HS
Tel: 01634 377737 Email:
rainham@greyfox.co.uk

Agent Notes

These particulars are prepared as a general guide to a broad description of the property and should not be relied upon as a statement or representation of fact and do not constitute part of an offer or contract. The seller does not make or give nor do our employees or Greyfox have authority to make or give any representation or warranty to the property. We have not carried out a structural survey and the services, appliances and specific fittings have not been tested. All photographs, measurements, floorplans and distances referred to are given as a guide only and should not be relied upon for the purchase of carpets or any other fixtures or fittings. Lease details, service charges and ground rent (where applicable) and council tax are given as a guide only and should be checked and confirmed by you on inspection and your solicitor prior to exchange of contracts. If there are any points of particular importance to you we will be pleased to check the information for you and to confirm that the property remains available. This is particularly important should you be travelling some distance to view and where statements have been made by us to the effect that the information has not been verified. The copyright of all details, photographs and floorplans remain exclusive to Greyfox. For details of our privacy policy and referral fee arrangements with any of our selected partner companies please visit <https://www.greyfox.co.uk/legal/privacy> and <https://www.greyfox.co.uk/referral-fees>.