



## Andromeda, The Street, Cressing, Braintree, Essex. CM77 8DG.

Michaels Property Consultants are delighted to present to the market 'Andromeda', a rather unique three bedroom detached house sitting on a fantastic 'wrap around' plot, whilst also occupying an enviable private road position consisting of just four properties within the ever sought-after village of Cressing. This picturesque Essex village is also conveniently positioned within walking distance to the Cressing train station which offers direct links to London Liverpool Street, the Braintree Designer Village which hosts an excellent range of shops & eateries, and the Braintree town centre.

- Individually Built Three Bedroom Detached House
- Potential To For Double-Storey Extension (STPP)
- Stunning Wrap Around Gardens
- Sought After Village Of Cressing
- Garage With Electric Roller Door
- Recently Built Single-Storey Extension With Footings To Build up
- Private Road Consisting Of Just 5 Properties
- Picturesque Farmland Views
- Presented To An Excellent Standard Throughout
- Ground Floor Cloakroom & En Suite To Master





# Property Details.

## Ground Floor

Entrance Hall

Cloakroom

Kitchen/Diner



22' 2" x 9' 11" (6.76m x 3.02m)

## Lounge



16' 10" x 11' 11" (5.13m x 3.63m)

## Family Room



17' 10" x 13' 0" (5.44m x 3.96m)

## First Floor

### Bedroom One



16' 10" x 11' 11" (5.13m x 3.63m)

### En Suite Shower Room

### Bedroom Two

12' 11" x 9' 11" (3.94m x 3.02m)

### Bedroom Three

9' 11" x 8' 11" (3.02m x 2.72m)

# Property Details.

## Family Bathroom



## Outside

### Wrap Around Gardens



### Garage With Electric Roller Door

### Frontage & Driveway Parking

# Property Details.

## Floorplans

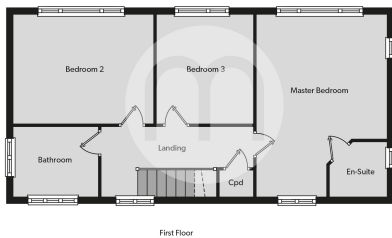
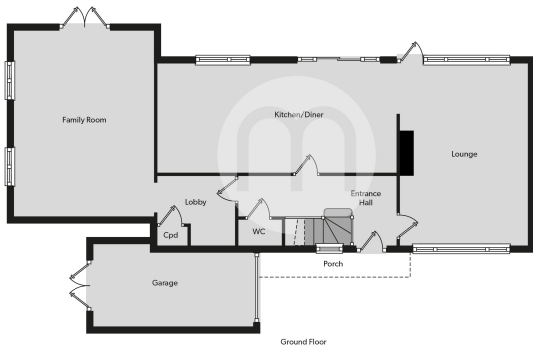

## Location

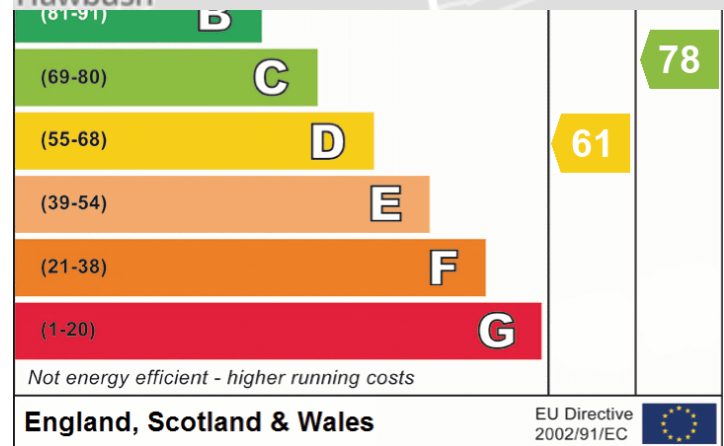
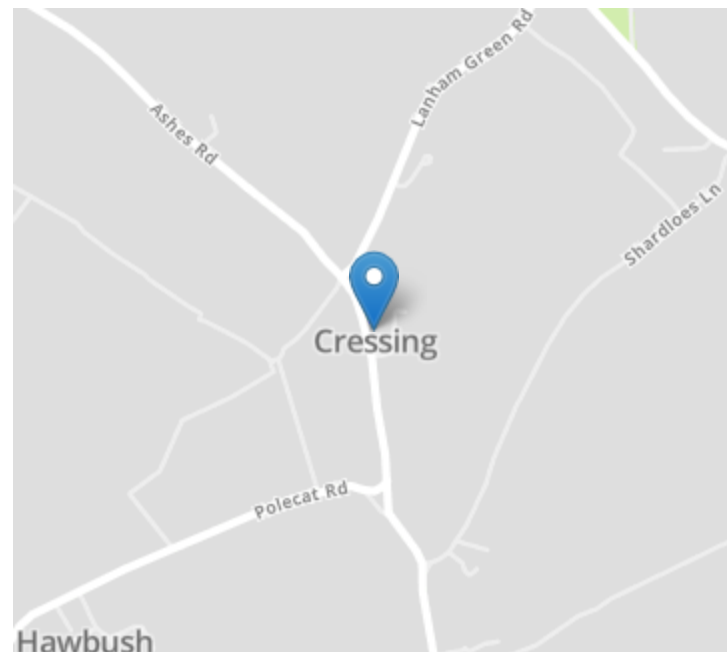

We have not carried out a structural survey and the services, appliances and specific fittings have not been tested. All photographs, measurements, floor plans and distances referred to are given as a guide only and should not be relied upon for the purchase of carpets or any other fixtures or fittings. Gardens, roof terraces, balconies and communal gardens as well as tenure and lease details cannot have their accuracy guaranteed for intending purchasers. Lease details, service ground rent (where applicable) are given as a guide only and should be checked and confirmed by your solicitor prior to exchange of contracts.