



Queensdale Crescent, London, W11 4TN

**Cow & Co**  
LONDON



GUIDE PRICE OF £250,000-350,000. A one double bedroom apartment situated in a popular location. Offered to the market with no onward chain and requiring modernisation.

Convenient for the many local shops and restaurants of Holland Park Avenue, while Westfield shopping Centre is only 0.3 miles away. The property is situated moments away from Holland Park and Shepherds Bush tube stations.



- One bedroom apartment
- Panoramic views across London
- Excellent amenities and transport links nearby
- Great local schools
- lift service
- Large living area with space to entertain and dine.
- Requires some modernisation.
- No onward chain

# Queensdale Crescent, London, W11

Approximate Area = 569 sq ft / 53 sq m

For identification only - Not to scale

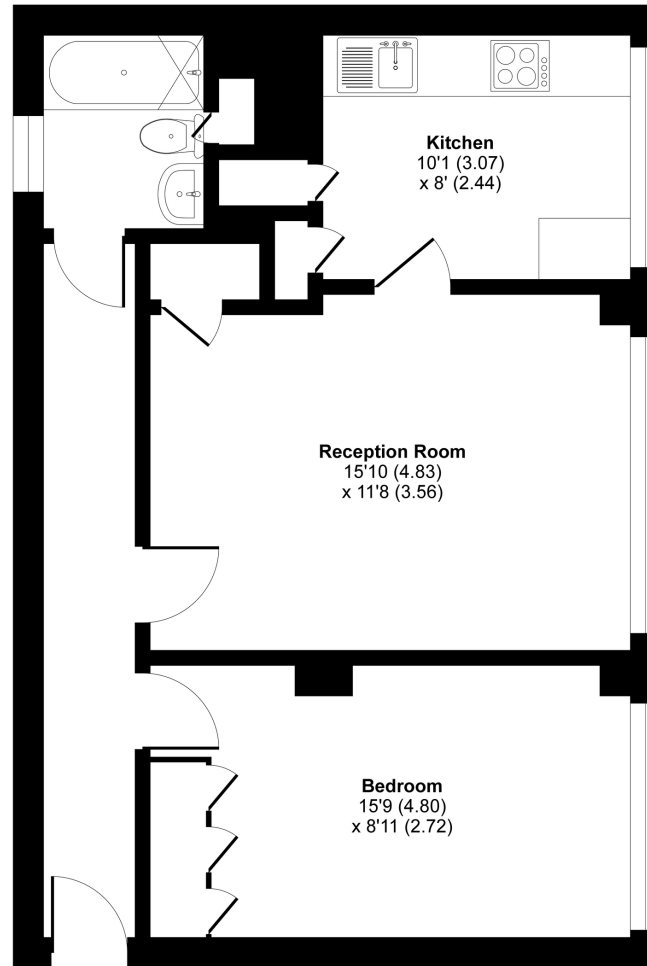

**FOURTEENTH FLOOR**



Floor plan produced in accordance with RICS Property Measurement Standards incorporating International Property Measurement Standards (IPMS2 Residential). © nichecom 2021. Produced for Cow & Co Properties Ltd. REF: 789830

Tel: 0208 065 0010  
Email: [thehub@cowandco-london.com](mailto:thehub@cowandco-london.com)  
Web: [cowandco-london.com](http://cowandco-london.com)

Agents note: All measurements are approximate and whilst every attempt has been made to ensure accuracy they are for general guidance only and must not be relied on. The fixture and fittings referred to have not been tested and therefore no guarantee can be given that they are in working order. Internal photographs are reproduced for general information and it must not be inferred that any item shown is included with the property.

**Cow & Co**  
LONDON