



Day & Co
ESTATE AGENTS

28 Cavendish Street
Keighley
BD21 3RG



37 Pasture Avenue, Oakworth,
Keighley, West Yorkshire, BD22
7QF

£199,995

T: 01535 664609

W: www.dayandcoestateagents.co.uk

E: keighley@dayandcoestateagents.co.uk

- EPC Rating Is C
- Two Double Bedrooms
- Fabulous Modern Fitted Kitchen With Integrated Appliances
- Driveway To The Side
- Superbly Presented Semi-Detached Property
- Conservatory
- Generous Size Well Maintained Garden With Patio

SUMMARY

****A SUPERBLY PRESENTED 2 BEDROOM SEMI-DETACHED PROPERTY, POPULAR VILLAGE LOCATION OF OAKWORTH WITH EXCELLENT ACCESS TO THE PRIMARY SCHOOL!!**** Having a conservatory, driveway to the side, generous size well maintained garden & patio, fabulous modern fitted kitchen - **VIEWING ESSENTIAL TO FULLY APPRECIATE!!** EPC is C.

FULL DESCRIPTION

Of interest to a variety of buyers is this superbly presented two double bedroom semi-detached property, situated on this popular development in the village of Oakworth with excellent access to the local primary school. The well proportioned accommodation comprises of an entrance porch, the spacious lounge has an open staircase to the first floor, two radiators, under stairs storage cupboard, and double glazed window to the front. The dining kitchen has an attractive range of modern base and wall mounted units with complimenting worktop surfaces, tiled flooring, range cooker, appliances to include extractor hood, fridge/freezer and dishwasher and gives access to a good size conservatory which in turn gives access to the rear garden. To the first floor there are two double bedrooms, the master having a built in storage cupboard and two double glazed windows to the front. The bathroom completes the internal accommodation having a bath with shower over, WC, wash hand basin, chrome heated towel rail. Externally the property has a driveway to the side, and a well maintained generous size rear garden with patio. Viewing is highly recommended to fully appreciate, EPC rating is C.

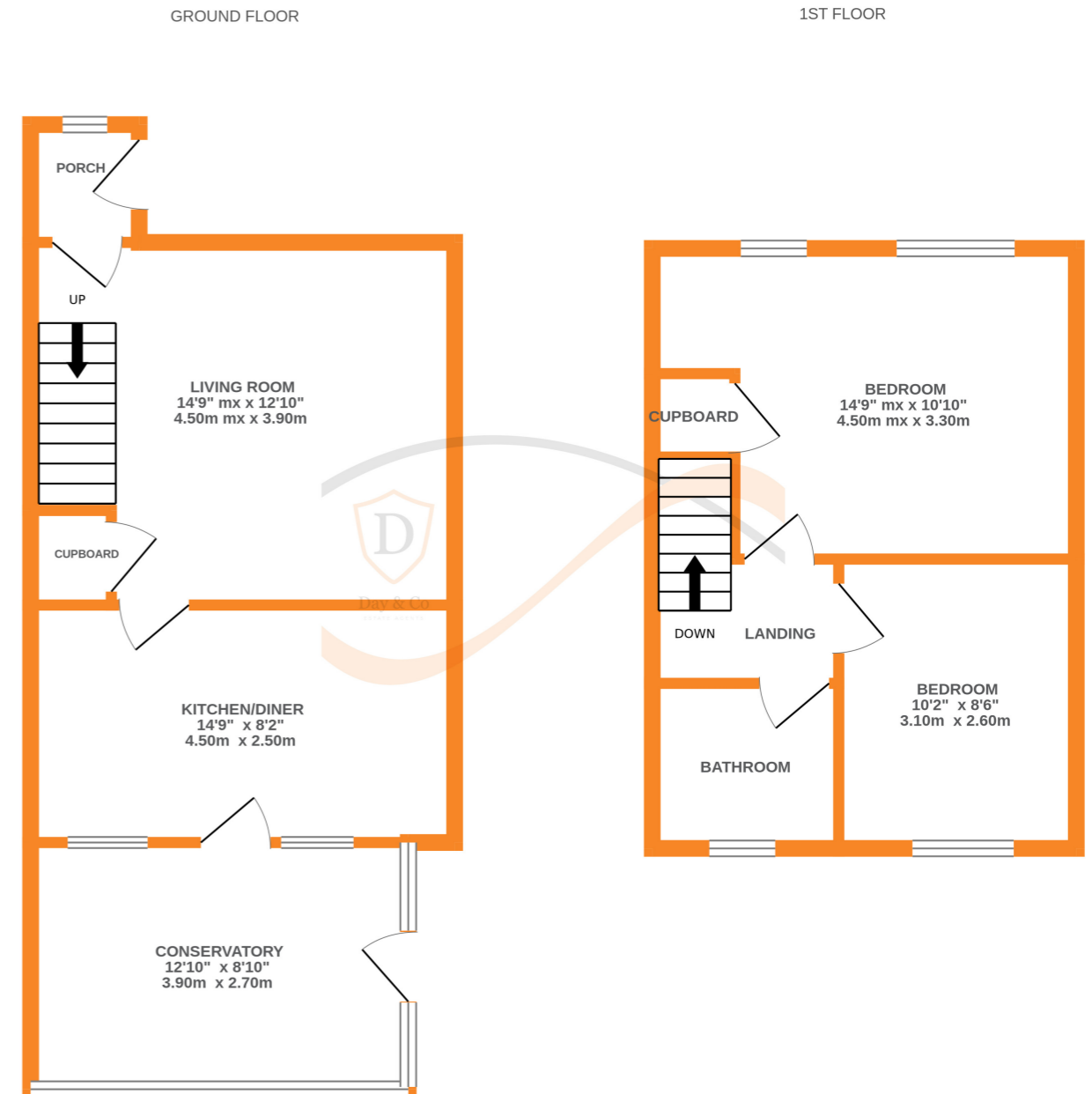

Whilst every attempt has been made to ensure the accuracy of the floorplan contained here, measurements of doors, windows, rooms and any other items are approximate and no responsibility is taken for any error, omission or mis-statement. This plan is for illustrative purposes only and should be used as such by any prospective purchaser. The services, systems and appliances shown have not been tested and no guarantee as to their operability or efficiency can be given.
Made with Metropix ©2024