

Lynton Avenue, London, W13

Approximate Floor Area = 143.9 sq m / 1550 sq ft

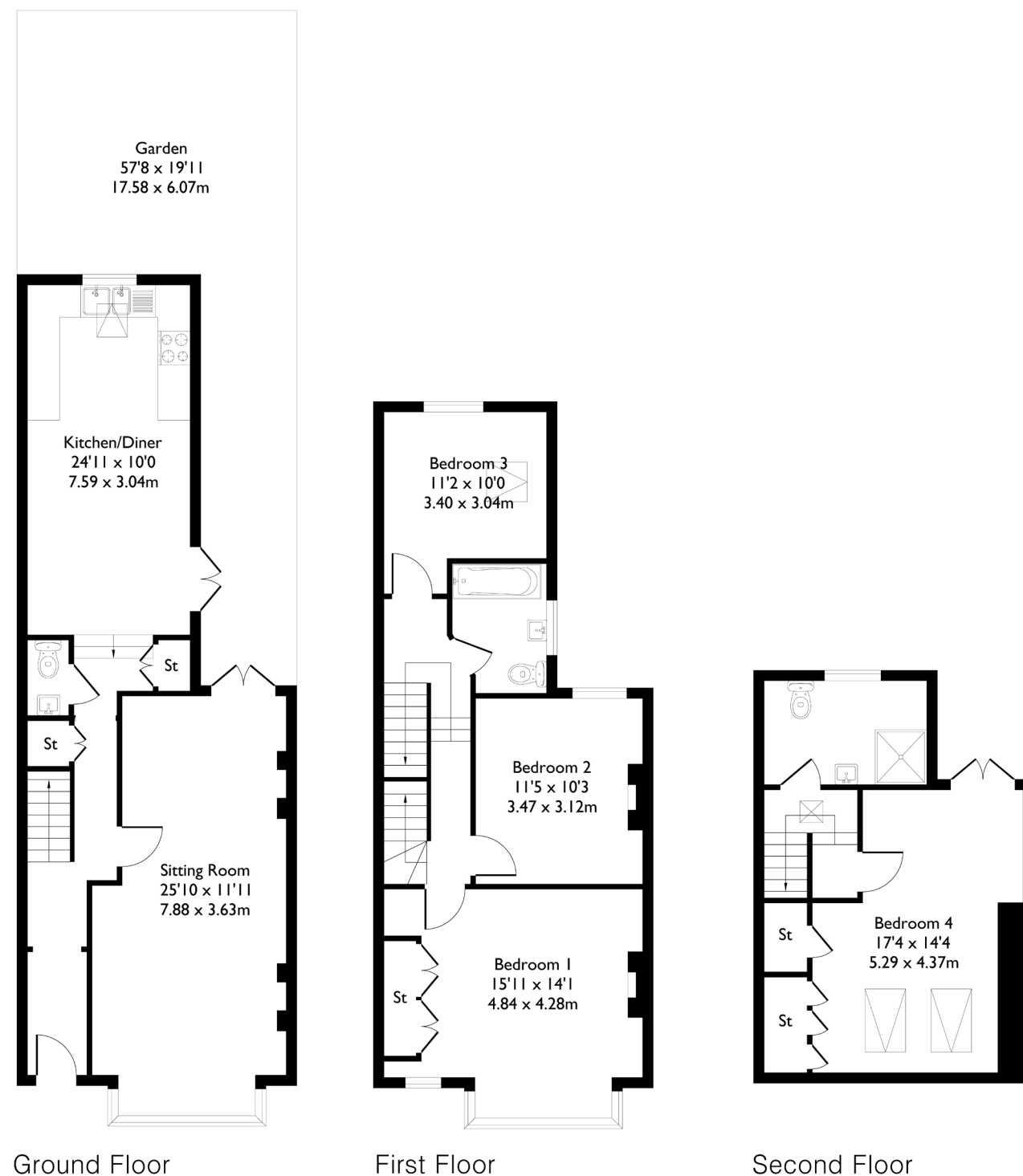

4 BEDROOM HOUSE

Lynton Avenue, W13

O.I.E.O. £1,125,000

Welcome to this well-presented four bedroom, two bathroom semi-detached home, perfectly located in the heart of Ealing.

Ready to move into, the property also offers excellent potential to extend into the side return (STPP). Upon entering, you'll find a spacious reception room to your right, with direct access to the garden via the side of the house. To the rear, a generous kitchen and dining area provides the perfect space for family life and entertaining, with doors opening out to the garden.

FEATURES

- Four Bedrooms
- Two Bathrooms/Downstairs WC
- West Ealing Station (Elizabeth Line)
- Drayton Green Station Nearby
- Drayton Manor School Catchment/ St John's Primary School Catchment
- EPC Rating E



4 BEDROOM HOUSE

Lynton Avenue, W13

Upstairs, there are three comfortable bedrooms and a stylish family bathroom.

The top floor is home to the fourth bedroom, complete with its own en-suite shower room. Ideally situated just 10 minutes from West Ealing Station and moments from Drayton Green Station, this property also sits within the sought-after catchment areas of Drayton Manor High School and St John's Primary School. EPC Rating E.

