

WOODHOUSE

PROPERTY CONSULTANTS



Robinia Road, Broxbourne, Hertfordshire. EN10 6GE

Stunning Family Home ** Beautifully presented ** 4 Bedrooms set over 3 floors ** Master Bedroom with En-suite ** West-facing Lounge & Garden ** Garage half-converted into useful Utility Room ** Downstairs Cloakroom ** End-Terrace Townhouse ** Double Driveway ** Plenty of amenities & transport links at hand



£515,000 Freehold

PROPERTY DESCRIPTION

Woodhouse are pleased to offer this beautifully presented family home in this sought-after neighbourhood close to plenty of amenities. The current homeowners have tended to this home throughout the years and they are now ready to find their onward home.

This End-terrace home is set over 3 floors. To the Ground Floor you will find the Kitchen-Diner, Cloakroom and Utility Room. The Utility Room used to be part of the Garage, but has been cleverly converted into both a storage room (accessed via external garage door) and this Utility Room that hosts white goods, cupboards and sink.

To the first floor you have the Lounge, 2 x Bedrooms and the Family Bathroom. The Lounge has two Juliette balconies and overlooks the West-facing Garden, so plenty of natural daylight incoming.

To the top floor there are two spacious Bedrooms with the Master having its own Ensuite. Externally to the rear there is the low-maintenance West-facing Garden with patio area, and to the front there is a Double Driveway. Being End-terrace there is also a side gate to access the Garden from the front.

Robinia Road is ideally situated, being between the shops & eateries of Broxbourne, Cheshunt & Brookfield Centre. For road links, the A10 is a couple of minutes drive away with the M25 only several minutes further. Broxbourne & Cheshunt Stations are a short drive away, with the latter taking you straight into Liverpool St as quick as 20 minutes. For greenery you have several parks and as well as the huge Lea Valley Nature Reserve nearby for walks and bike ride

Viewings are highly recommended, contact Woodhouse today to come and see for yourself what this welcoming home has to offer you and your family! Viewings available 7 days a week.

FEATURES

- Stunning Family Home
- Beautifully presented
- 4 Bedrooms set over 3 floors
- Master Bedroom with En-suite
- West-facing Lounge & Garden
- Garage half-converted into useful Utility Room
- Downstairs Cloakroom
- End-Terrace Townhouse
- Double Driveway
- Plenty of amenities & transport links at hand



ROOM DESCRIPTIONS



FLOORPLAN

WOODHOUSE
PROPERTY CONSULTANTS

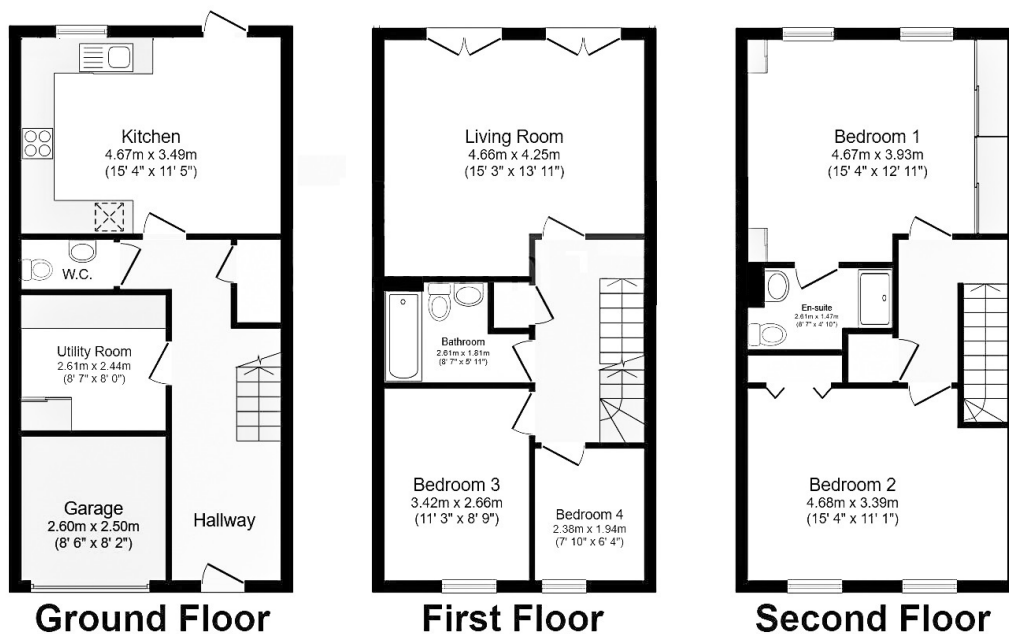

Total floor area 165.2 sq.m. (1,778 sq.ft.) approx

This floorplan is for illustrative purposes only and is not drawn to scale. Measurements, floor-areas, openings and orientations are approximate. They should not be relied upon for any purpose and do not form any part of an agreement. No liability is taken for any error or mis-statement. All parties must rely on their own inspections.