

£275,000  
Freehold



**THOMAS CONNOLLY**  
ESTATE AGENTS | LETTING AGENTS | NEW HOMES | PROPERTY MANAGEMENT



## Summary of Property

Thomas Connolly Estate Agents are delighted to present this Five bedroom, terraced HMO property for sale situated in Neatherfiled, Milton Keynes, which offers close proximity to the CMK shopping centre, Xscape and Milton Keynes Central Train Station with excellent links to London Euston with journey time approximately 30 mins.

The accommodation in brief comprises; ground floor - entrance hall, kitchen and bedroom with a shower room. The first floor offers a further two bedrooms, a shower room, The second floor offers a further two bedrooms and a family bathroom. This property also benefits from a rear garden and parking to the front. This property can be converted back in to a four bedroom terraced property.

The up to date achievable rental valuations are as follows:

Bedroom Five - £500pcm

Bedroom Four - £500pcm

# Room Descriptions

## Entrance Hall

### BEDROOM ONE

11' 7" x 11' 7" (3.53m x 3.53m)

EN-SUITE

### KITCHEN

11' 3" x 12' 2" (3.43m x 3.71m)

## FIRST FLOOR

### BEDROOM TWO

12' 8" x 14' 4" (3.86m x 4.37m)

### BEDROOM FOUR

7' 9" x 12' 2" (2.36m x 3.71m)

### SHOWER ROOM

## SECOND FLOOR

### BEDROOM THREE

14' 4" x 12' 8" (4.37m x 3.86m)

### BEDROOM FIVE

7' 9" x 12' 2" (2.36m x 3.71m)

### BATHROOM

### REAR GARDEN

### PLEASE NOTE

These property particulars do not constitute part or all of an offer or contract. All measurements are stated for guidance purposes only and may be incorrect. Details of any contents mentioned are supplied for guidance only and must also be considered as potentially incorrect. Thomas Connolly Estate Agents advise prospective buyers to recheck all measurements prior to committing to any expense. We confirm we have not tested any apparatus, equipment, fixtures, fittings or services and it is within the prospective buyers interests to check the working condition of any appliances prior to exchange of contracts. Thomas Connolly Estate Agents has not sought to verify the legal title of the property and the buyers must obtain verification from their solicitor

# THOMAS CONNOLLY

ESTATE AGENTS | LETTING AGENTS | NEW HOMES | PROPERTY MANAGEMENT

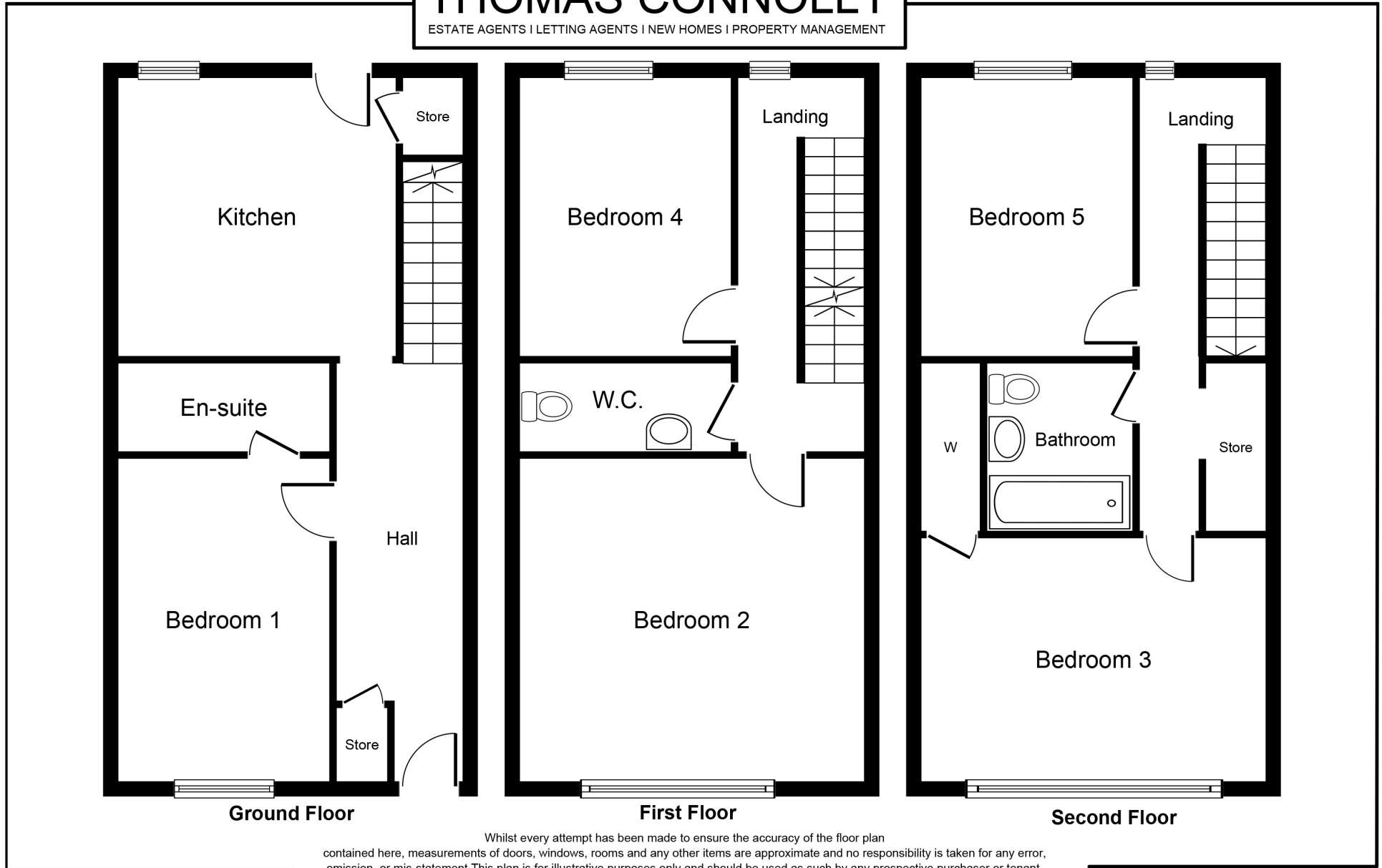

Whilst every attempt has been made to ensure the accuracy of the floor plan contained here, measurements of doors, windows, rooms and any other items are approximate and no responsibility is taken for any error, omission, or mis-statement. This plan is for illustrative purposes only and should be used as such by any prospective purchaser or tenant. The services, systems and appliances shown have not been tested and no guarantee as to their operability or efficiency can be given.

Copyright V360 Ltd 2023 | [www.houseviz.com](http://www.houseviz.com)