



FOR SALE



Monks Park, Wembley, Greater London HA9

CHAIN FREE - Welcome to your dream home on Monks Park, a desirable location offering modern living with a touch of elegance. The three bedroom semi-detached house is perfect for those seeking their ideal home.

Located in a sought-after area, this property offers easy access to local amenities, schools, and transport links.

Contact us now to book a viewing and make this house your new home sweet home.

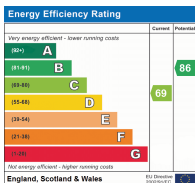

Offers in Excess of £500,000 Freehold

4 North Parade, Mollison Way, Edgware, HA8 5QH
E: info@mischaandco.com T: 0208 951 5000

Floorplan

GROUND FLOOR
476 sq.ft. (44.2 sq.m.) approx.

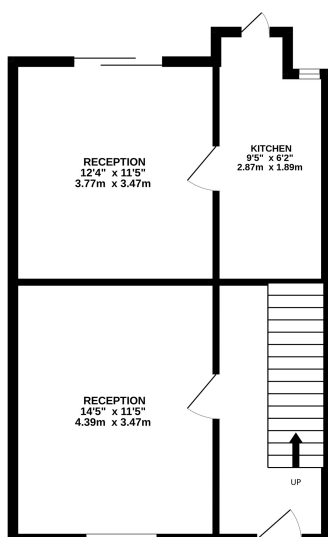

1ST FLOOR
470 sq.ft. (43.7 sq.m.) approx.

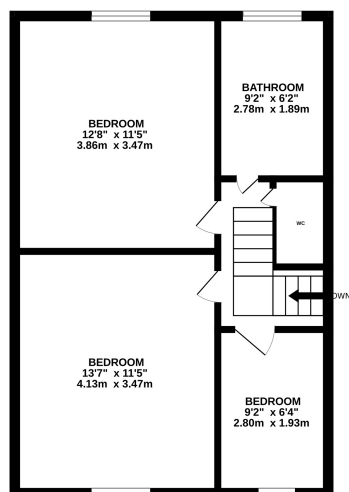

TOTAL FLOOR AREA : 946 sq.ft. (87.9 sq.m.) approx.

Whilst every attempt has been made to ensure the accuracy of the floorplan contained here, measurements of doors, windows, rooms and any other items are approximate and no responsibility is taken for any error, omission or mis-statement. The plan is for illustrative purposes only and should be used as such by any prospective purchaser. The services, systems and appliances shown have not been tested and no guarantee as to their operability or efficiency can be given.
Made with Metropix ©2025

NB: Please note that all fittings, kitchen appliances and heating systems have not been tested by Mishca & Co Sales & Lettings. Whilst we endeavour to make our sales details accurate and reliable. Room sizes should not be relied upon for carpets and furnishings. If there is any point, which is of particular important to you, please contact our office and we will be pleased to verify any information for you. Do so particularly if contemplating travelling some distance to view this property.