



- Well Presented & Maintained Throughout
- Mid Terrace House
- Ideal First Time Purchase
- Three Bedrooms
- Front Aspect Living Room With Bay Window
- Newly Fitted Shower Room & Ground Floor Cloakroom
- Kitchen/Diner
- Garage En Bloc

## Godwin Close, Halstead, Essex. CO9 1XA.

Nestled in a quiet residential area of Halstead, this well maintained, mid-terraced home on Godwin Close presents an excellent opportunity for first-time buyers or those looking to take the next step on the property ladder.



# Property Details.

## Room Measurements

### Entrance Hall

### Living Room



4.45m x 3.57m (14' 7" x 11' 9")

### Kitchen/Diner



2.77m x 4.63m (9' 1" x 15' 2")

### WC



### Landing

### Bedroom One



3.33m x 3.61m (10' 11" x 11' 10")

# Property Details.

## Bedroom Two



3.89m x 2.66m (12' 9" x 8' 9")

## Shower Room



2.35m x 1.99m (7' 9" x 6' 6")

## Bedroom Three



2.92m x 2.74m (9' 7" x 9' 0")

## Outside



Outside, the property boasts a private rear garden, ideal for relaxing or outdoor dining, along with a garage en bloc with parking directly in front. Additional on-street parking is also available.

# Property Details.

## Floorplans

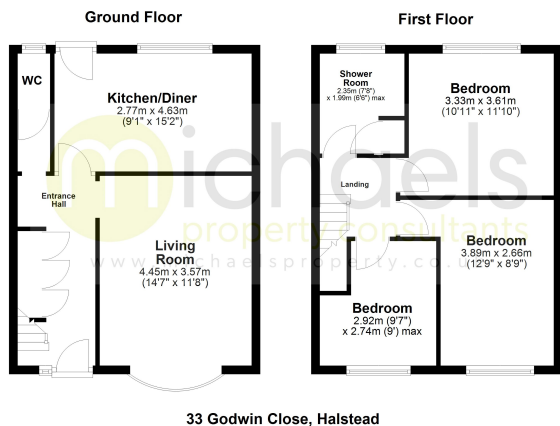

## Location

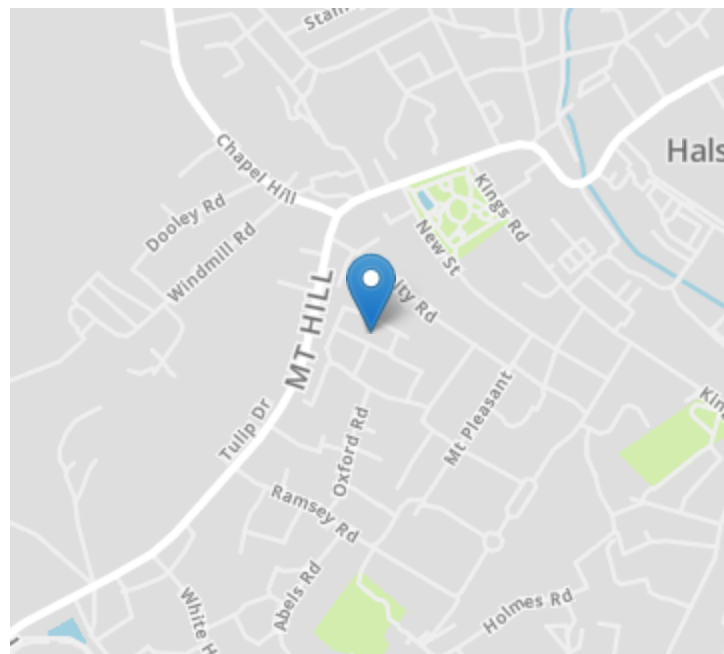

## Energy Ratings

We have not carried out a structural survey and the services, appliances and specific fittings have not been tested. All photographs, measurements, floor plans and distances referred to are given as a guide only and should not be relied upon for the purchase of carpets or any other fixtures or fittings. Gardens, roof terraces, balconies and communal gardens as well as tenure and lease details cannot have their accuracy guaranteed for intending purchasers. Lease details, service ground rent (where applicable) are given as a guide only and should be checked and confirmed by your solicitor prior to exchange of contracts.