

Truuli



Auckland Hill, London, SE27

£275,000 Leasehold

- Chain free
- Victorian conversion
- In need of cosmetic updating
- One double bedroom
- High ceilings and good natural lighting throughout
- Close proximity to West Norwood train station & High street

2, Lansdowne Road, Croydon, London, CR9 2ER

Tel: 0330 043 0002

Email: save@truuli.co.uk Web: www.truuli.co.uk

Auckland Hill, London, SE27

£275,000 Leasehold

Located on the ground floor of this imposing Victorian building is a fantastic opportunity to acquire this one double-bedroom period conversion flat.

Offering a vast amount of potential to add value, this period conversion flat is priced to sell and is chain-free allowing for a quick transaction.

In need of modernisation, this property is ideally located for quick access to West Norwood train station and the high street.

Ground Floor
473 sq.ft. (43.9 sq.m.) approx.

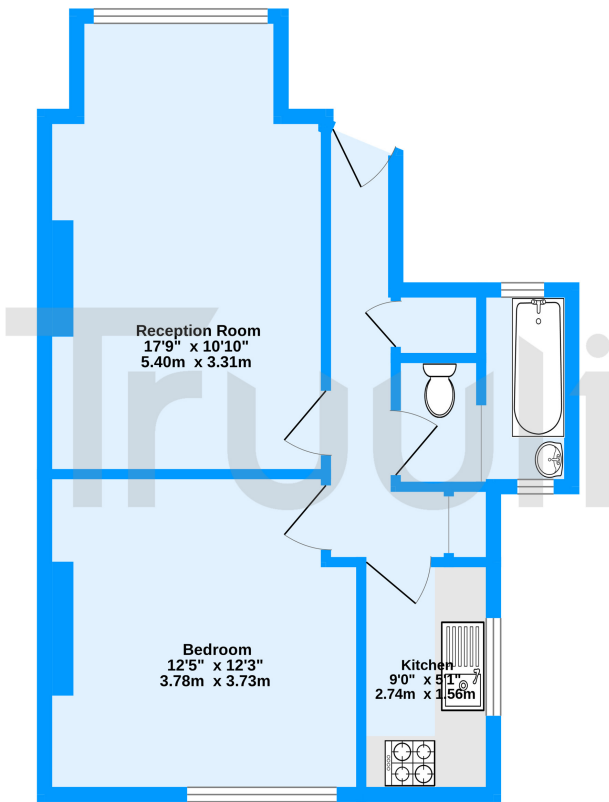

Auckland Hill, West Norwood, SE27

Energy Efficiency Rating		Current	Potential
Very energy efficient - lower running costs			
(92-100)	A		
(81-91)	B		
(69-80)	C		79
(55-68)	D	62	
(39-54)	E		
(21-38)	F		
(1-20)	G		
Not energy efficient - higher running costs			
England, Scotland & Wales		EU Directive 2002/91/EC	

