



13 Clifton Road, Henlow, Bedfordshire, SG16 6BL

£400,000

Large three-bedroom end of terrace cottage situated on a good-sized plot with garage/off road parking. Originally two cottages but now converted to provide a spacious family home with two good sized reception rooms, kitchen/breakfast room, utility + shower room and three double bedrooms and a dressing room + bathroom upstairs. Outside is a large mature rear garden with outbuildings and off-road parking is provided by a garage with electric up and over door. NO CHAIN



13 Clifton Road Henlow

Approximate Gross Internal Area
1475 sq ft - 137 sq m

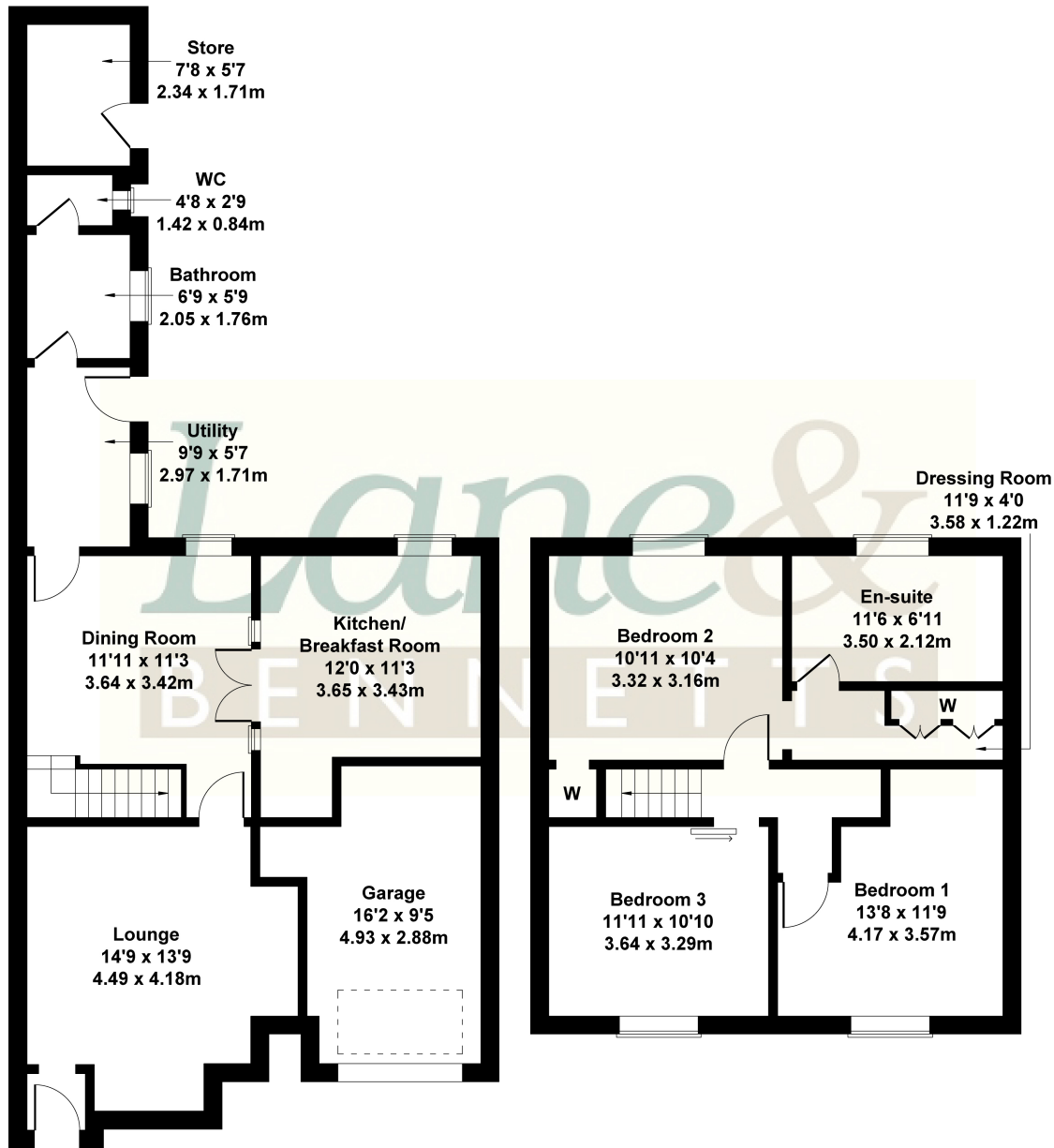

GROUND FLOOR

FIRST FLOOR

Not to Scale. Produced by The Plan Portal 2025
For Illustrative Purposes Only.

- NO CHAIN
- THREE BEDROOM END OF TERRACE
- ORIGINALLY TWO COTTAGES
- LOUNGE + DINING ROOM
- KITCHEN/BREAKFAST ROOM + UTILITY
- THREE DOUBLE BEDROOMS + DRESSING ROOM
- BRICK BUILT OUTBUILDINGS
- GOOD SIZED PLOT
- GARAGE WITH ELECTRIC DOOR
- EASY ACCESS TO RAILWAY STATION + A1 MOTORWAY

