





- Substantial Semi-Detached Family Home
- Detached Garage & Annex
- Four Reception Rooms
- Six Double Bedrooms
- Two Bathrooms
- Cellar Rooms
- Large Mature Gardens
- Ample off Road Parking

Description

This presents an exceptional opportunity to acquire one of Northwich's most iconic properties, situated amidst similar-styled and sized properties on one of the town's feeder roads. The property occupies a substantial plot spanning nearly half an acre, featuring mature gardens. Notably, it also includes a large detached garage with a self-contained apartment, providing versatility for housing a dependent relative or generating a regular income through rental. The main house boasts an impressive footprint of 3,800 square feet, accommodating three floors of living space. Additionally, it features a basement with three cellar rooms. Throughout the property, a high standard of presentation is maintained, complemented by modern fixtures and fittings. The property comprises four reception rooms, a grand hallway, a kitchen-dining room, a utility room, and six double bedrooms. Two high-end bathrooms and three WC's are also included. A spacious driveway and turning area provide ample parking for multiple vehicles.



Location

Local amenities are well catered for with the shops on Chester Road, Castle which offer everything you could want or need. Two railway stations serve the area with the West Coast Main Line service running through Hartford, enabling access to London within two hours. Trains to Manchester and Chester run from Greenbank station. The A556 and A49 easily facilitate access to the region’s major road network with Manchester and Liverpool airports both within 20 miles. Above all, where the area really excels is its range of excellent schools. The well regarded Grange private school is less than a mile away and both Hartford High and St Nicholas Catholic High School are within walking distance as are the four village primary schools; Hartford Primary School, St Wilfrid's Catholic Primary School, Hartford Manor Community School and the private Grange primary School. Nearby Northwich caters for a more comprehensive range of amenities, including leading supermarkets with Waitrose, Sainsbury's and Tesco all represented.

Tenure

FREEHOLD

EPC Rating:



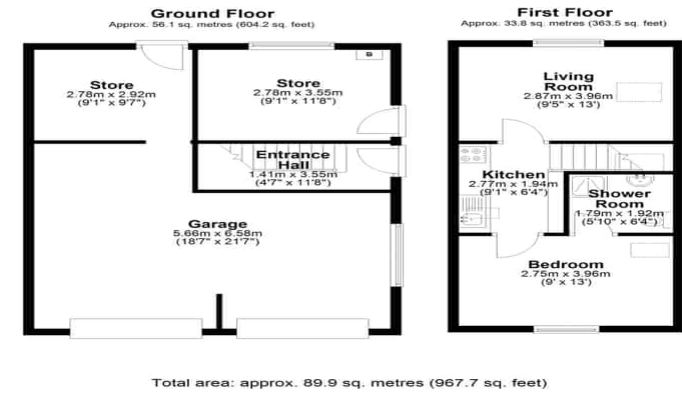

Williams Estates is the trading name of Williams Estates (Ltd). Registered address 33, The Green, Hartford, Northwich, Cheshire, CW8 1QA.
Reg number 07682683. Director Andrew P Williams