

*An exceptional newly renovated 3 bedroomed detached bungalow on an extensive Village plot.
Velindre, near Llandysul/Newcastle Emlyn, West Wales*



Arwel, Velindre, Llandysul, Carmarthenshire. SA44 5YF.

£449,950

REF: R/4845/LD

- *** No onward chain *** An exclusive newly renovated detached bungalow *** 3 bedroomed accommodation *** High end modern kitchen and bathroom suites *** Orangery - 18' x 12' *** Extensive plot in a Village Centre location
- *** Detached garage with electric roller shutter door *** Newly tarmacadamed driveway with ample parking *** Additional caravan/mobile home parking area *** Large landscaped gardens to the front and rear *** Sandstone patio - Sun trap
- *** Highly sought after residential property suiting a range of Buyers - Be it Family or for retirement living *** Ready to move into - Superbly decorated and presented *** A modern home in a popular rural location *** 4 miles equidistant from Llandysul and Newcastle Emlyn *** A 25 minute drive from the Cardigan Bay Coast and 15 miles from the County Town of Carmarthen *** Viewings highly recommended



LAMPETER
12, Harford Square, Lampeter,
Ceredigion, SA48 7DT
Tel:01570 423623
lampeter@morgananddavies.co.uk



ABERAERON
4, Market Street, Aberaeron,
Ceredigion, SA46 0AS
Tel:01545 571 600
aberaeron@morgananddavies.co.uk



CARMARTHEN
11, Lammas St, Carmarthen,
Carmarthenshire, SA31 3AD
Tel:01267 493444
carmarthen@morgananddavies.co.uk

LOCATION

An attractive and convenient location within the Village Community of Velindre which offers a good range of everyday amenities including Primary School, Village Shop/Post Office, Public House and Places of Worship, some 4 miles equidistant from the Teifi Valley Market Towns of Llandysul and Newcastle Emlyn offering a good range of facilities and 15 miles from the County Town and Administrative Centre of Carmarthen being the main employment centre for the locality offering National Rail and Motorway connections. The Market Town of Cardigan lies 14 miles away giving access to the breath taking Ceredigion Coastline.

GENERAL DESCRIPTION

A nicely renovated detached bungalow offering spacious 3 bedroomed accommodation. The property has undergone comprehensive work in recent years and now provides a stylish and modern Family home. It enjoys a upgraded kitchen and bathroom along with oil fired central heating and double glazing.

Externally the property sits within its own extensive plot within the popular Village Community of Velindre. The gardens have been landscaped with large lawned areas to the front and rear. It enjoys the benefit of a detached garage and additional parking for a caravan/mobile home storage, etc.



THE ACCOMMODATION

The accommodation at present offers more particularly the following.

RECEPTION HALL

Having access via a UPVC front entrance door with side glazed panel, laminate flooring, radiator.

LIVING ROOM

16' 9" x 10' 7" (5.11m x 3.23m). With pillared radiator, picture window to the front.



LIVING ROOM (SECOND IMAGE)



KITCHEN

17' 9" x 9' 9" (5.41m x 2.97m). A modern and stylish gloss kitchen with a range of wall and floor units with work surfaces over stainless steel sink and drainer unit with flexi tap, integrated fridge and freezer, Bosch oven and Neff electric hob with extractor hood over, porcelain tiled flooring.



KITCHEN (SECOND IMAGE)



ORANGERY

18' 0" x 12' 0" (5.49m x 3.66m). With an atrium styled roof, sliding patio doors to the rear sandstone patio, laminate flooring.



ORANGERY (SECOND IMAGE)



INNER HALLWAY

Being newly carpeted.

BOILER ROOM

Housing the oil fired central heating boiler and electric meters.

BATHROOM

A stylish fully tiled 3 piece suite comprising of a P-shaped panelled bath with double headed shower, cabinet style double door vanity unit with a ceramic wash hand basin with mixer tap, low level flush w.c., radiator, spot lighting, extractor fan.



BATHROOM (SECOND IMAGE)



REAR BEDROOM 2

10' 9" x 9' 1" (3.28m x 2.77m). With pillared radiator, picture window with views over the rear garden.



FRONT BEDROOM 1

13' 0" x 10' 7" (3.96m x 3.23m). With pillared radiator, picture window to the front.



FRONT BEDROOM 3

10' 6" x 9' 5" (3.20m x 2.87m). With picture window to the front, pillared radiator.



EXTERNALLY

GARAGE

24' 2" x 16' 3" (7.37m x 4.95m). Of block construction under a steel roof with electric roller shutter door, side service door, plumbing for w.c., electricity connected.



GARDEN

A particular feature of this property is its extensive plot. The grounds have been landscaped to now offer a private lawned area to the rear and a lawned area to the front. It offers a blank canvas and is a great entertainment space.

FRONT GARDEN



FRONT GARDEN (SECOND IMAGE)



REAR GARDEN



REAR GARDEN (SECOND IMAGE)



REAR GARDEN (THIRD IMAGE)



PATIO AREA

To the rear of the property lies a newly laid sandstone patio area being private and providing a fantastic suntrap. There also lies a gravelled and slab pathway that surrounds the property for ease of access.



PATIO AREA (SECOND IMAGE)**PARKING AND DRIVEWAY**

A newly tarmacadamed driveway with ample parking and turning space with additional parking next to the garage for a motorhome or overflow parking area.

**ADDITIONAL PARKING AREA****FRONT OF PROPERTY****REAR OF PROPERTY****REAR OF PROPERTY (SECOND IMAGE)****AGENT'S COMMENTS**

A must view property. A fantastic example of a renovated residence deserving early viewing.

NIGHT SHOT 1



NIGHT SHOT 2



NIGHT SHOT 3



TENURE AND POSSESSION

We are informed the property is of Freehold Tenure and will be vacant on completion. No onward chain.

COUNCIL TAX

The property is listed under the Local Authority of

Carmarthenshire County Council. Council Tax Band for the property - 'E'.

MONEY LAUNDERING REGULATIONS

The successful Purchaser will be required to produce adequate identification to prove their identity within the terms of the Money Laundering Regulations. Appropriate examples include Passport/Photo Driving Licence and a recent Utility Bill. Proof of funds will also be required or mortgage in principle papers if a mortgage is required.

Services

We are informed by the current Vendors that the property benefits from mains water, mains electricity, mains drainage, oil fired central heating, double glazing, telephone subject to B.T. transfer regulations, Broadband subject to confirmation by your Provider.

HM Land Registry

Official copy of title plan

Title number **CYM184254**
Ordnance Survey map reference **SN3438NE**
Scale **1:1250 enlarged from 1:2500**
Administrative area **Carmarthenshire / Sir
Gaerfyrddin**

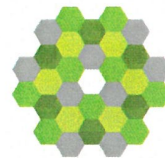

© Crown Copyright. Produced by HM Land Registry.
Reproduction in whole or in part is prohibited without the prior written permission of Ordnance Survey. Licence Number AC0000851063.

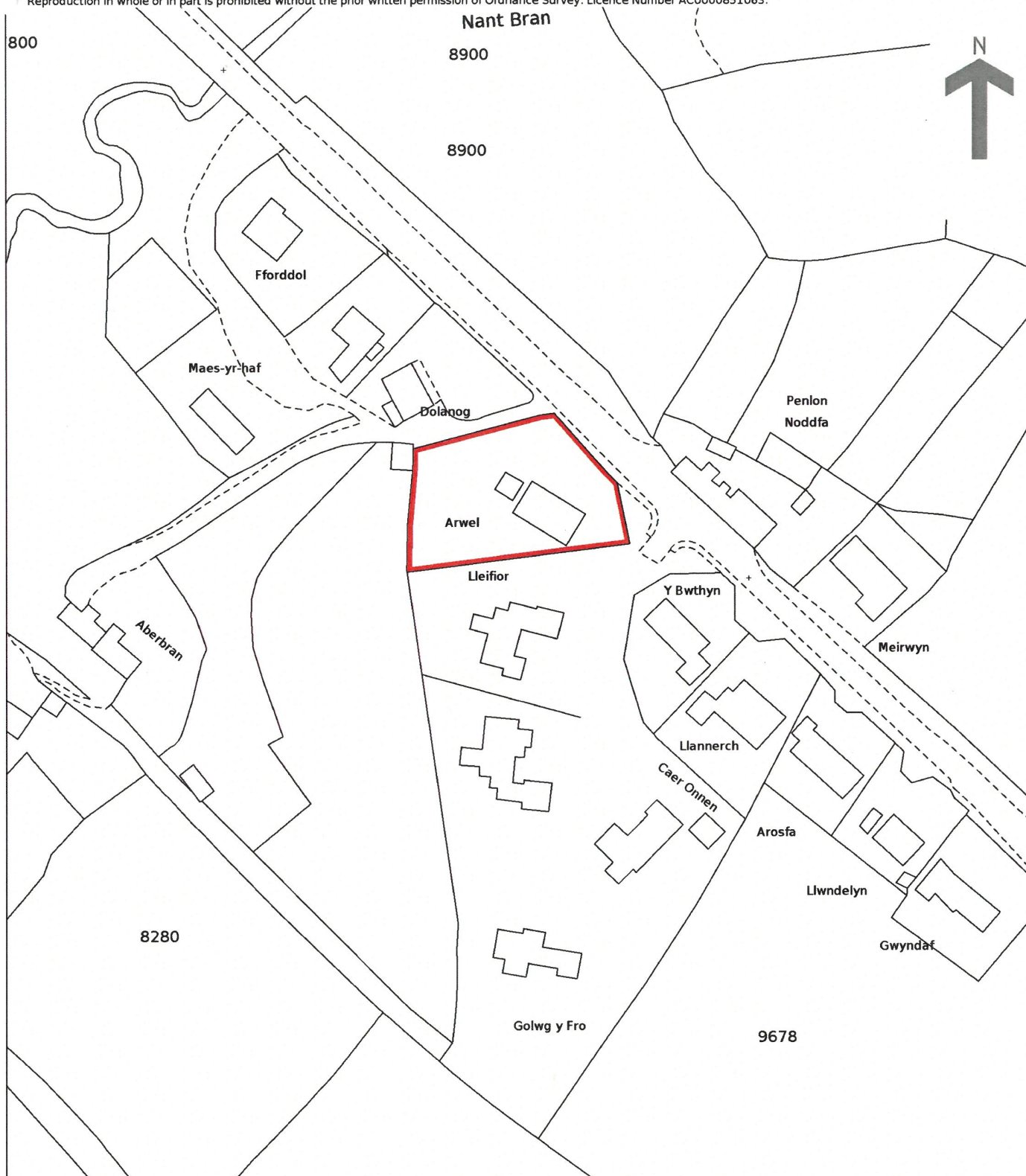

Council Tax: Band E

N/A

Parking Types: Driveway. Garage. Private.

Heating Sources: Double Glazing. Oil.

Electricity Supply: Mains Supply.

Water Supply: Mains Supply.

Sewerage: Mains Supply.

Broadband Connection Types: FTTP.

Accessibility Types: None.

Has the property been flooded in last 5 years? No

Flooding Sources:

Any flood defences at the property? No

Any risk of coastal erosion? No

Is the property listed? No

Are there any restrictions associated with the property? No

Any easements, servitudes, or wayleaves?
No

The existence of any public or private right of way? No



Directions

From the A484 Carmarthen to Cardigan road at Pentrecagal turn on the bend heading towards Drefach Velindre/Waungilwen. Continue along this road for approximately 1 mile into Waungilwen. Arwel will be located on your right hand side, as identified by the Agents 'For Sale' board.

VIEWING: Strictly by prior appointment only. Please contact our Lampeter Office on 01570 423 623 or lampeter@morgananddavies.co.uk

All properties are available to view on our Website – www.morgananddavies.co.uk. Also on our FACEBOOK Page - www.facebook.com/morgananddavies. Please 'LIKE' our FACEBOOK Page for new listings, updates, property news and 'Chat to Us'.

To keep up to date please visit our Website, Facebook and Instagram Pages

For further information or to arrange a viewing on this property please contact :

Lampeter Office
12 Harford Square
Lampeter
Ceredigion
SA48 7DT

T: 01570 423623

E: lampeter@morgananddavies.co.uk

<http://www.morgananddavies.co.uk>



Regulated by

RICS[®]