



Day & Co  
ESTATE AGENTS

28 Cavendish Street

Keighley

BD21 3RG



10 Strong Close Way, Keighley,  
West Yorkshire, BD21 4JS

Offers Over £85,000

T: 01535 664609

W: [www.dayandcoestateagents.co.uk](http://www.dayandcoestateagents.co.uk)

E: [keighley@dayandcoestateagents.co.uk](mailto:keighley@dayandcoestateagents.co.uk)



- MID TERRACE HOUSE
  - REQUIRES MODERNISATION
  - GARDENS, NO ONWARD CHAIN
- TWO BEDROOMS
  - GAS CENTRAL HEATING & DOUBLE GLAZING
  - EPC RATING D

SUMMARY

\*\* MID TERRACE HOUSE, TWO BEDROOMS, REQUIRES MODERNISATION, GAS CENTRAL HEATING, DOUBLE GLAZING, GARDENS, NO ONWARD CHAIN, EPC RATING D \*\*

FULL DESCRIPTION

Day & Co are pleased to be marketing for sale this two bedroom mid terrace house which requires modernisation, situated off Dalton Lane, Keighley. This property is offered with no onward chain and has accommodation briefly comprising of an Entrance Hall, Lounge, Kitchen. First Floor - Two Bedrooms, Bathroom. Gas central heating and double glazing. Outside gardens to both the front and rear. EPC Rating D

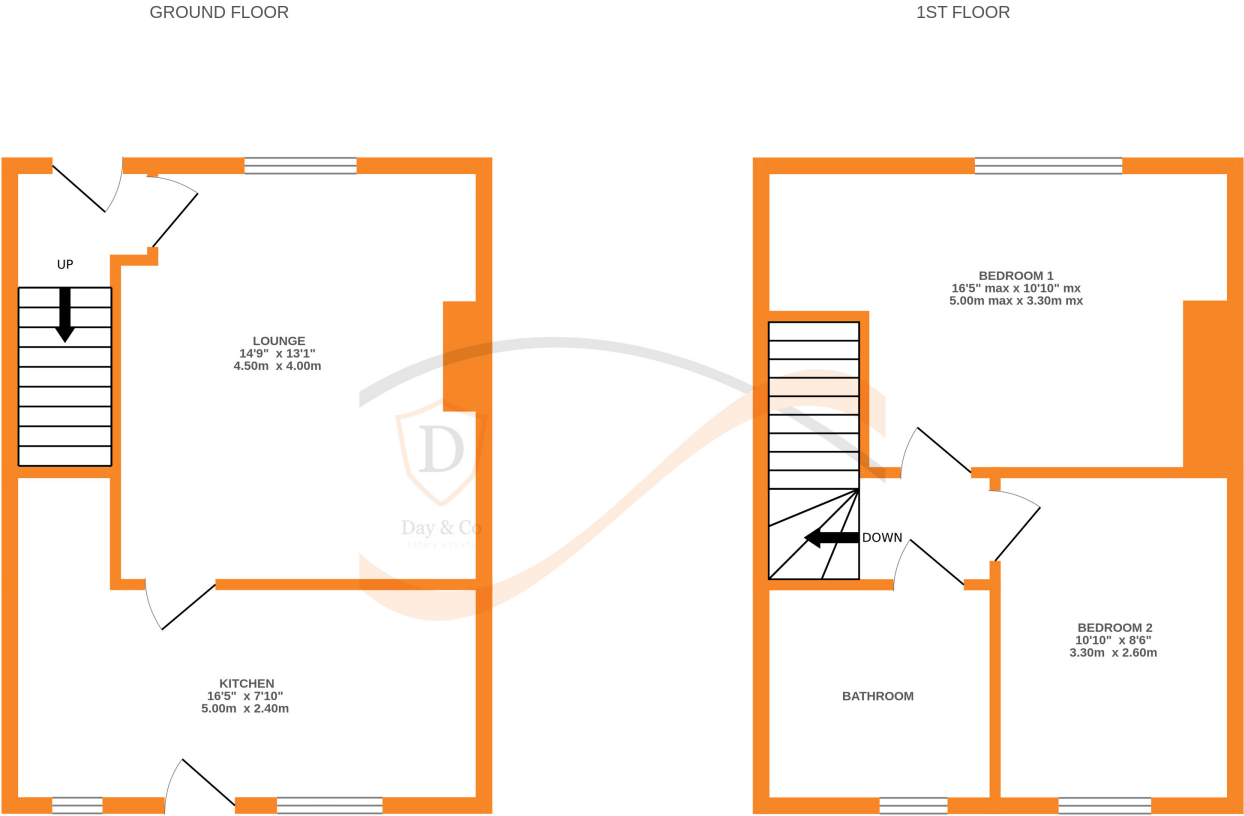

Whilst every attempt has been made to ensure the accuracy of the floorplan contained here, measurements of doors, windows, rooms and any other items are approximate and no responsibility is taken for any error, omission or mis-statement. This plan is for illustrative purposes only and should be used as such by any prospective purchaser. The services, systems and appliances shown have not been tested and no guarantee as to their operability or efficiency can be given.  
Made with Metropix ©2026