



42 Victoria Road, Hythe, Kent, CT21 6DR

EPC Rating = D

Guide Price £549,995







This stunning four bedroom Victorian home offers the perfect blend of period elegance and modern comfort, situated in one of Hythe's most desirable residential roads and just a short stroll from the beach and vibrant town centre. The property boasts generous living areas full of natural light and character. The ground floor features two inviting reception rooms ideal for relaxing or entertaining, along with a well-appointed kitchen that opens directly onto the garden. Upstairs, the home continues to impress with four beautifully proportioned bedrooms arranged over two floors. The top floor is dedicated to a stunning main bedroom with built-in storage, en suite shower room/WC and a stunning outlook towards the beach, while the first floor offers three additional bedrooms and a stylish family bathroom. Outside, the garden provides a peaceful retreat, complemented by a detached outbuilding perfect for use as a home office or studio. There is a raised decked area and access to a good size cellar. EPC Rating = D

**Guide Price £549,995**

**Tenure** Freehold

**Property Type** Detached House

**Receptions** 2

**Bedrooms** 4

**Bathrooms** 2

**Parking** On road parking

**Heating** Gas

**EPC Rating** D

**Council Tax** Band E

Folkestone And Hythe District Council





**Situation**

This property is situated in the popular 'Victoria Road' in Hythe a 'stones throw' from the beach. The town is a cinque port with a bustling centre which is brimming with bespoke shops, coffee shops, pubs and restaurants. There is a Waitrose and Sainsbury's within close proximity. The property is also conveniently close to the High Street, Royal military Canal. Folkestone lies to the East with High Speed Rail Link service to London, with a journey time to St Pancras of less than an hour, from Folkestone West Station approximately 5 miles. The M20 motorway network and the Channel Tunnel Terminal at Cheriton are within easy reach. There are great bus services to many wonderful destinations such as the Cathedral City of Canterbury approximately 18 miles away and the historic town of Rye approximately 22 miles away

**The accommodation comprises**

**Ground floor**

**Entrance hall**

**Living room**

16' 9" x 13' 5" (5.11m x 4.09m)

**Dining room**

13' 1" x 12' 5" (3.99m x 3.78m)

**Kitchen**

9' 2" x 7' 10" (2.79m x 2.39m)







## First floor

### Landing

### Bedroom two

18' 1" x 13' 5" (5.51m x 4.09m)

### Bedroom three

12' 2" x 11' 10" (3.71m x 3.61m)

### Bedroom four

9' 10" x 6' 10" (3.00m x 2.08m)

### Family shower/bathroom/WC

8' 7" x 6' 7" (2.62m x 2.01m)

## Second floor

### Bedroom one

25' 0" x 12' 3" (7.62m x 3.73m)

### En suite shower room/WC

## Outside

### Attractive front and rear garden

## Cellar

Area one: 12' 8" x 12' 3" (3.86m x 3.73m)

Area two: 26' 9" x 7' 10" (8.15m x 2.39m)

Area three: 15' 1" x 13' 3" (4.60m x 4.04m)

## Outbuilding

13' 11" x 6' 2" (4.24m x 1.88m)

## Outbuilding 2













Approximate Gross Internal Area (Excluding Cellar and Outbuilding = 146 sq m / 1572 sq ft  
 Cellar = 53 sq m / 570 sq ft  
 Outbuilding = 8 sq m / 85 sq ft

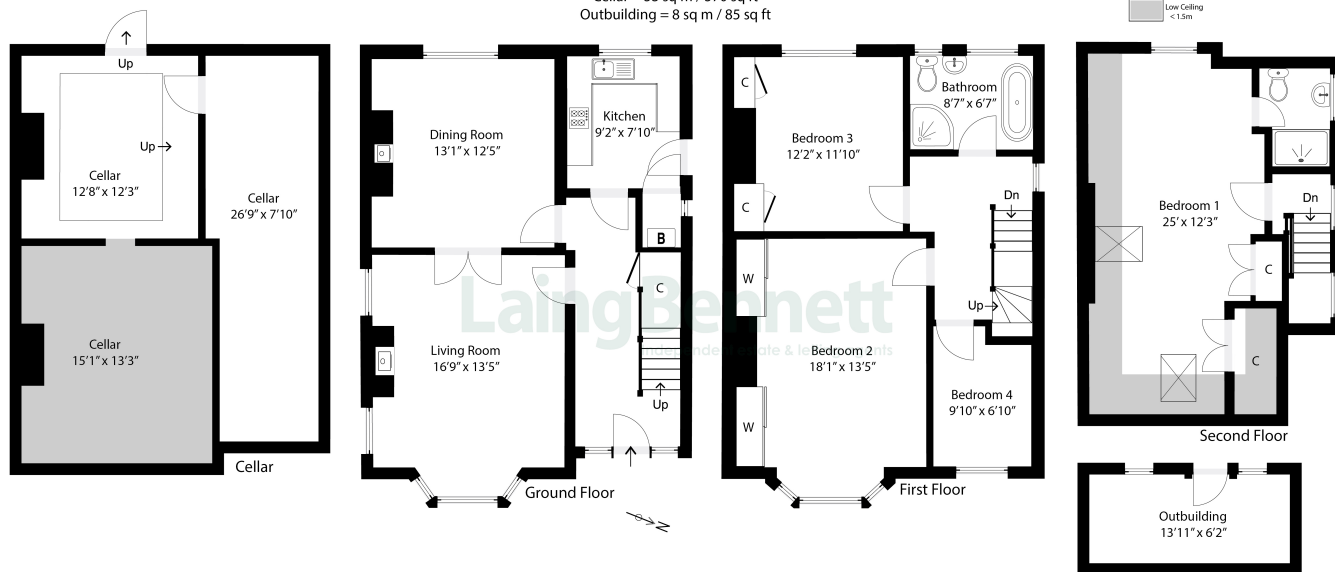
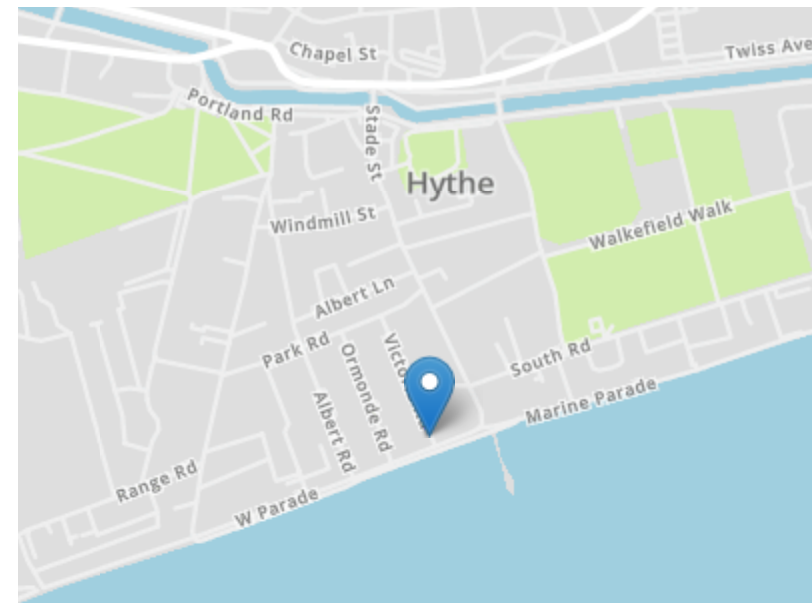

Illustration for identification purposes only. Measurements are approximate. Dimensions given are between the widest points.  
 Not to scale. Outbuildings are not shown in actual location.  
 © Unauthorised reproduction prohibited - chriskemp@hotmail.com



Need to book a viewing?

If you would like to book a viewing please contact our office on 01303 863393 or email [sales@laingbennett.co.uk](mailto:sales@laingbennett.co.uk)

See all our properties at



[www.laingbennett.co.uk](http://www.laingbennett.co.uk)

The Estate Office  
 8 Station Road  
 Lyminge  
 Folkestone  
 Kent  
 CT18 8HP

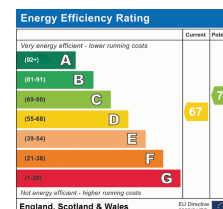

These property details are intended to give a fair description and give guidance to prospective Purchaser/Tenant. They do not constitute an offer or contract of Sale/Tenancy and all measurements are approximate. While every care has been taken in the preparation of these details neither Laing Bennett Ltd nor the Vendor/ Landlord accept any liability for any statement contained herein. Laing Bennett Ltd has not tested any services, appliances, equipment or facilities, and nothing in these details should be deemed to be a statement that they are in good working order or that the property is in good structural condition or otherwise. We advise all applicants to commission the appropriate investigations before Exchange of Contracts/entering into a Tenancy Agreement. It should not be assumed that any contents/furnishing, furniture etc. photographed are included in the Sale/Tenancy, nor that the property remains as displayed in the photographs. No person in the employment of Laing Bennett Ltd has authority to make or give any representation or warranty whatever in relation to this property.